

2016

MTB DRIVETRAIN

Frame Fit Specifications



Table of Contents

2x11/2x10/3x10 Front Derailleurs	5
2x11/2x10/3x10 Front Derailleur Overview.....	6
Front Derailleur - Boost 148 Compatibility	7
Low Clamp Mount - XX/X0/GX/X9/X7/X5	8 - 10
High Clamp Mount - XX/X0/GX/X9/X7/X5	11 - 13
Low Direct Mount - XX/X0/GX/X9/X7/X5.....	14 - 17
High Direct Mount - XX/X0/GX/X9/X7/X5.....	18 - 21
Mid Direct Mount - XX/X0/GX/X9/X7/X5.....	22
Rear Derailleurs.....	23
All Models - Rear Derailleur Frame Hanger.....	24
1x11 - XX1/X01/X1/GX - Boost 148 Compatible	25
1x10 & 1x7 - X01 DH.....	26
2x11, 2x10 & 3x10 - XX/X0/GX/X9/X7/X5 - Boost 148 Compatible	27
Chainstay Clearance.....	28
1x11 & 2x11 Chainstay Clearance	29
1x11 & 1x7 Cranksets.....	30
Crank Boot.....	31
XX1	32
XX1 - Boost 148 Compatible	33
XX1 - Fat bike	34
X01	35
X01 - Boost 148 Compatible	36
X01 DH.....	37
GX-1400/X1-1400	38
GX-1400/X1-1400 - Boost 148 Compatible	39
GX-1400 - Fat bike.....	40
X1-1200/X1-1000	41
GX-1000.....	42
GX-1000 - Boost 148 Compatible	43
GX-1000/X1-1000 - Fat bike.....	44
2x11 Cranksets	45
GX-1400.....	46
GX-1400 - Boost 148 Compatible.....	47
GX-1400 - Fat bike.....	48
GX-1000.....	49
GX-1000 - Boost 148 Compatible	50
2x10 Cranksets	51
XX.....	52
X0	53
X9	54
X9 - Fat bike	55
GX-1200/X7	56
GX-1000/X5	57
GX-1000 - Boost 148 Compatible	58
GX-1000/X5 - Fat bike	59

3x10 Cranksets 60
 X0 61
 X9 62
 X7 63
 X5 64

Bottom Brackets 65
 PressFit 30™ 66
 PressFit 30™ continued..... 67
 PressFit™ 89.5 & 92 GXP® 68
 PressFit™ 104.5 & 107 GXP® 69

Wheels 70
 ROAM 30 & 40 Hub Boost 148 Compatible..... 71
 Maxle™ Boost 148 Compatible 72

General Notes

All dimensions are in millimeters unless otherwise noted.

Images in this document are not to scale.

Your product's appearance may vary slightly from the images in this document.

Information in this document is subject to change without prior notice.

If you have any questions please contact your SRAM representative.

Front Derailleurs

Leave adequate clearance between bottle cage mounts and front derailleur clamp.

Be sure to consider the full travel range for suspension frames.

α = Chainstay angle (angle between seat tube and chainstay).

SRAM does **not** create a unique front derailleur for Boost 148 standard frames.

To achieve front derailleur compatibility for Boost 148 Standard frames, frame manufacturers must modify the low direct mount ([p. 16](#)) or high direct mount ([p. 21](#)) front derailleur mounting plane 3 mm outboard for proper alignment with a 52 mm chainline.

Rear Derailleurs

All SRAM 1x11 and 2x11 rear derailleurs are compatible with SRAM designed 12x148 systems.

2x11/2x10/3x10

Front Derailleurs

2x11/2x10/3x10 Front Derailleur Overview

DP = Dual pull link
TP = Top pull only link
BP = Bottom pull only link

			Low Clamp Mount			Low Direct Mount		High Clamp Mount			High Direct Mount		Mid Direct Mount
			Ø 31.8	Ø 34.9	Ø 38.2	S1	S3	Ø 31.8	Ø 34.9	Ø 38.2	155-160	155	
XX	Gearing	Chainring	TP BP	TP BP	TP BP	-	-	TP BP	TP BP	TP BP	-	TP BP	-
	2x10	42/28 39/26 38/24 36/22	-	-	-	-	-	-	-	-	-	-	-
X0	2x10	42/28 39/26 38/24 36/22 34/22	TP BP	TP BP	TP BP - TP BP	TP BP - TP BP	TP BP	TP BP	TP BP	TP BP - TP BP	TP BP - TP BP	- TP BP -	-
	3x10	44/33/22											
	2x11	36/24	TP BP	TP BP									
GX	2x10	38/24 36/22 34/22	DP	DP	-	-	TP BP	TP BP	TP BP	-	-	TP BP	TP BP
	2x10	42/28 39/26 38/24 36/22	TP BP	TP BP	-	TP BP	TP BP	TP BP	TP BP	TP BP	TP BP	-	-
X9	3x10	44/33/22	TP BP	TP BP		TP BP	TP BP	TP BP	TP BP	TP BP	TP BP		
	2x10	42/28 39/26 38/24 36/22	DP	DP	-	DP	DP	TP BP	TP BP	-	TP BP	-	-
X7	2x10	42/28 39/26 38/24 36/22 34/22	DP	DP	-	DP	DP	TP BP	TP BP	-	TP BP	-	-
	3x10	44/33/22				DP		TP BP	TP BP				
	2x10	42/28 39/26 38/24 36/22 34/22	DP	DP	-	DP	DP	TP BP	TP BP	-	TP BP	-	TP BP
	3x10	44/33/22				DP		TP BP	TP BP				-
X5	2x10	42/28 39/26 38/24 36/22 34/22	DP	DP	-	-	DP	TP BP	TP BP	-	-	TP BP	-
	3x10	44/33/22	DP	DP		-		TP BP	TP BP		TP BP	-	
	2x10	42/28 39/26 38/24 36/22 34/22	DP	DP	-	-	DP	TP BP	TP BP	-	TP BP	-	-
	3x10	44/33/22				-		TP BP	TP BP		TP BP	-	

Front Derailleur - Boost 148 Compatibility

Frame Compatibility for Boost 148 Standard Frames

To achieve front derailleur compatibility for Boost 148 Standard frames, frame manufacturers must modify the low direct mount ([p. 16](#)) or high direct mount ([p. 21](#)) front derailleur mounting plane 3 mm outboard for proper alignment with a 52 mm chainline.

Low Clamp Mount - XX/X0/GX/X9/X7/X5

Frame Compatibility and Capacity Information						
	Clamp diameter (mm)	Rear capacity	Index	Cable routing	Chainstay angle (α)	Chainline (mm)
2x11	31.8 (w/adapter) 34.9	11 speed	Yes	Top Bottom	66° - 69°	49.0 (36/24)
2x10	31.8 (w/adapter) 31.8 (XX - w/o adapter) 34.9 38.2	10 speed	Yes	Top Bottom Dual	66° - 69°	49.0 (34/22, 36/22, 38/24) 49.5 (39/26, 42/28)
3x10	31.8 (w/adapter) 34.9 38.2	10 speed	Yes	Top Bottom Dual	66° - 69°	51 (44/33/22)

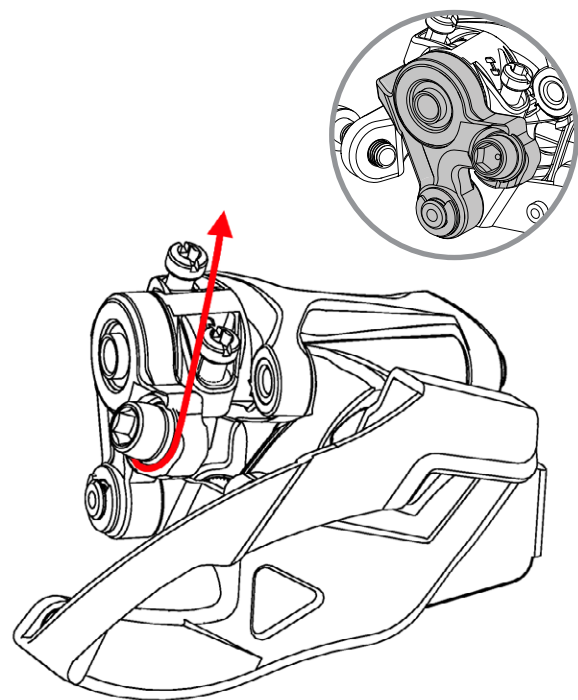

Top Pull

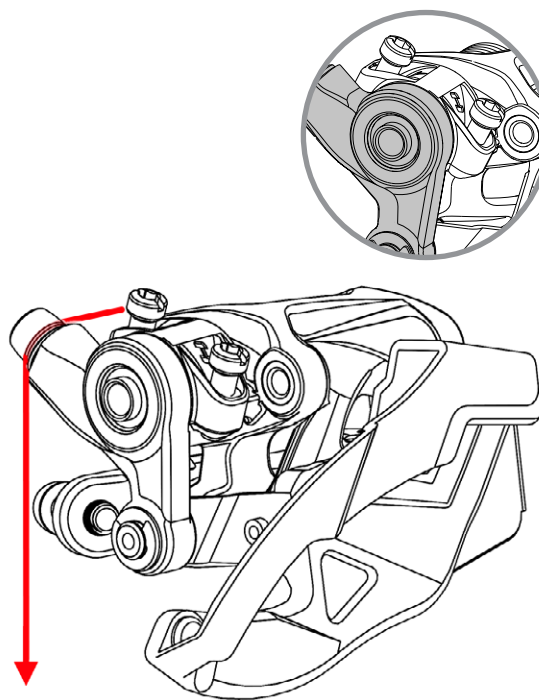

Bottom Pull

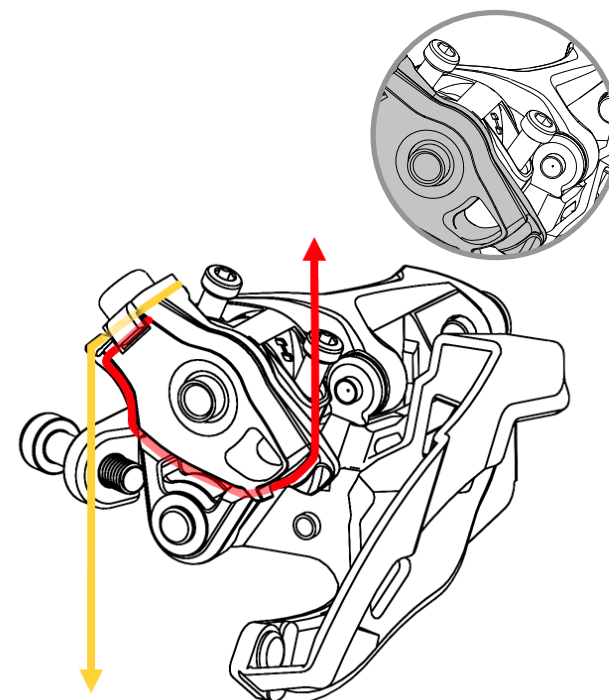

Dual Pull

Low Clamp Mount - XX/X0/GX/X9/X7/X5

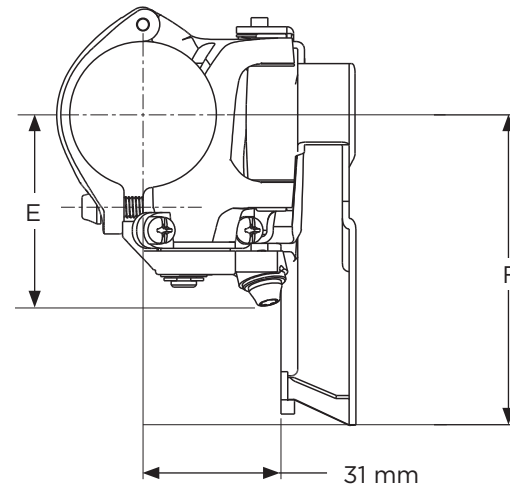
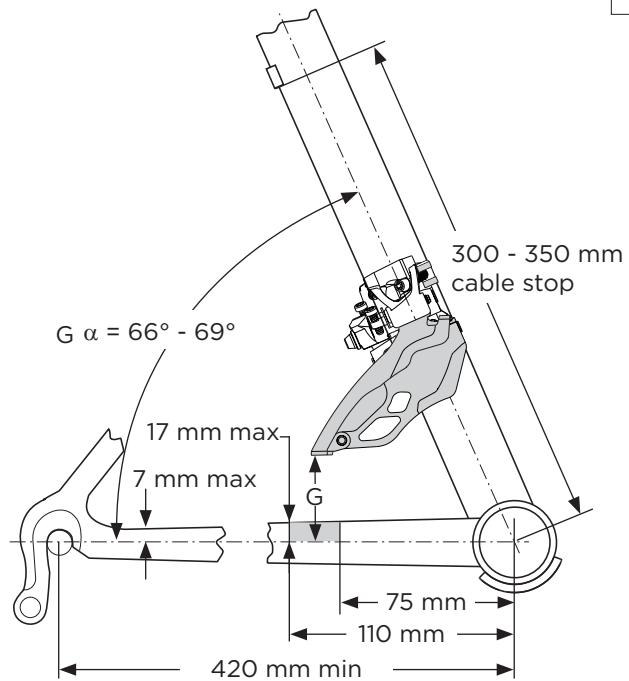
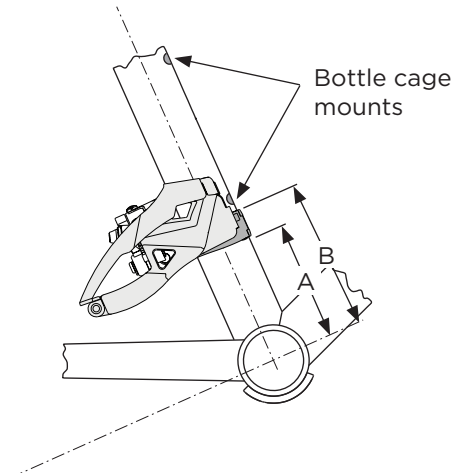
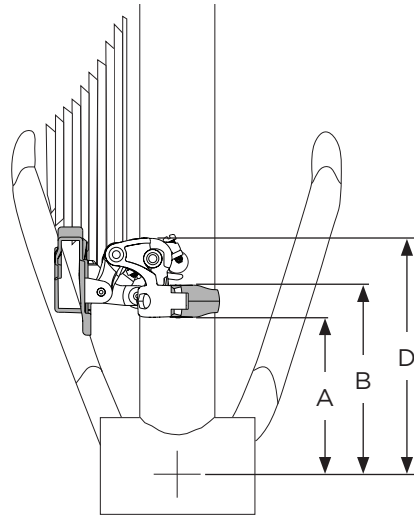

Low Clamp Mount - XX/X0/GX/X9/X7/X5

Clamp/Body Position*										
		Chainring	Cable routing	A (mm)	B (mm)	D (mm)	E (mm)	F (mm)	G (mm)	
									α = 66°	α = 69
2x11	36/24	Top and Bottom	62	82	107	48/42	70	23	28	
	34/22	Top and Bottom	62	82	107	48/42	65	22	26	
Dual		44								
2x10	36/22	Top and Bottom	58	78	103	48	70	18	21	
		Dual				46				
	38/24	Top and Bottom	62	82	107	48	70	22	26	
		Dual				46				
	39/26	Top and Bottom	56 61 (XX)	76	101	48	74	16	21	
		Dual				46				
	42/28	Top and Bottom	62 67 (XX)	82	107	48	74	22	27	
		Dual				46				
	3x10	44/33/22	Top and Bottom	65	85	110	48	89	17	22
			Dual				46			

* Be sure to leave adequate clearance between bottle cage mounts and front derailleur clamp.

High Clamp Mount - XX/X0/GX/X9/X7/X5

Frame Compatibility and Capacity Information						
	Clamp diameter (mm)	Rear capacity	Index	Cable routing	Chainstay angle (α)	Chainline (mm)
2x11	31.8 (w/adaptor) Body clamp 34.9 Body clamp	11 speed	Yes	Top Bottom	66° - 69°	49.0 (36/24)
2x10	31.8 Band clamp 31.8 (w/adaptor) Body clamp 34.9 Band clamp 34.9 Body clamp 38.2 Band clamp	10 speed	Yes	Top Bottom	66° - 69°	49.0 (34/22, 36/22, 38/24) 49.5 (39/26, 42/28)
3x10	31.8 Band clamp 31.8 (w/adaptor) Body clamp 34.9 Band clamp 34.9 Body clamp 38.2 Band clamp	10 speed	Yes	Top Bottom	66° - 69°	51 (44/33/22)

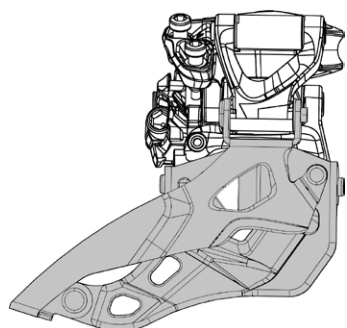

36/24 2x11 cage

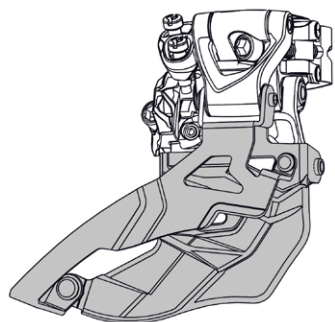

34/22 2x10 cage

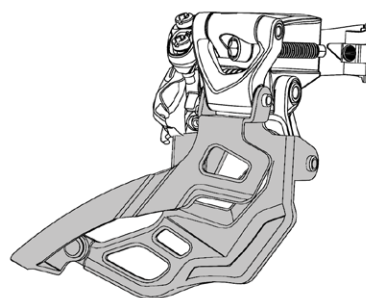

36/22 and 38/24 2x10 cage

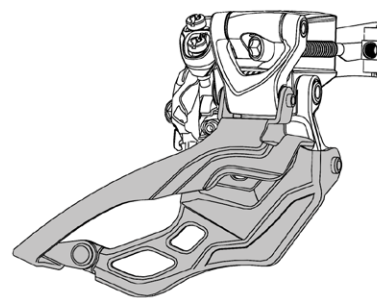

39/26 and 42/28 2x10 cage

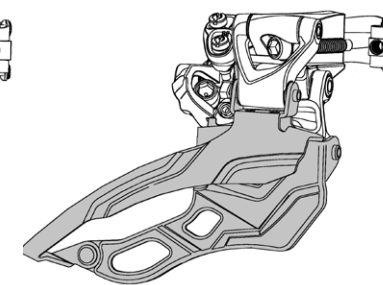

44/33/22 3x10 cage

High Clamp Mount - XX/X0/GX/X9/X7/X5

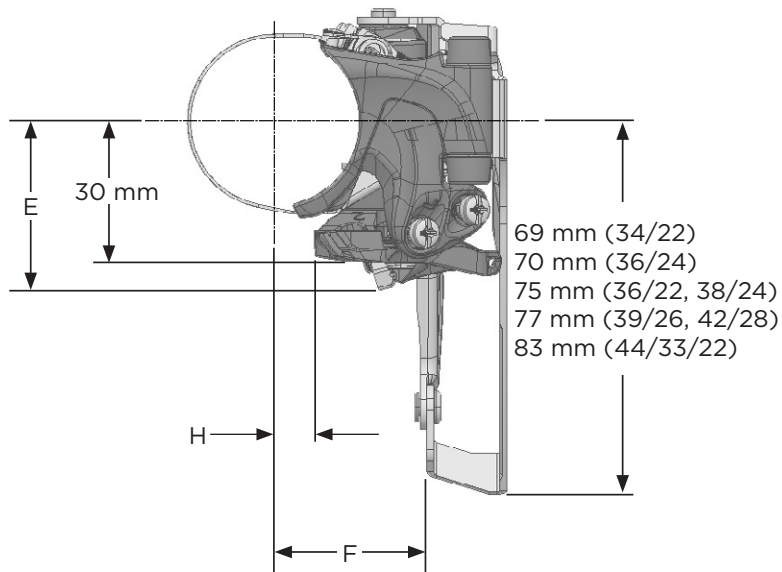
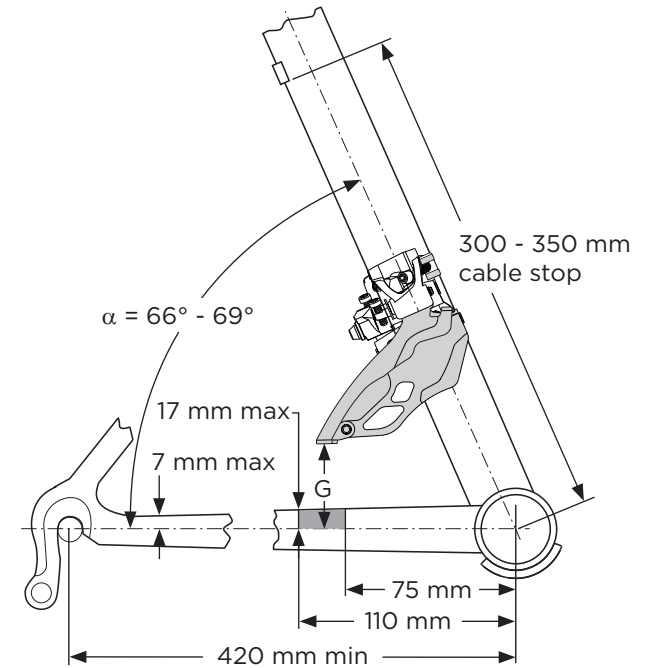
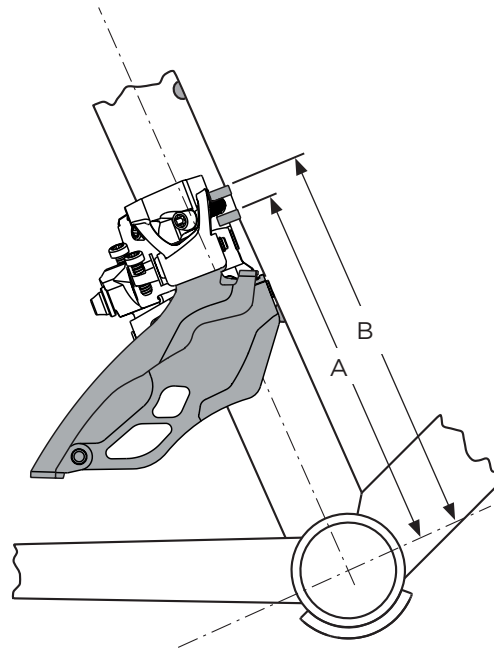
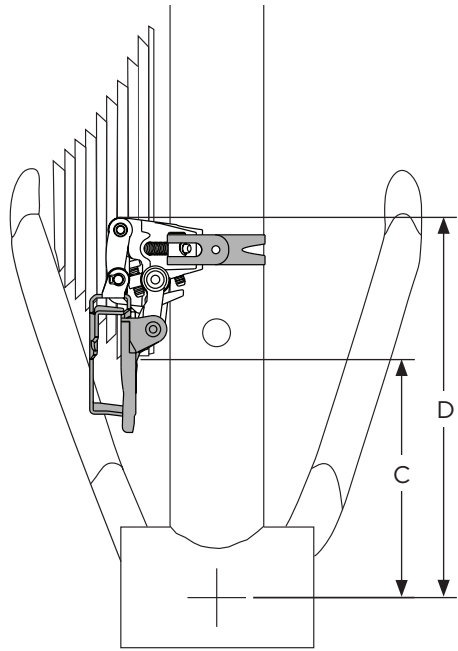

High Clamp Mount - XX/X0/GX/X9/X7/X5

Clamp/Body Position												
	Chainring	Cable routing	Clamp version	A (mm)	B (mm)	C (mm)	D (mm)	E (mm)	F (mm)	G (mm)		H (mm)
										$\alpha = 66^\circ$	$\alpha = 69^\circ$	
2x11	36/24	Top Bottom	Body	119	137	84	139	34	35	24	28	12 Top
												0 Bottom
2x10	34/22	Top Bottom	Band	118	142	88	143	34	38	22	27	12 Top
			Body	123								8 Bottom
	36/22	Top Bottom	Band	114	137	84	139	34	33	18	23	12 Top
			Body	119								7 Bottom
	38/24	Top Bottom	Band	118	141	88	143	34	33	22	27	12 Top
			Body	123								7 Bottom
	39/26	Top Bottom	Band	112 114 (XX)	135 129 (XX)	82	137	34	33	22	27	12 Top
			Body	117								7 Bottom
	42/28	Top Bottom	Band	118 120 (XX)	141 (135 XX)	88	143	34	33	28	33	12 Top
			Body	123								7 Bottom
3x10	44/33/22	Top Bottom	Band	129	148	98	151	36	31	24	29	13 Top
			Body	132								5 Bottom

Low Direct Mount - XX/X0/GX/X9/X7/X5

Frame Compatibility and Capacity Information				
Rear capacity	Index	Cable routing	Chainstay angle (α)	Chainline (mm)
11 speed	Yes	Top Bottom	66° - 69°	49.0 (36/24)
10 speed	Yes	Top Bottom Dual	66° - 69°	49.0 (34/22, 36/22, 38/24) 49.5 (39/26, 42/28) 51 (44/33/22)

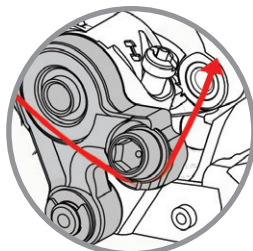

Top pull

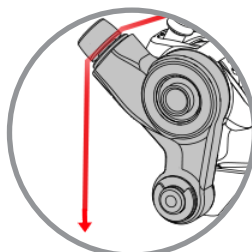

Bottom pull

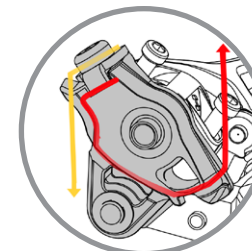

Dual pull

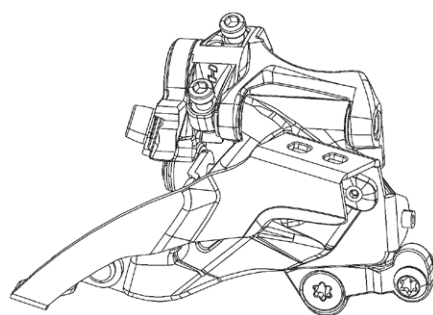

S3 - Standard
2x11 49.0 mm (36/24) Top Pull

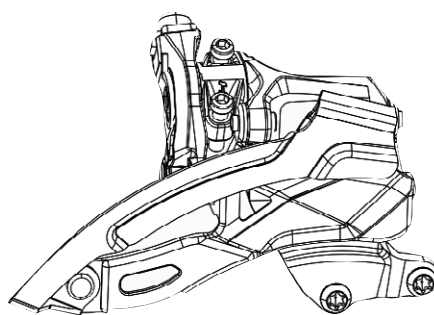

S3 - Standard
3x10 51 mm (44/33/22) Dual pull

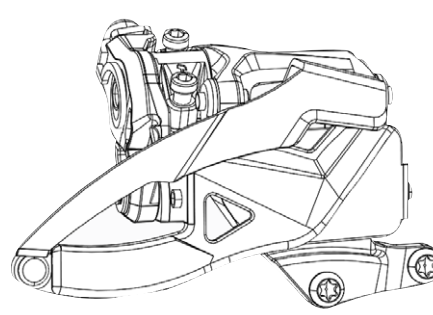

S3 - Standard
2x10 49.0 mm (34/22, 36/22, 38/24)
2x10 49.5 mm (39/26, 42/28) Dual pull

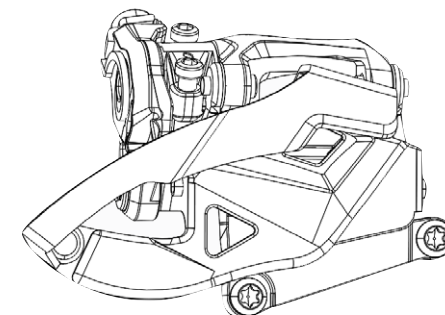

S1 - Standard
2x10 49.5 mm (39/26, 42/28)

Low Direct Mount - XX/X0/GX/X9/X7/X5

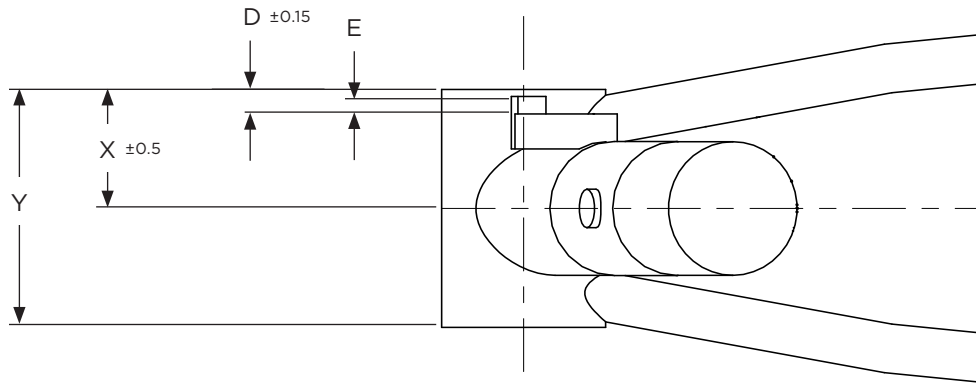

Low Direct Mount Type : S1

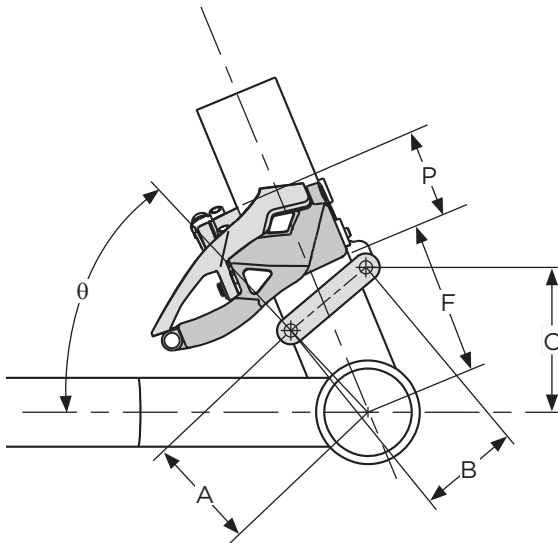

Low Direct Mount Type : S2 + S3

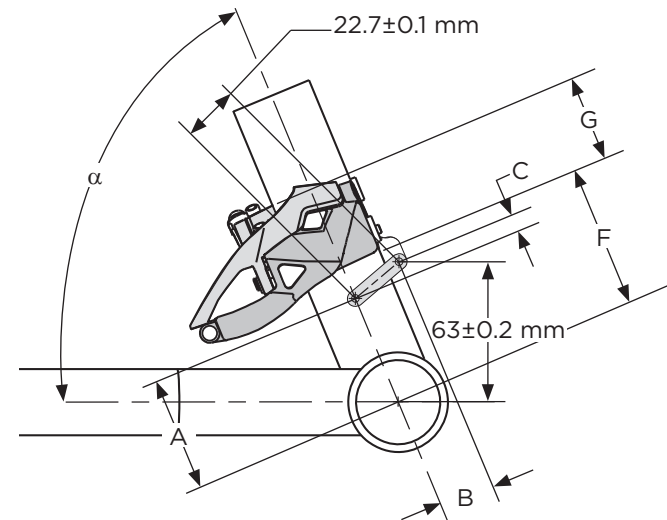

Low Direct Mount - XX/X0/GX/X9/X7/X5

Mounting Hole Position - Swing Arm Fully Extended									
Type	A (mm)	B (mm)	C (mm)	D (mm)		E (mm)	F (mm)	G (mm)	α/θ
				68 mm	73 mm				
S1	48.9 \pm 0.15	42.7 \pm 0.1	63 \pm 0.2	14.8	17.3	-	65	48 45 (XX)	$\theta = 45.5^{\circ} \pm 1^{\circ}$
S2	54 \pm 0.15	22.1 \pm 0.05	5 \pm 0.05						See S3 Mount below
S3									

S3 Mount				
Bottom bracket type	X (mm)	Y (mm)	D (mm)	
	Frame centerline - BB shell (DS)	BB shell width	Standard	Boost*
English/BSA 68 mm	34.0	68	7.0	4.0
English/BSA 73 mm	36.5	73	9.5	6.5
English/BSA 100 mm (fat bike)	50.0	100	5.5	-
PressFit 30™ 73 mm	36.5	73	9.5	6.5
PressFit™ 89.5 GXP®	44.75	89.5	17.75	14.75
PressFit™ 92 GXP®	47.25	92	20.25	17.25
PressFit™ 121 GXP® (fat bike)	60.5	121	16.0	-

* Frame manufacturers must modify the front derailleur mounting plane 3 mm outboard to get proper alignment with a 52 mm chainline.

Low Direct Mount - XX/X0/GX/X9/X7/X5

Cable Routing - Bottom Pull - Swing arm fully extended									
	Chainring	H (mm)	I (mm)	G (mm)		K (mm)	Thread pitch	Tire clearance	
				$\alpha = 66^\circ$	$\alpha = 69^\circ$		L	M (mm)	N (mm)
2x11	36/24	13 8 (XX)	34 33 (XX)	23	28	92	M5x0.8-6H	42	33
2x10	34/22			22	26	104		42 40 (XX)	33
	36/22			18	21	88			
	38/24			22	26	92			
	39/26			16	21	94			
	42/28			22	27	100			
3x10	44/33/22			17	22	104		45	29

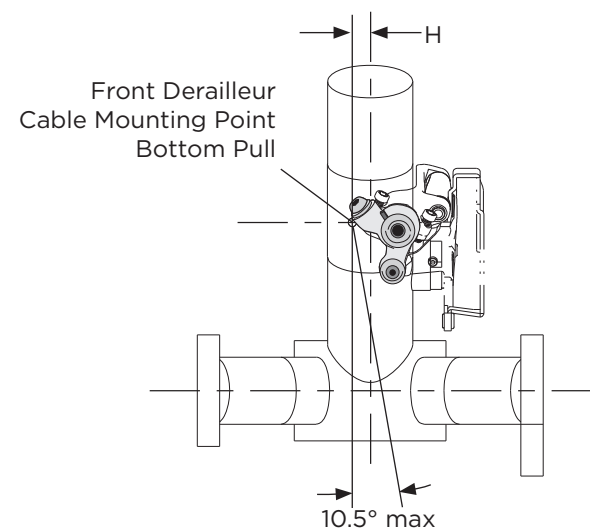
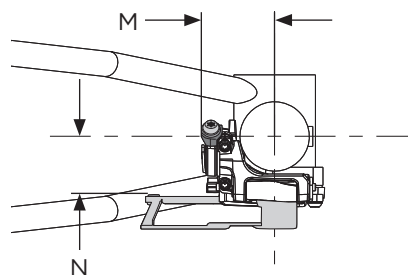
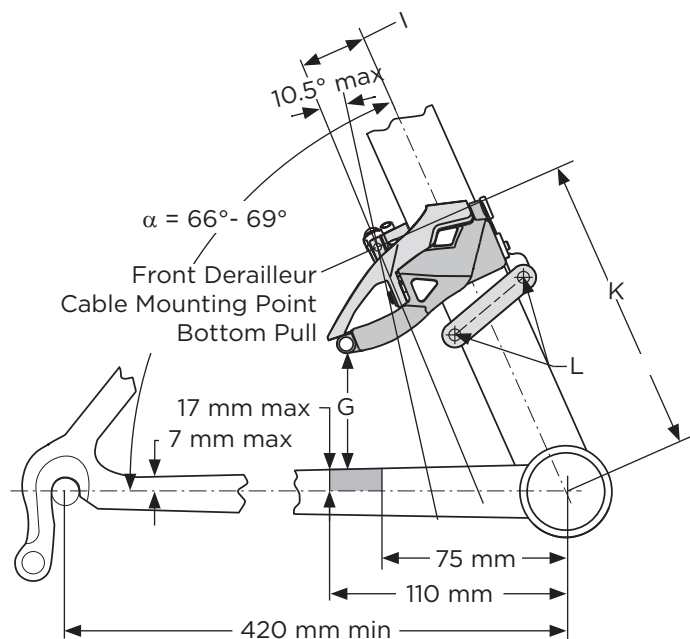

2x11/2x10/3x10 Front Derailleurs

High Direct Mount - XX/X0/GX/X9/X7/X5

Frame Compatibility and Capacity Information					
	Rear capacity	Index	Cable routing	Chainstay angle (α)	Chainline (mm)
Classic Body	10 speed	Yes	Top Bottom	66° - 69°	49 (36/22, 38/24) 49.5 (39/26, 42/28) 51 (44/33/22)
	10 speed	Yes	Top Bottom	66° - 69°	49 (34/22, 36/22, 38/24) 49.5 (39/26, 42/28)
Compact Body	11 speed	Yes	Top Bottom	66° - 69°	49 (36/24)

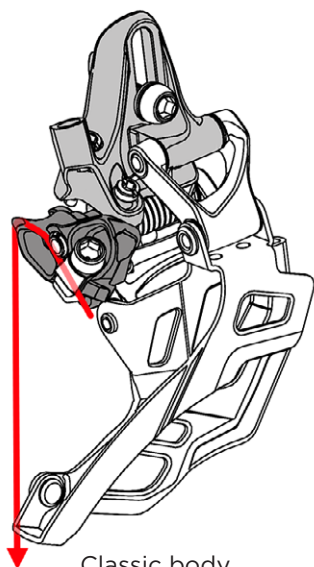

Classic body
Bottom pull

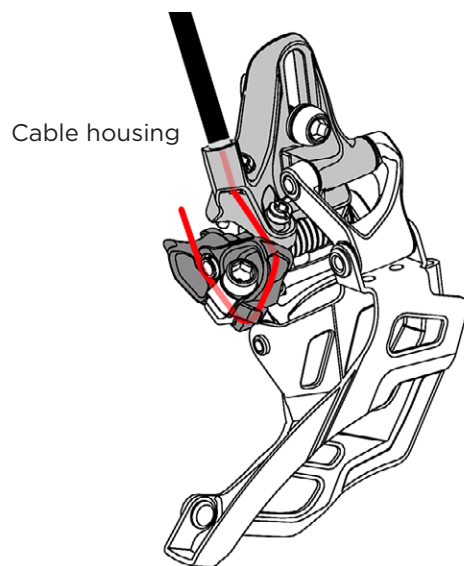

Classic body
Top pull

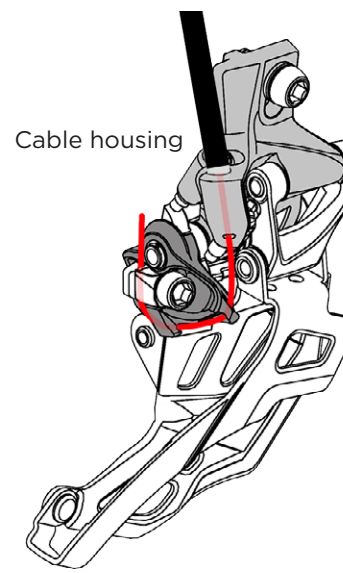

Compact body
Top pull

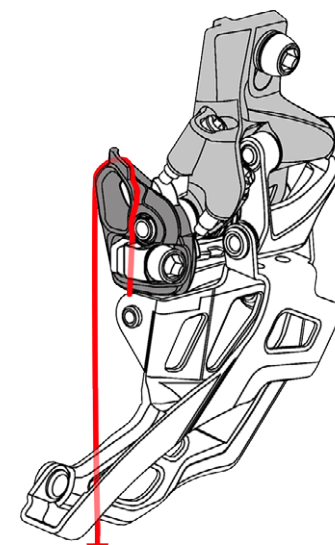

Compact body
Bottom pull

High Direct Mount - XX/X0/GX/X9/X7/X5

High Direct Mount Frame Build Requirements for Standard, Boost 148 and Fat Bikes

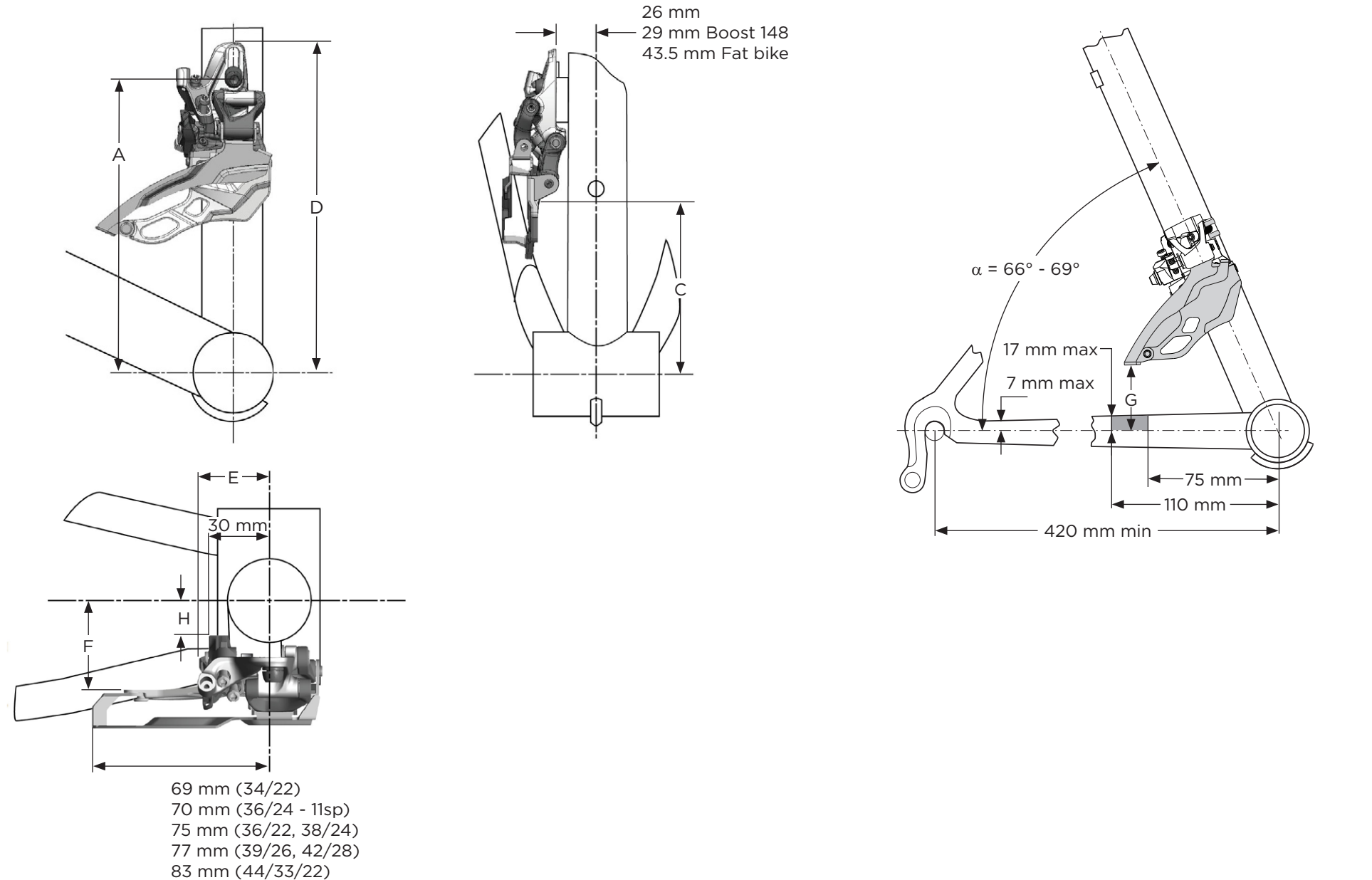

High Direct Mount - XX/X0/GX/X9/X7/X5

Mount Dimensions											
	Chainring	Cable routing by body style		A (mm)	C (mm)	D (mm)	E (mm)	F (mm)	G (mm)		H (mm)
		Compact	Classic						$\alpha = 66^\circ$	$\alpha = 69^\circ$	
2x11	36/24	Top	-	155 Compact	84	164 Compact	34	35	24	28	14
		Bottom									7
2x10	34/22	Top	-	155 Compact	88	163 Compact	34	38 55.5 (fat bike)	22	27	12 29.5 (fat bike)
		Bottom									8 25.5 (fat bike)
	36/22	Top	Top	155 Compact 155 - 160 Classic	84	164 Compact 168 Classic	34	33 50.5 (fat bike)	18	23	14 31.5 (fat bike)
		Bottom	Bottom								7 24.5 (fat bike)
	38/24	Top	Top	155 Compact 155 - 160 Classic	88	169 Compact 173 Classic	34	33 50.5 (fat bike)	22	27	14 31.5 (fat bike)
		Bottom	-								7 24.5 (fat bike)
	39/26	Top	Top	155 Compact 155 - 160 Classic	82	163 Compact 167 Classic	34	33	22	27	14
		Bottom	-								7
	42/28	Top	Top	155 Compact 155 - 160 Classic	88	169 Compact 173 Classic	34	33	28	33	14
		Bottom	-								7
3x10	44/33/22	-	Top	155 - 160 Classic	98	180 Classic	36	31	24	29	14
		-	Bottom								6

High Direct Mount - XX/X0/GX/X9/X7/X5

High Direct Mount Frame Build Requirements for Standard, Boost 148 and Fat Bikes				
Bottom bracket	X (mm)	Y (mm)	Z (mm)	
	Frame centerline - BB shell (DS)	BB shell width	Standard	Boost*
English/BSA 68 mm	34.0	68	8.0	5.0
English/BSA 73 mm	36.5	73	10.1	7.5
English/BSA 100 mm (fat bike)	50.0	100	6.5	-
PressFit 30™ 73 mm	36.5	73	10.5	7.5
PressFit™ 89.5 GXP®	44.75	89.5	18.75	15.75
PressFit™ 92 GXP®	47.25	92	21.75	18.75
PressFit™ 121 GXP® (fat bike)	60.5	121	17.0	-

* Frame manufacturers must modify the front derailleur mounting plane 3 mm outboard to get proper alignment with a 52 mm chainline.

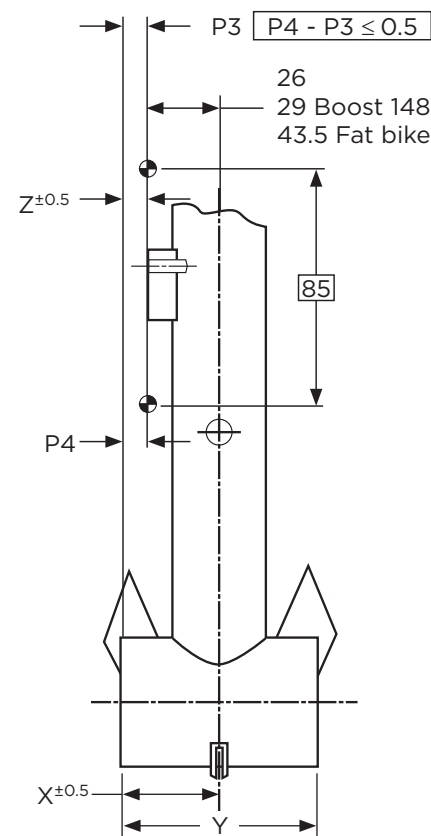
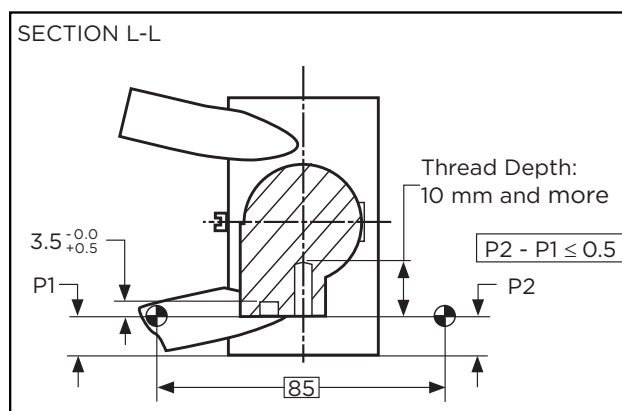
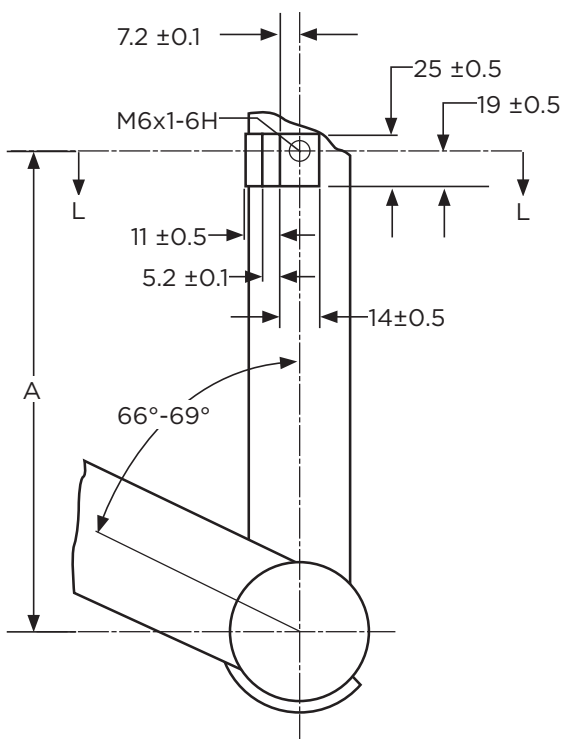

Mid Direct Mount - XX/X0/GX/X9/X7/X5

Mount Dimensions						
	Chainring	Guard	A (mm)	B (mm)	C (mm)	D (mm)
			Mounting slot		Mounting area*	
2x11	36/24	Yes	130.5	132.5	86.5	141.5
		No	128	130	84	139
2x10	34/22	Yes	129.5	131.5	93	148
		No	127	129	88	143
	33/22	Yes	128.5	130.5	84.5	139.5
	36/22	Yes	130.5	132.5	86.5	141.5
		No	128	130	84	139
	38/24	Yes	135	137	93	148
		No	132.5	134.5	88	143

*Requires a 38 mm diameter.

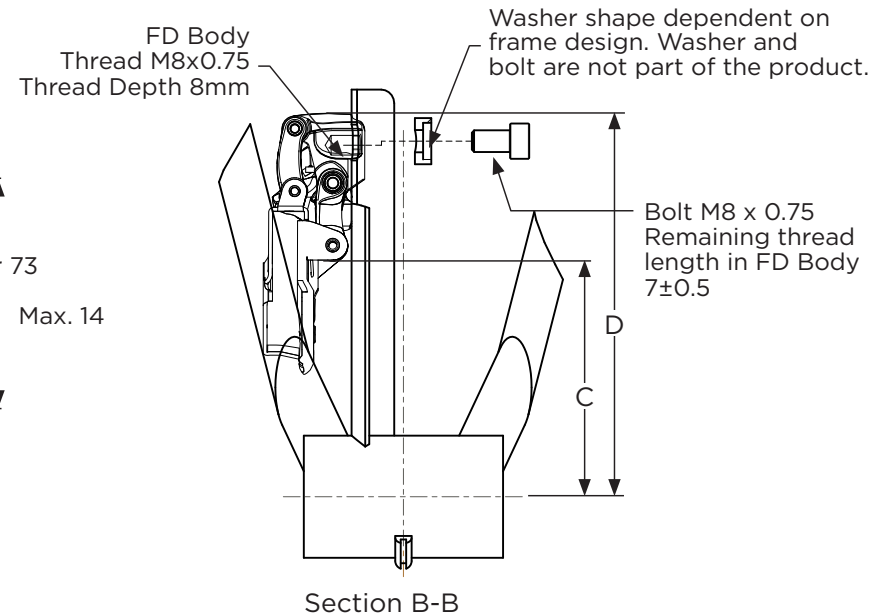
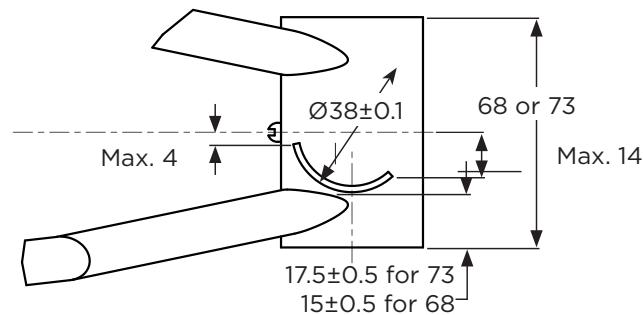
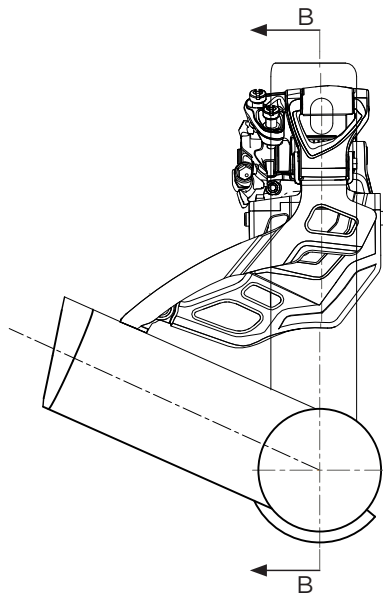
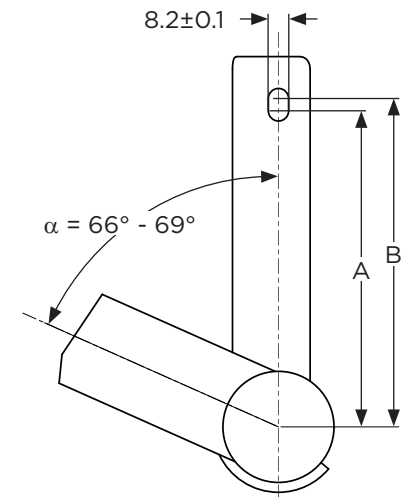

Rear Derailleurs

All Models - Rear Derailleur Frame Hanger

All SRAM 1x11 and 2x11 rear derailleurs are compatible with SRAM designed 12x148 systems.

Rear Derailleur Hanger

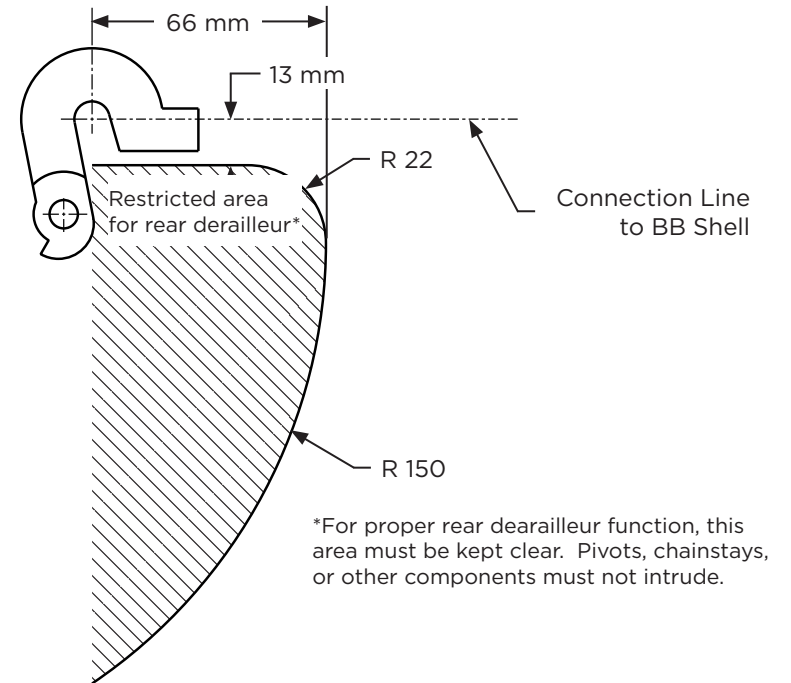
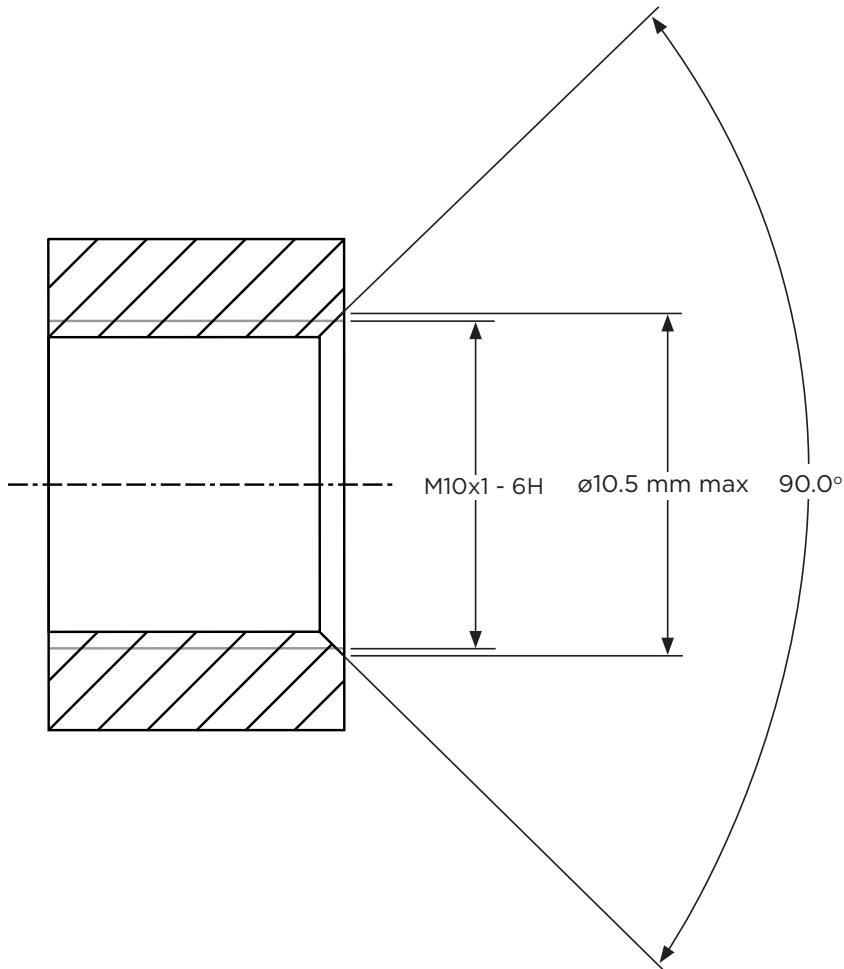

1x11 - XX1/X01/X1/GX - Boost 148 Compatible

Rear Derailleur Hanger Specifications					
L (mm)	X (mm)	A	R1 (mm)	R2 (mm)	T (mm)
Hanger material hardness: HRB > 86					
28-29	6-10	25°-30°	8.5 (max)	13.5-14.5	7-9
30-36	7.5-10				

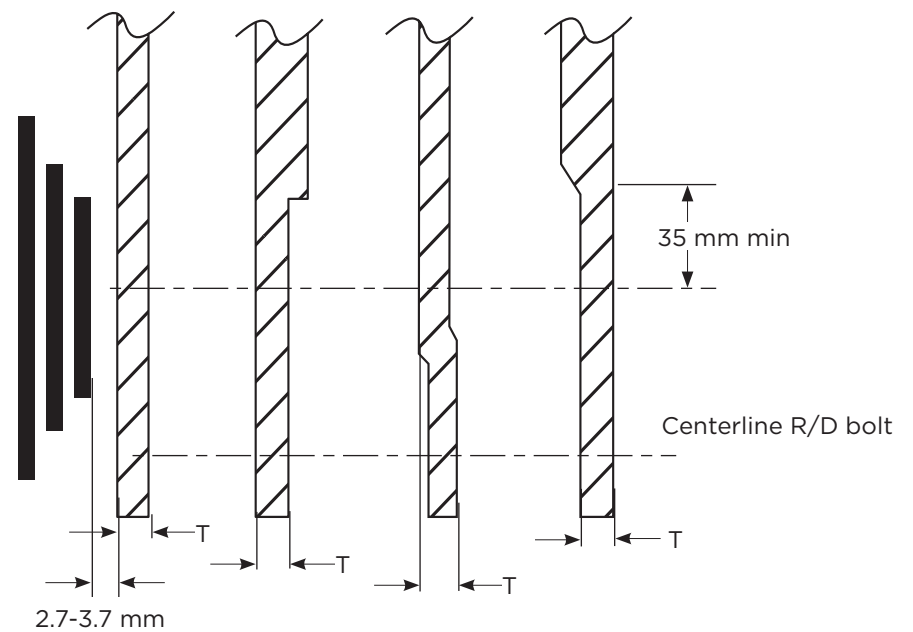
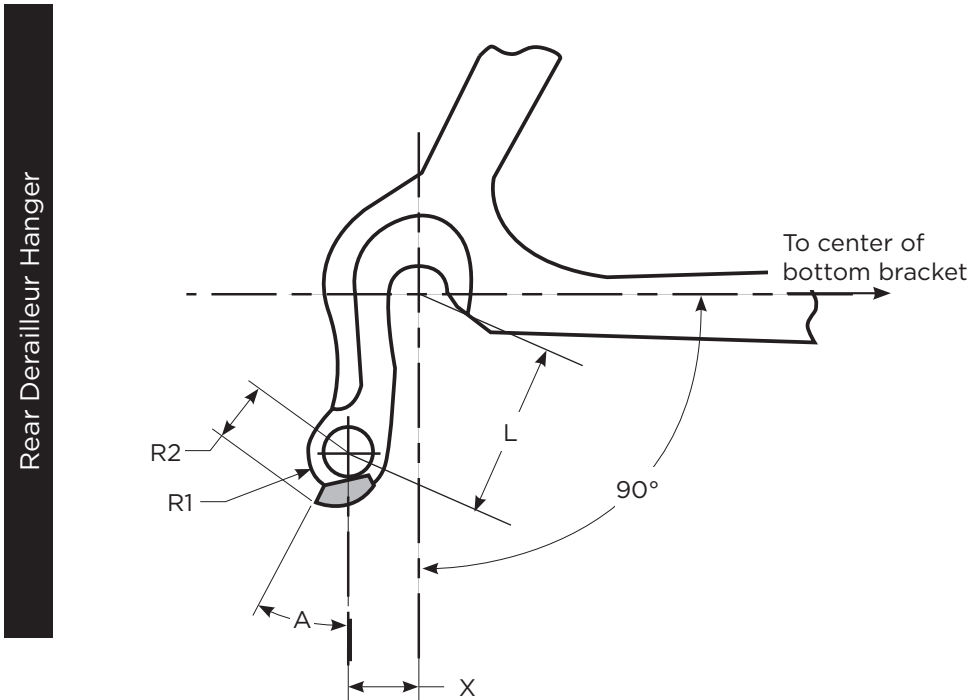

1x10 & 1x7 - X01 DH

Rear Derailleur Hanger Specifications					
L (mm)	X (mm)	A	R1 (mm)	R2 (mm)	T (mm)
Hanger material hardness: HRB > 86					
28-29	6-10	25°-30°	8.5 (max)	13.5-14.5	7-9
30-36	7.5-10				

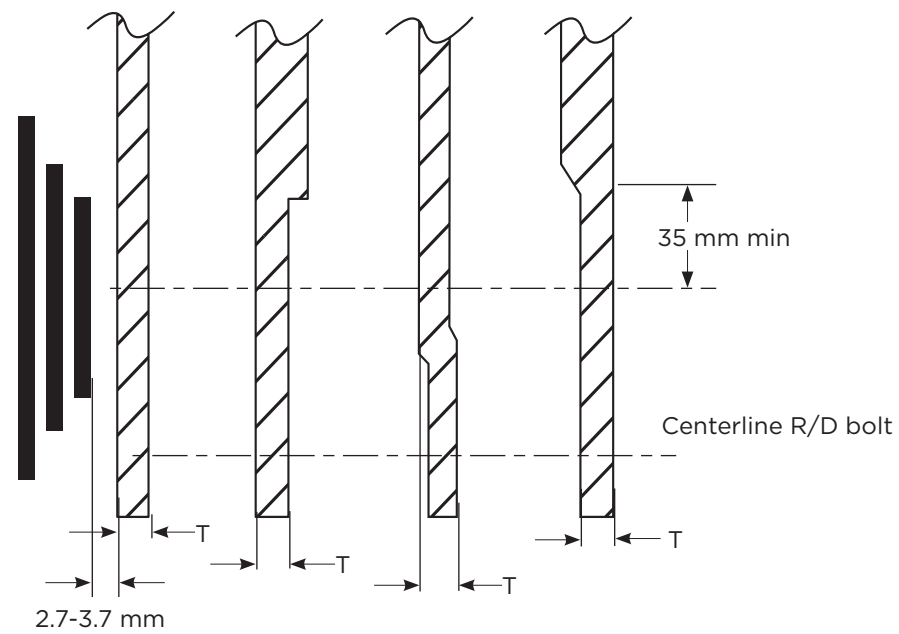
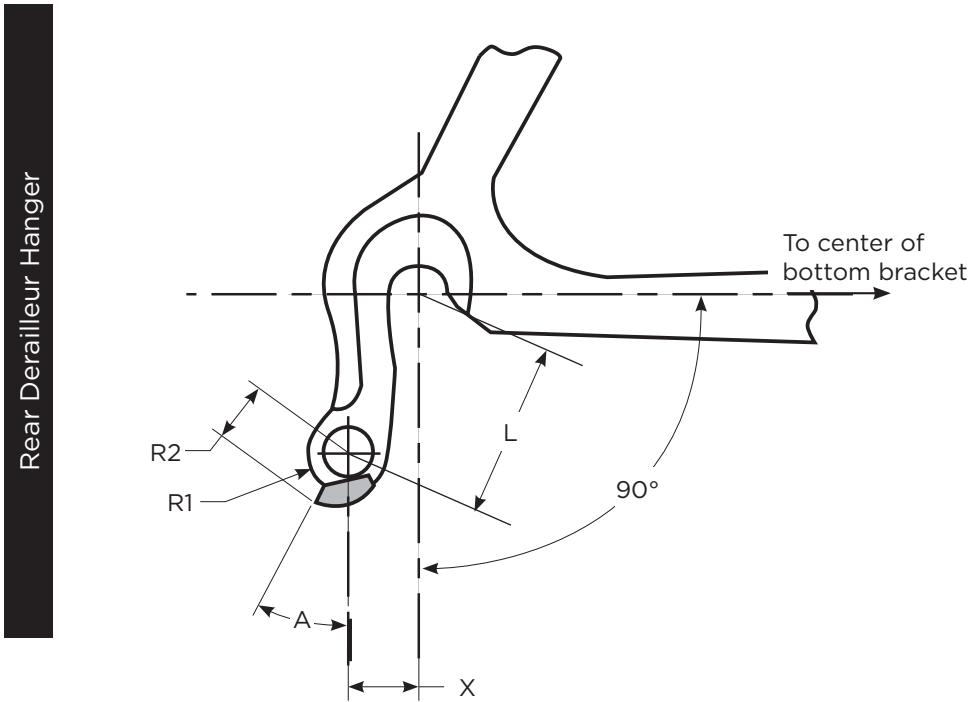

2x11, 2x10 & 3x10 - XX/X0/GX/X9/X7/X5 - Boost 148 Compatible

Rear Derailleur Hanger Specifications					
L (mm)	X (mm)	A	R1 (mm)	R2 (mm)	T (mm)
Hanger material hardness: HRB > 86					
30-36	7.5-10	25°-30°	8.5 (max)	13.5-14.5	7-8

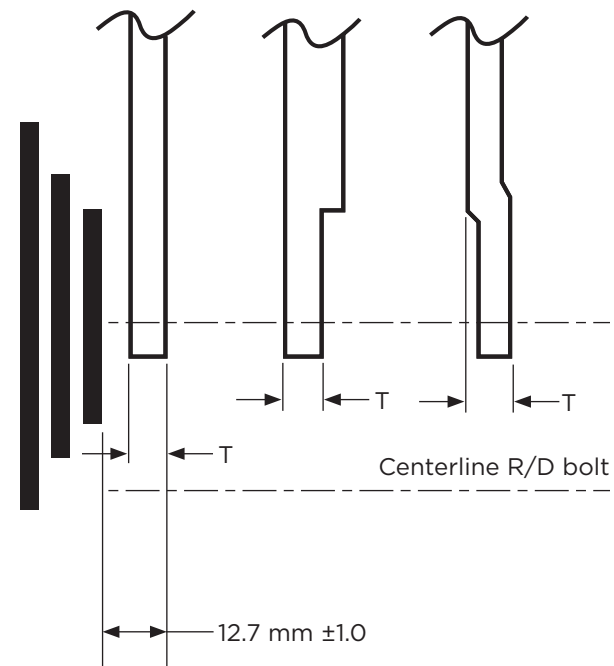
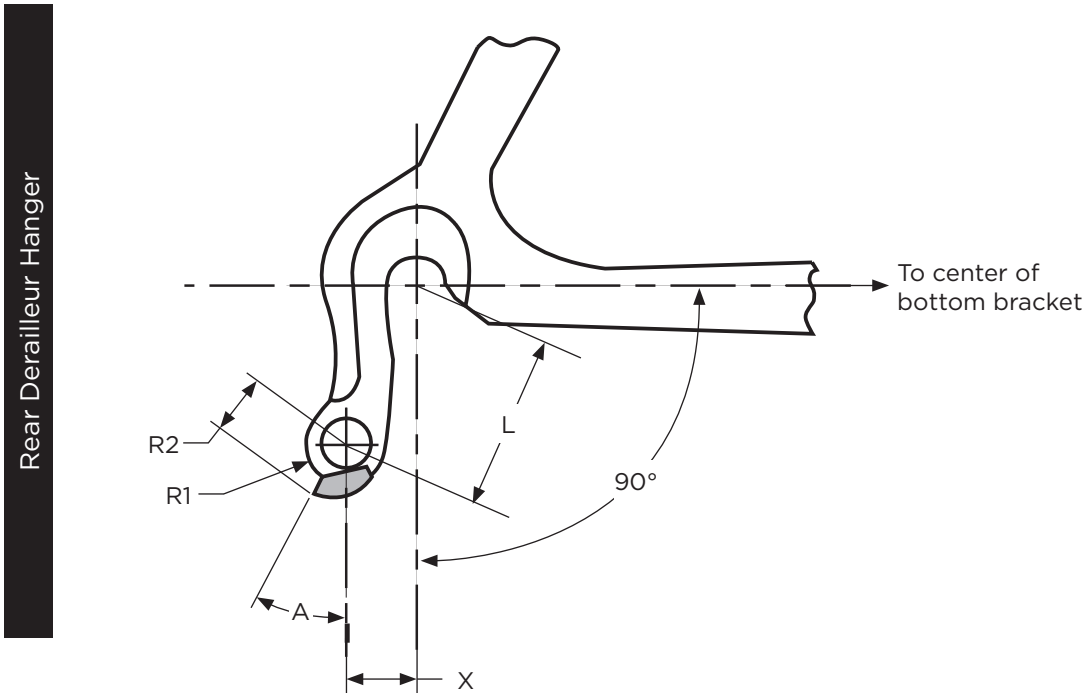

Chainstay Clearance

1x11 & 2x11 Chainstay Clearance

SRAM 1x11 and 2x11 chainstay clearance is compatible with SRAM designed 12x148 systems.

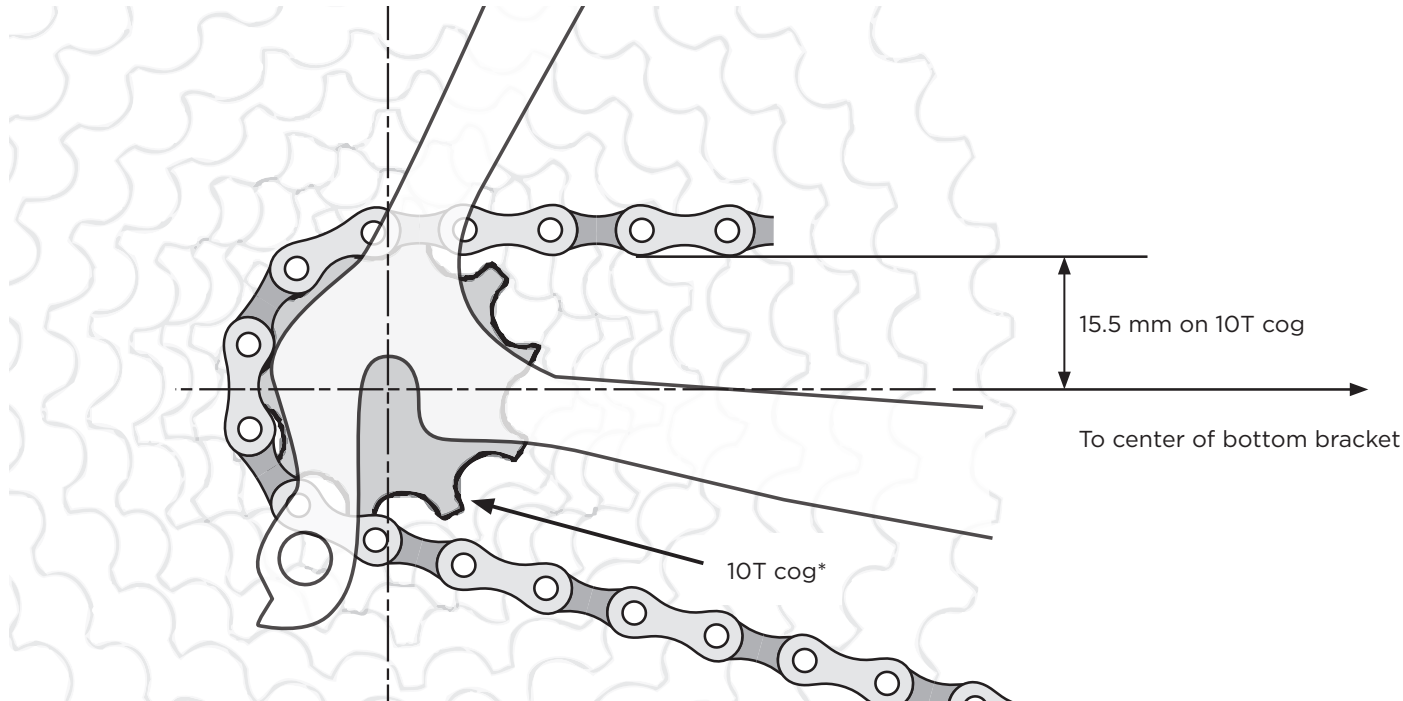

*SRAM 11 speed cassettes are exclusively compatible with the SRAM XD™ Driver Body. For a list of companies using the SRAM XD Driver Body, go to - <http://www.xddriverbody.com/>

1x11 & 1x7 Cranksets

Crank Boot

Crank Boot Clearance Information

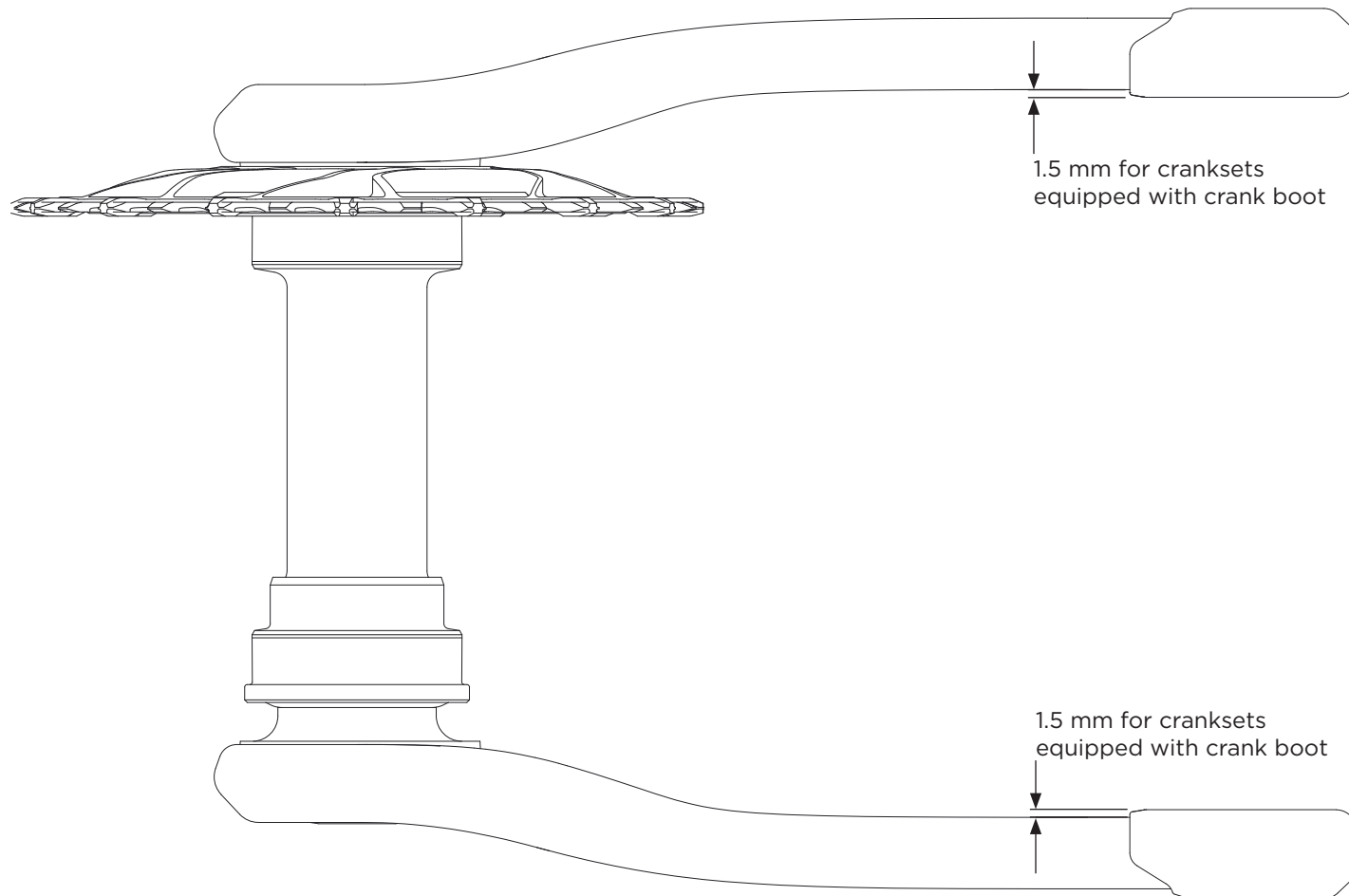

Crankset Frame Clearance Information									
Chainring	L1 (mm)	L2 (mm)	L3 (mm)	L5 (mm)	W1 (mm)	W2 (mm)	W5 (mm)	W6 (mm)	CL (mm)
28	27	41	60.5	195*	45.5	46.5	66.5* (Q156) 72* (Q168)	64.5* (Q156) 70.5* (Q168)	49
30			64.5						
32			68.5						
34			72.5						
36			76.5						
38			80.5						
Q-factor : 156, 168									
Bottom Bracket Type(s): GXP® : BB30™ : PF30™ : PFGXP™									

* Dimensions will vary for cranks equipped with crank boots. Consult [page 31](#) for crank boot dimensions.

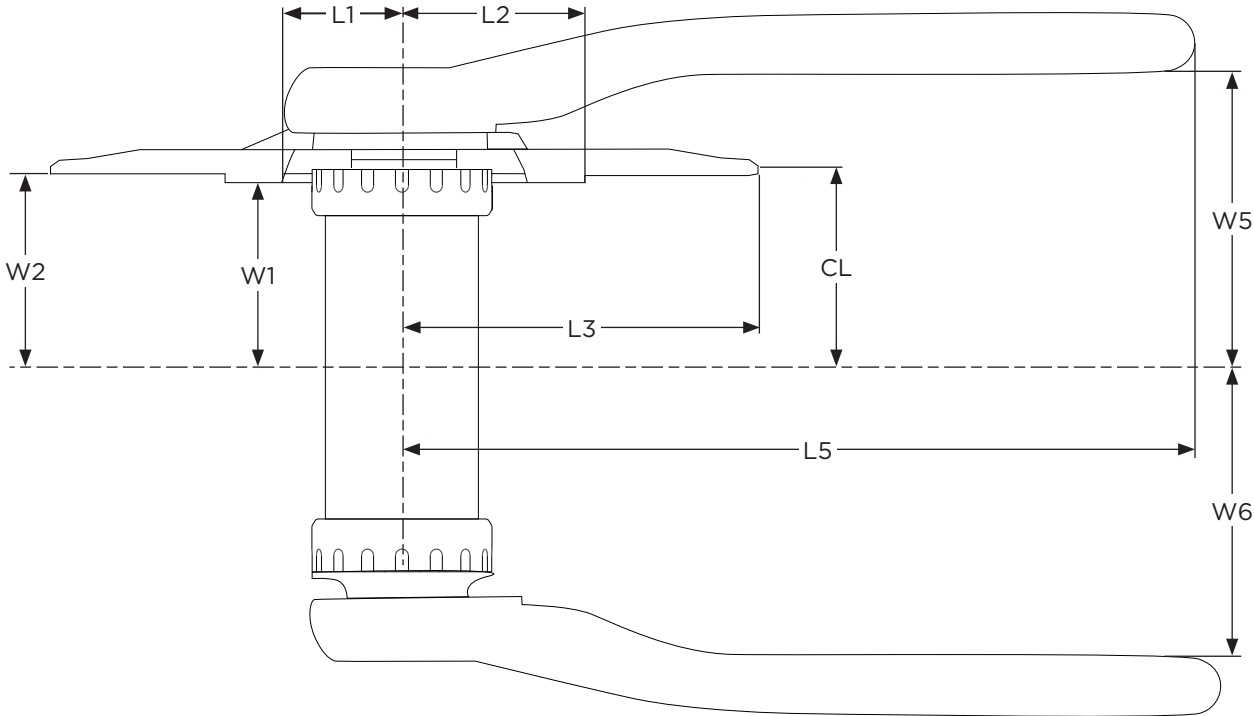

XX1 - Boost 148 Compatible

Crankset Frame Clearance Information									
Chainring	L1 (mm)	L2 (mm)	L3 (mm)	L5 (mm)	W1 (mm)	W2 (mm)	W5 (mm)	W6 (mm)	CL (mm)
28	27	41	60.5	195*	49	50	72 *	70.5*	52
30			64.5						
32			68.5						
34			72.5						
36			76.5						
38			80.5						
Q-factor : 168									
Bottom Bracket Type(s): GXP® : PFGXP™									

* Dimensions will vary for cranks equipped with crank boots. Consult [page 31](#) for crank boot dimensions.

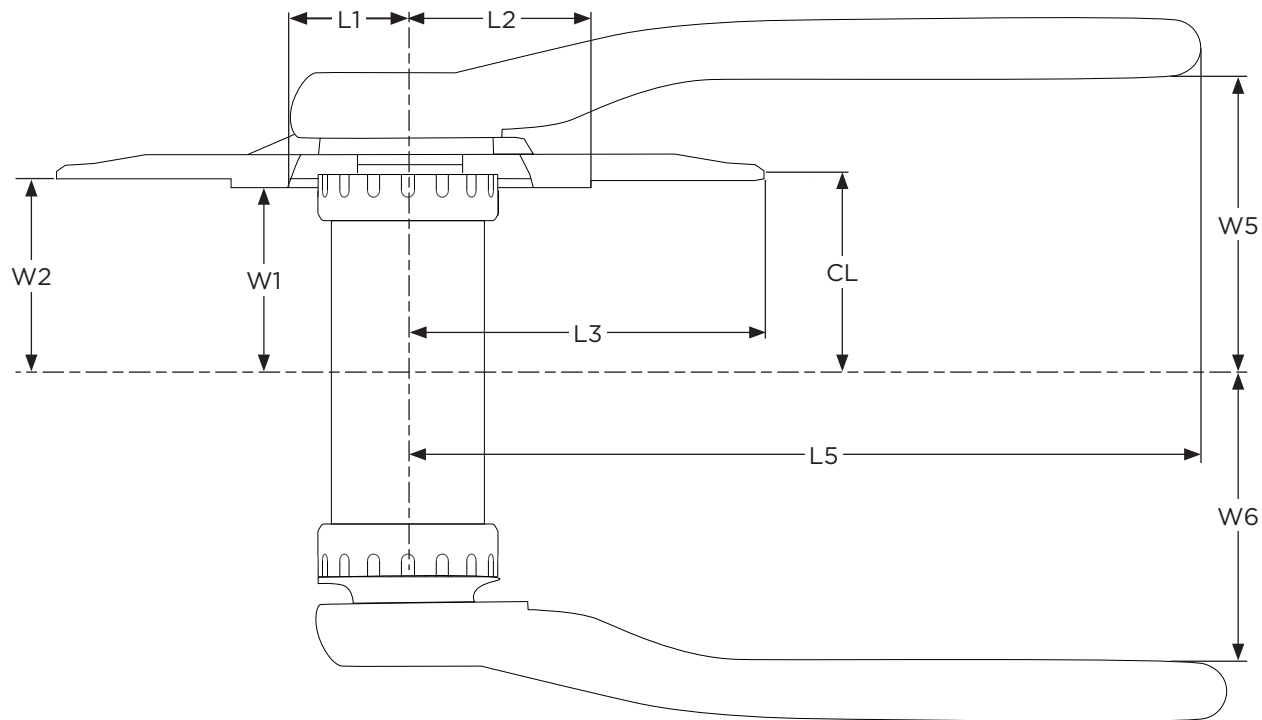

XX1 - Fat bike

Crankset Frame Clearance Information									
Chainring	L1 (mm)	L2 (mm)	L3 (mm)	L5 (mm)	W1 (mm)	W2 (mm)	W5 (mm)	W6 (mm)	CL (mm)
28	27	41	60.5	195*	63.5	64.5	89.5*	86.5*	66.5 mm
30			64.5						
1x11	Q-factor : 201								
	Bottom Bracket Type(s): GXP® : PFGXP™								

* Dimensions will vary for cranks equipped with crank boots. Consult [page 31](#) for crank boot dimensions.

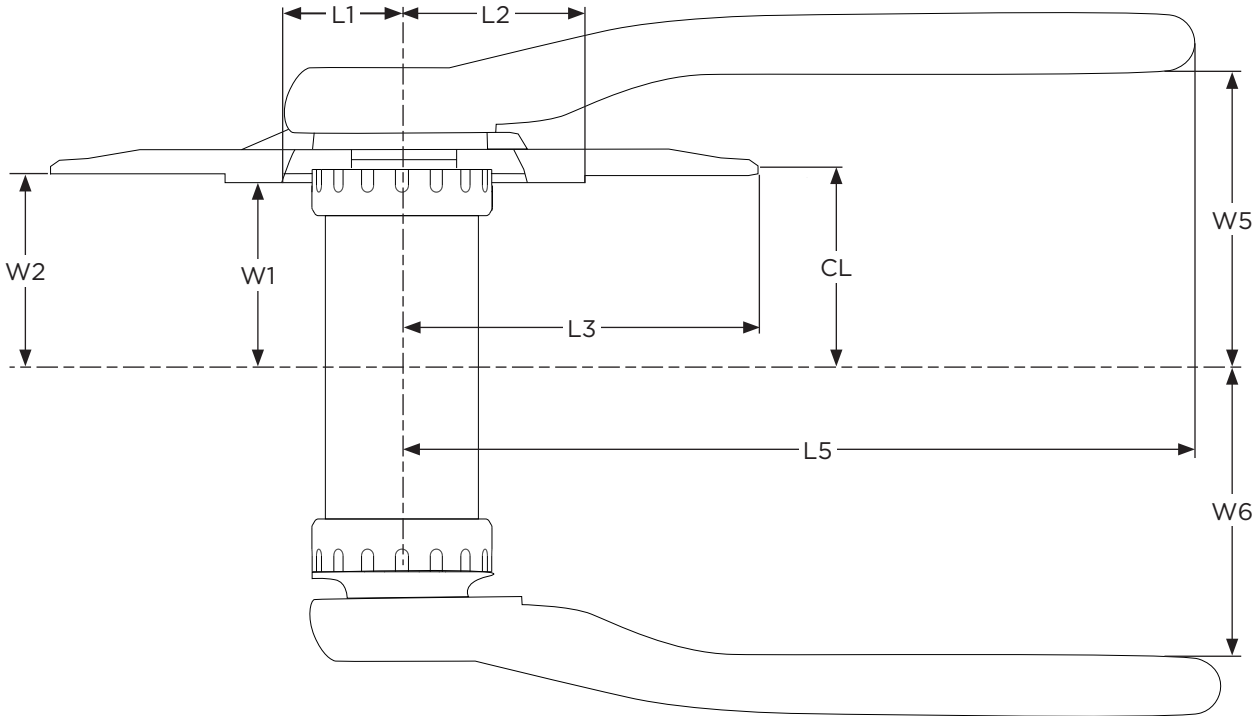

Crankset Frame Clearance Information												
Chainring	L1 (mm)	L2 (mm)	L3 (mm)	L4 (mm)	L5 (mm)	W1 (mm)	W2 (mm)	W3 (mm)	W5 (mm)	W6 (mm)	CL (mm)	
30	23	40	64.5	69.5	195*	45.5	46.5	55.5	72*	70.5*	49	
32			68.5	73.5								
34			72.5	77.5								
36			76.5	81.5								
38			80.5	85.5								
Q-factor : 168												
Bottom Bracket Type(s): GXP® : BB30™ : PF30™ : PFGXP™												

* Dimensions will vary for cranks equipped with crank boots. Consult [page 31](#) for crank boot dimensions.

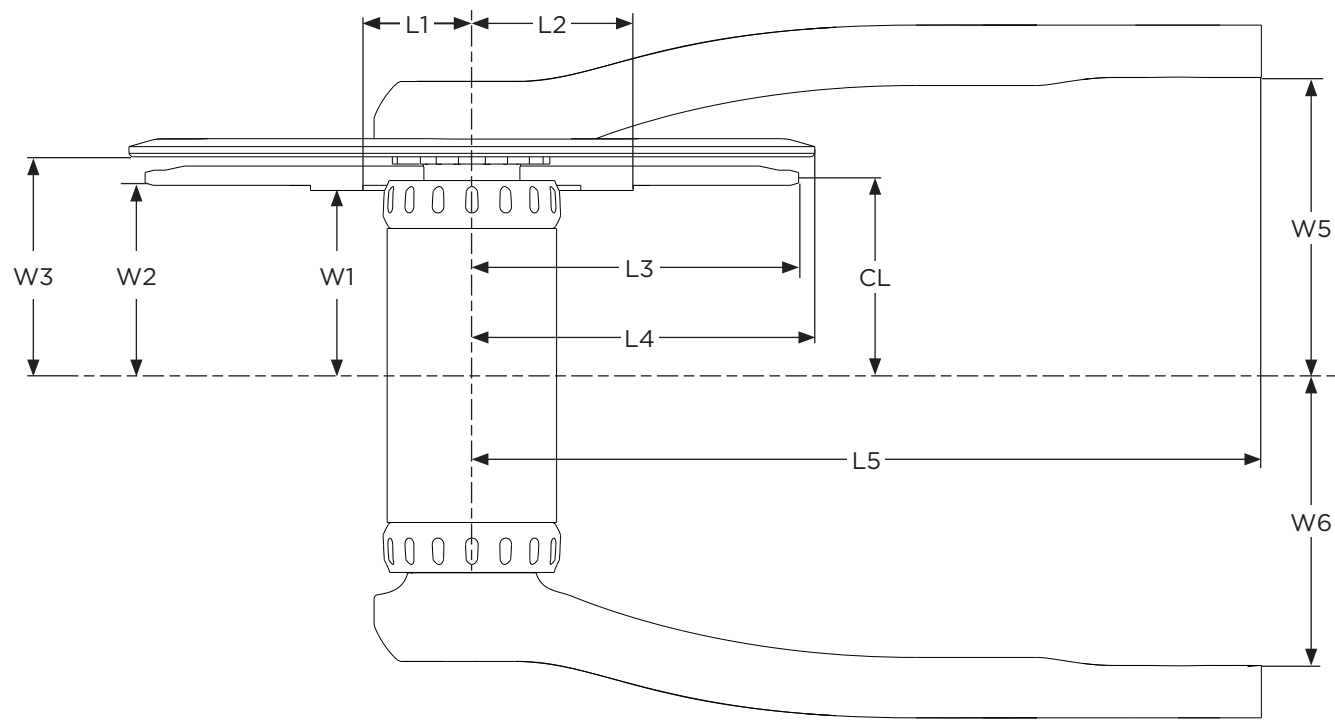

X01 - Boost 148 Compatible

Crankset Frame Clearance Information									
Chainring	L1 (mm)	L2 (mm)	L3 (mm)	L5 (mm)	W1 (mm)	W2 (mm)	W5 (mm)	W6 (mm)	CL (mm)
30	23	40	64.5	195*	45.5	49.5	72*	70.5*	52
32			68.5						
34			72.5						
36			76.5						
38			80.5						
Q-factor : 168									
Bottom Bracket Type(s): GXP® : BB30™ : PF30™ : PFGXP™									

* Dimensions will vary for cranks equipped with crank boots. Consult [page 31](#) for crank boot dimensions.

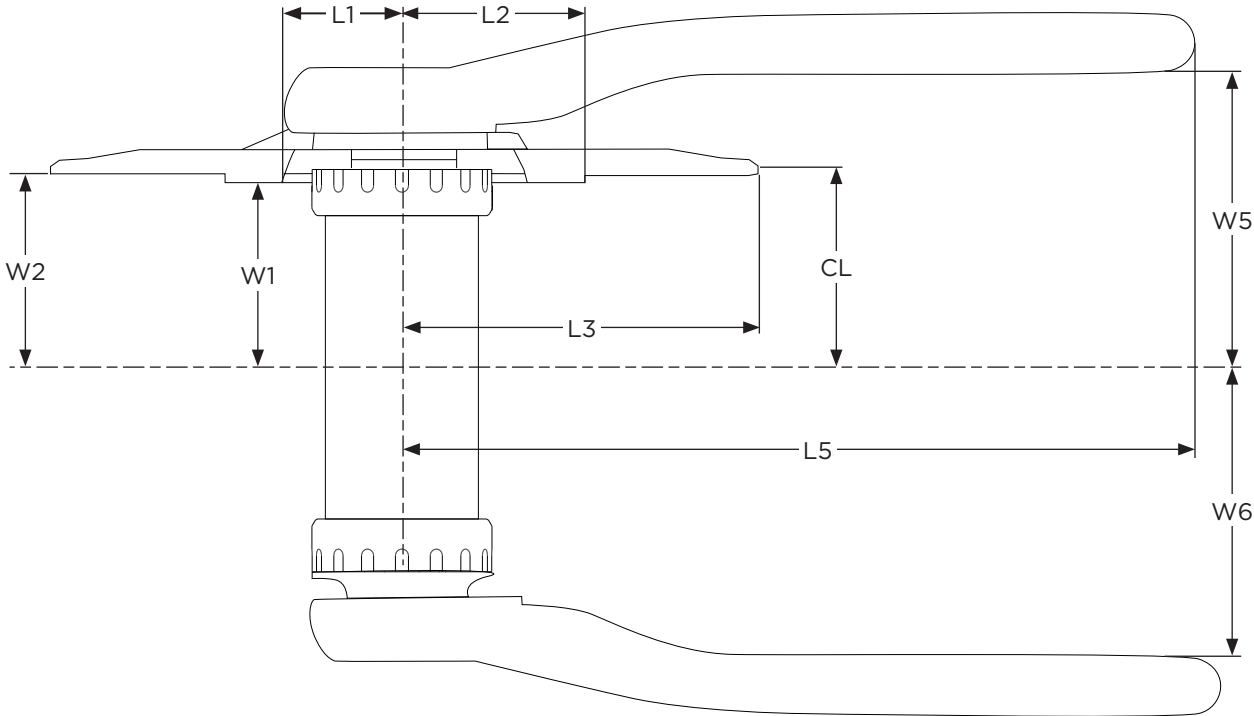

X01 DH

Crankset Frame Clearance Information									
Chainring	L1 (mm)	L2 (mm)	L3 (mm)	L5 (mm)	W1 (mm)	W2 (mm)	W5 (mm)	W6 (mm)	CL (mm)
32	23	40	68.5	190* (170 mm crank arm)	55	53	78*	78*	55
34			72.5						
36			76.5						
38			80.5						
Q-factor : 181									
Bottom Bracket Type(s): GXP® : BB30™ : PF30™ : PFGXP™									

* Dimensions will vary for cranks equipped with crank boots. Consult [page 31](#) for crank boot dimensions.

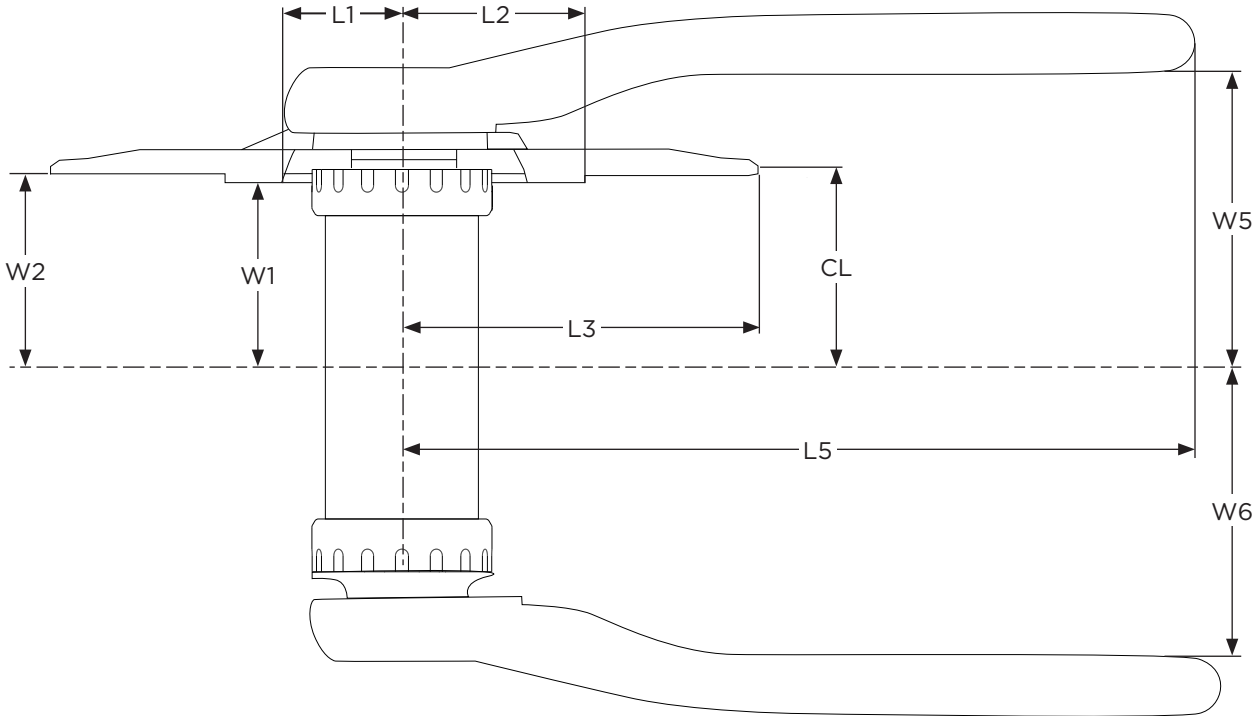

GX-1400/X1-1400

Crankset Frame Clearance Information												
Chainring	L1 (mm)	L2 (mm)	L3 (mm)	L4 (mm)	L5 (mm)	W1 (mm)	W2 (mm)	W3 (mm)	W5 (mm)	W6 (mm)	CL (mm)	
30	23	40	64.5	69.5	192	43.5	46.5	55.5	72	72	49	1x11
32			68.5	73.5								
34			72.5	77.5								
36			76.5	81.5								
38			80.5	85.5								
Q-factor : 168												
Bottom Bracket Type(s): GXP® : BB30™ : PF30™ : PFGXP™												

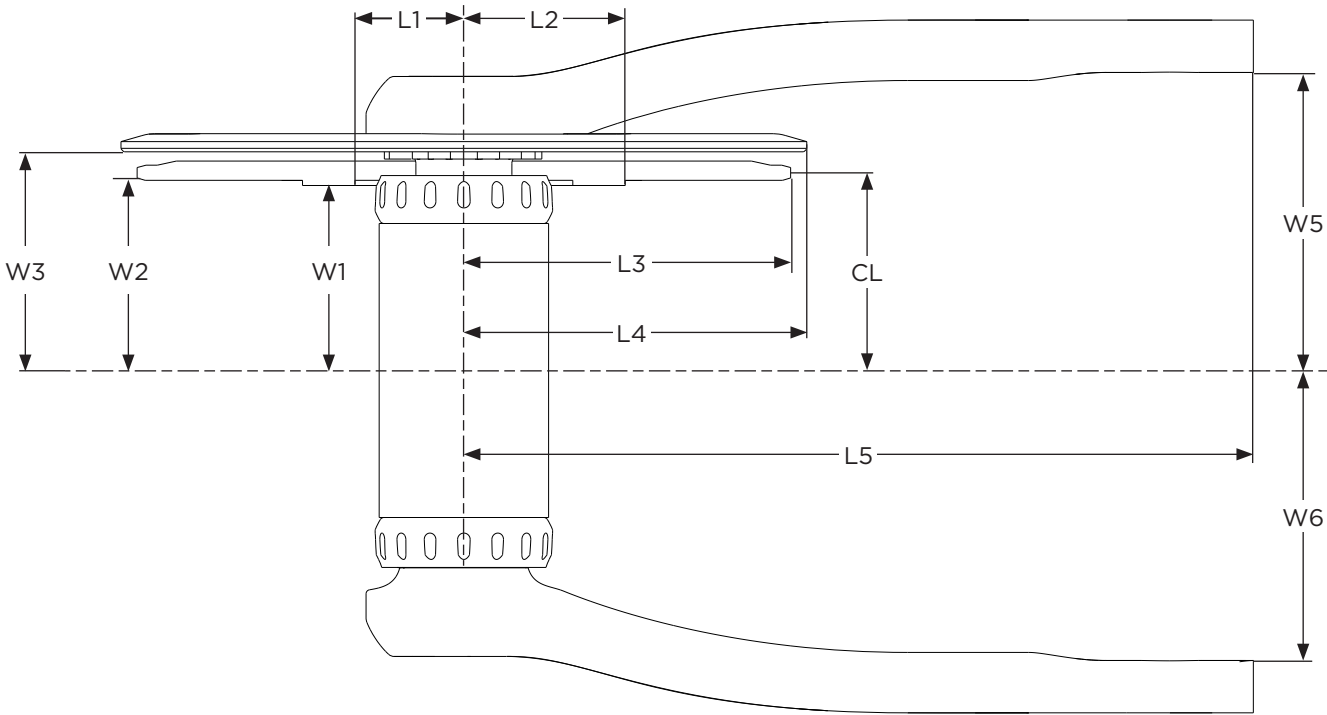

GX-1400/X1-1400 - Boost 148 Compatible

Crankset Frame Clearance Information											
Chainring	L1 (mm)	L2 (mm)	L3 (mm)	L4 (mm)	L5 (mm)	W1 (mm)	W2 (mm)	W3 (mm)	W5 (mm)	W6 (mm)	CL (mm)
30	23	40	64.5	69.5	192	52.5	50	57.3	72	72	52
32			68.5	73.5							
34			72.5	77.5							
36			76.5	81.5							
38			80.5	85.5							
Q-factor : 168											
Bottom Bracket Type(s): GXP® : BB30™ : PF30™ : PFGXP™											

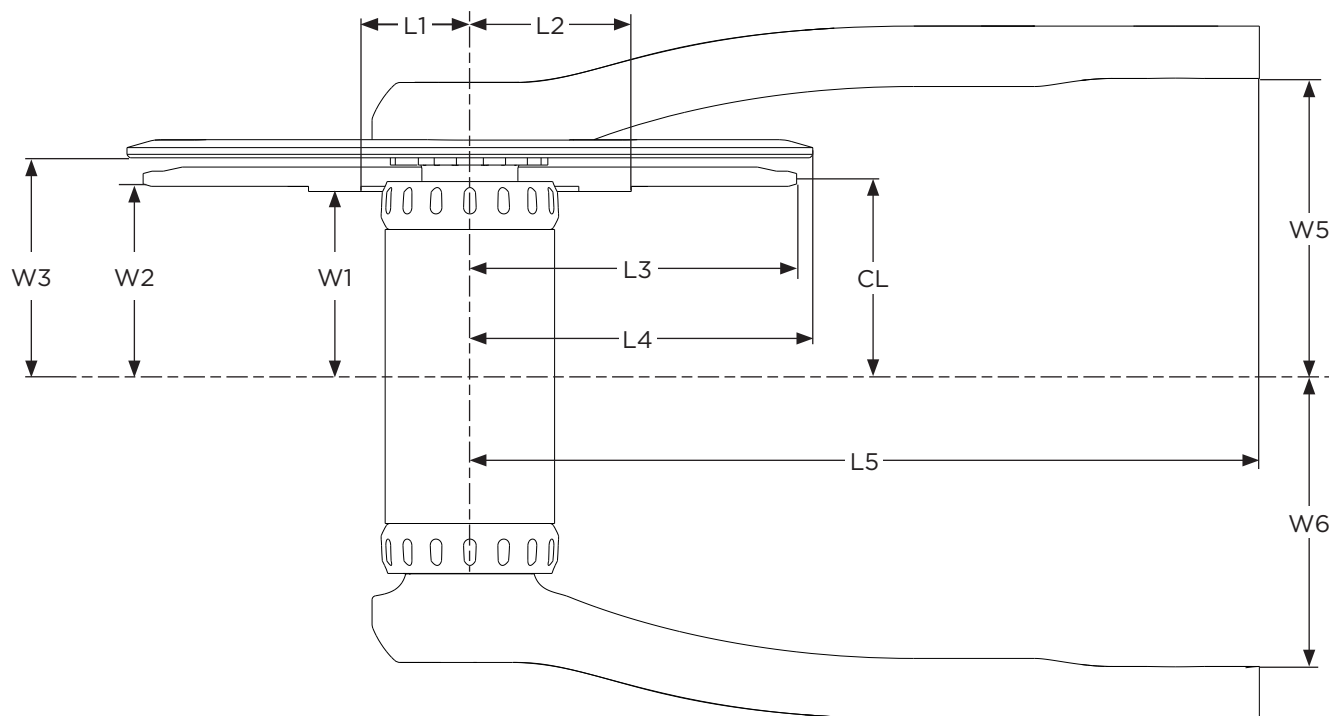

GX-1400 - Fat bike

Crankset Frame Clearance Information									
Chainring	L1 (mm)	L2 (mm)	L3 (mm)	L5 (mm)	W1 (mm)	W2 (mm)	W5 (mm)	W6 (mm)	CL (mm)
30	23	40	64.5	192	67	64.5	91.5	88	66.5
32			68.5						
1x11	Q-factor : 203.5								
	Bottom Bracket Type(s): GXP® : PFGXP™								

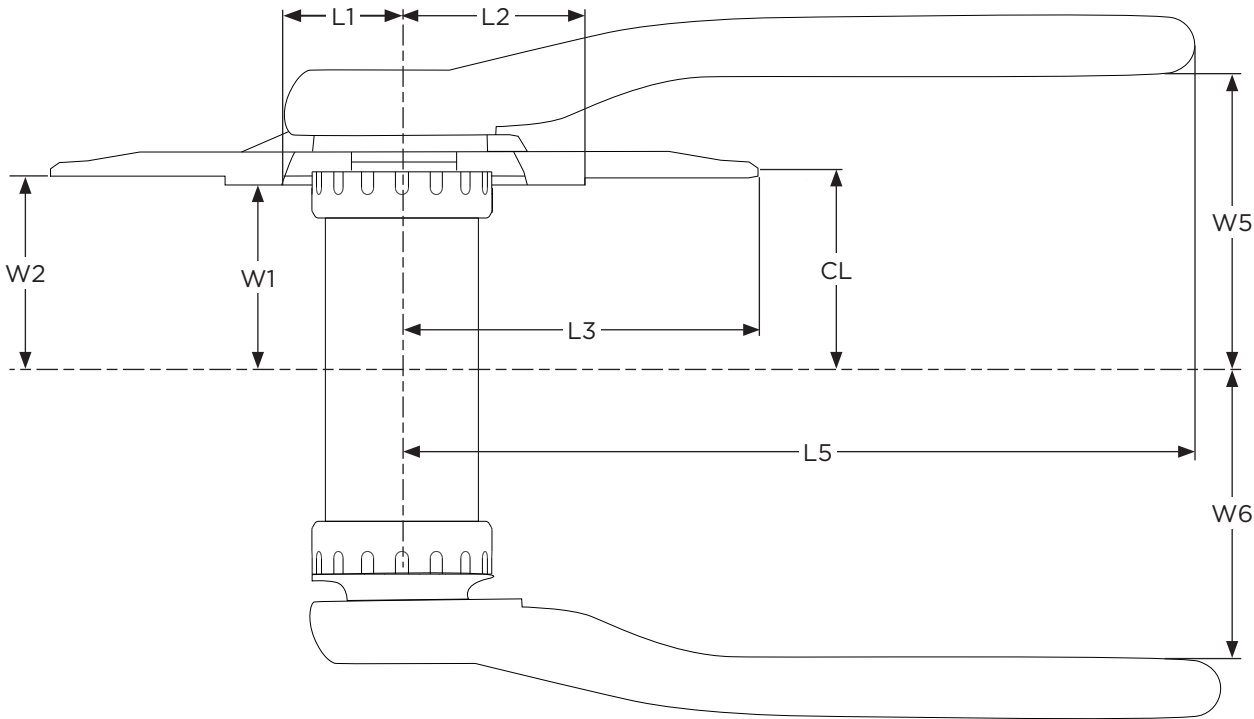

X1-1200/X1-1000

Crankset Frame Clearance Information									
Chainring	L1 (mm)	L2 (mm)	L3 (mm)	L5 (mm)	W1 (mm)	W2 (mm)	W5 (mm)	W6 (mm)	CL (mm)
30	25	40	64.5	192	49.5	47.2	72	72	49
32			68.5						
34			72.5						
36			76.5						
38			80.5						
Q-factor : 168									
Bottom Bracket Type(s): GXP® : BB30™ : PF30™ : PFGXP™									

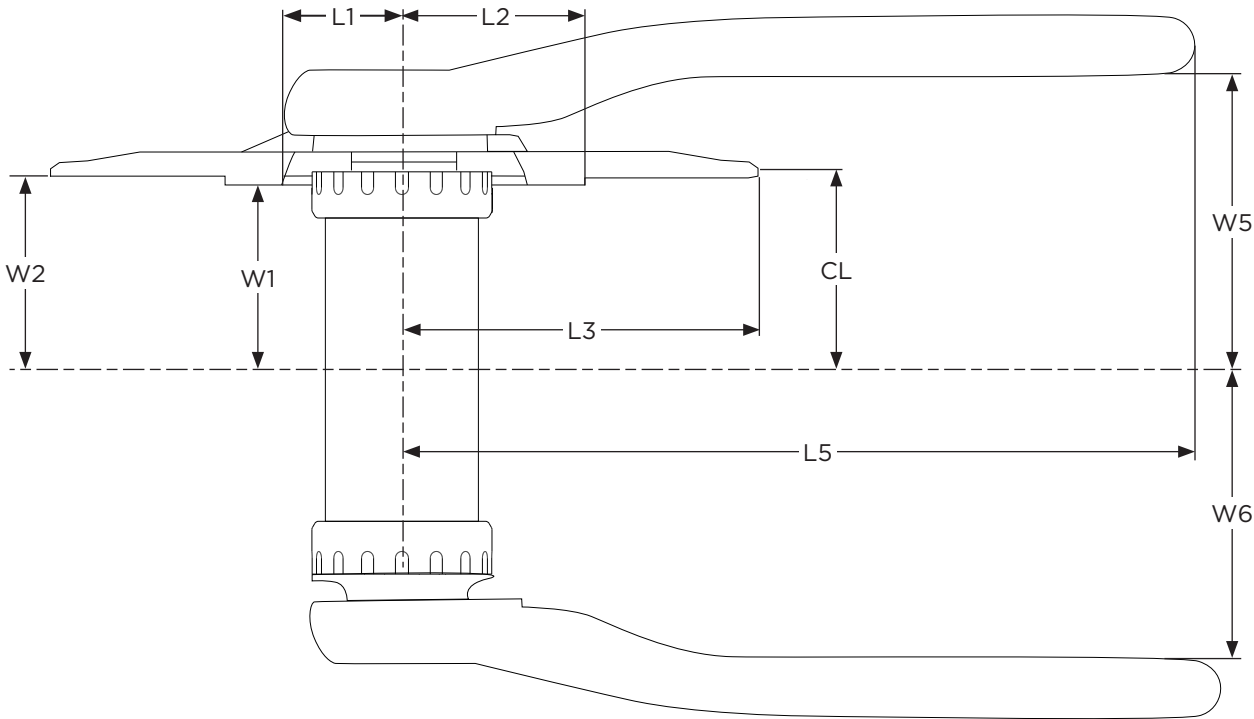

GX-1000

Crankset Frame Clearance Information												
Chainring	L1 (mm)	L2 (mm)	L3 (mm)	L4 (mm)	L5 (mm)	W1 (mm)	W2 (mm)	W3 (mm)	W5 (mm)	W6 (mm)	CL (mm)	
30	23	40	64.5	69.5	192	52.5	46.5	55.5	72	72	49	1x11
32			68.5	73.5								
34			72.5	77.5								
36			76.5	81.5								
38			80.5	85.5								
Q-factor : 169												
Bottom Bracket Type(s): GXP® : BB30™ : PF30™ : PFGXP™												

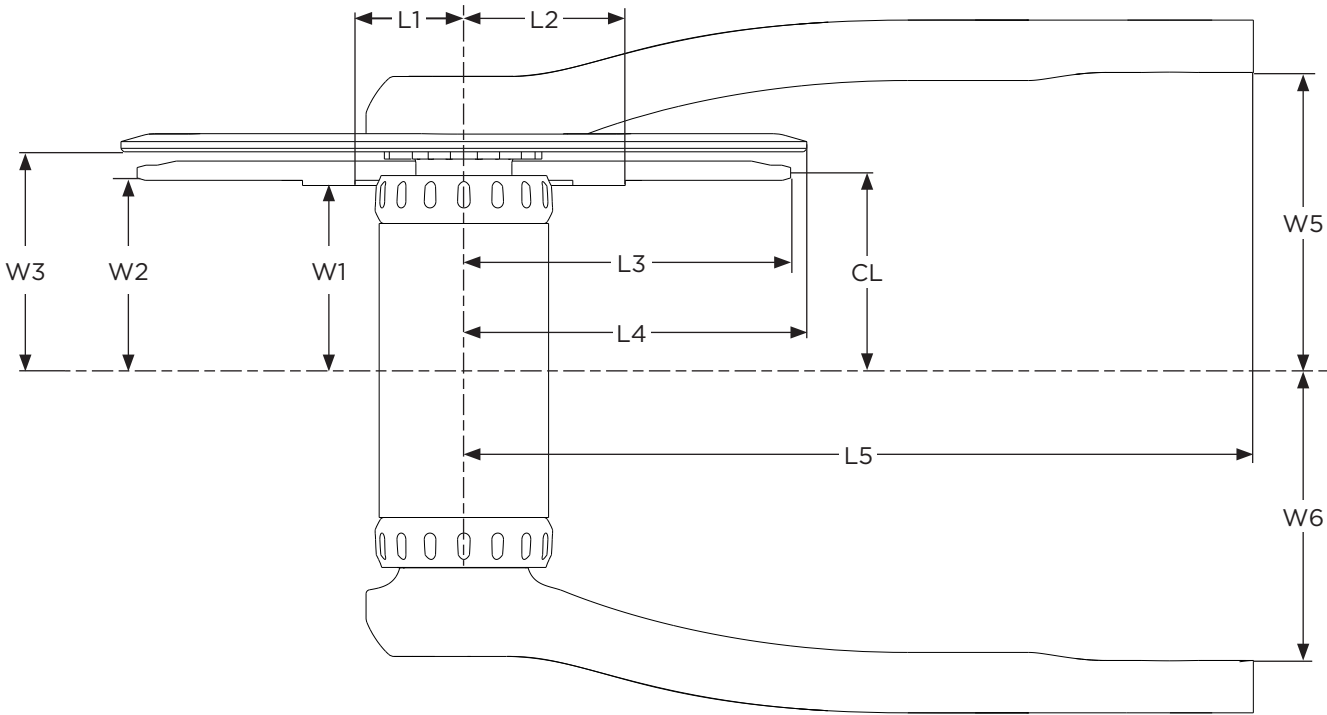

GX-1000 - Boost 148 Compatible

Crankset Frame Clearance Information												
Chainring	L1 (mm)	L2 (mm)	L3 (mm)	L4 (mm)	L5 (mm)	W1 (mm)	W2 (mm)	W3 (mm)	W5 (mm)	W6 (mm)	CL (mm)	
30	23	40	64.5	69.5	192	52.5	50	57.3	72	72	52	
32			68.5	73.5								
34			72.5	77.5								
36			76.5	81.5								
38			80.5	85.5								
Q-factor : 169												
Bottom Bracket Type(s): GXP® : BB30™ : PF30™ : PFGXP™												

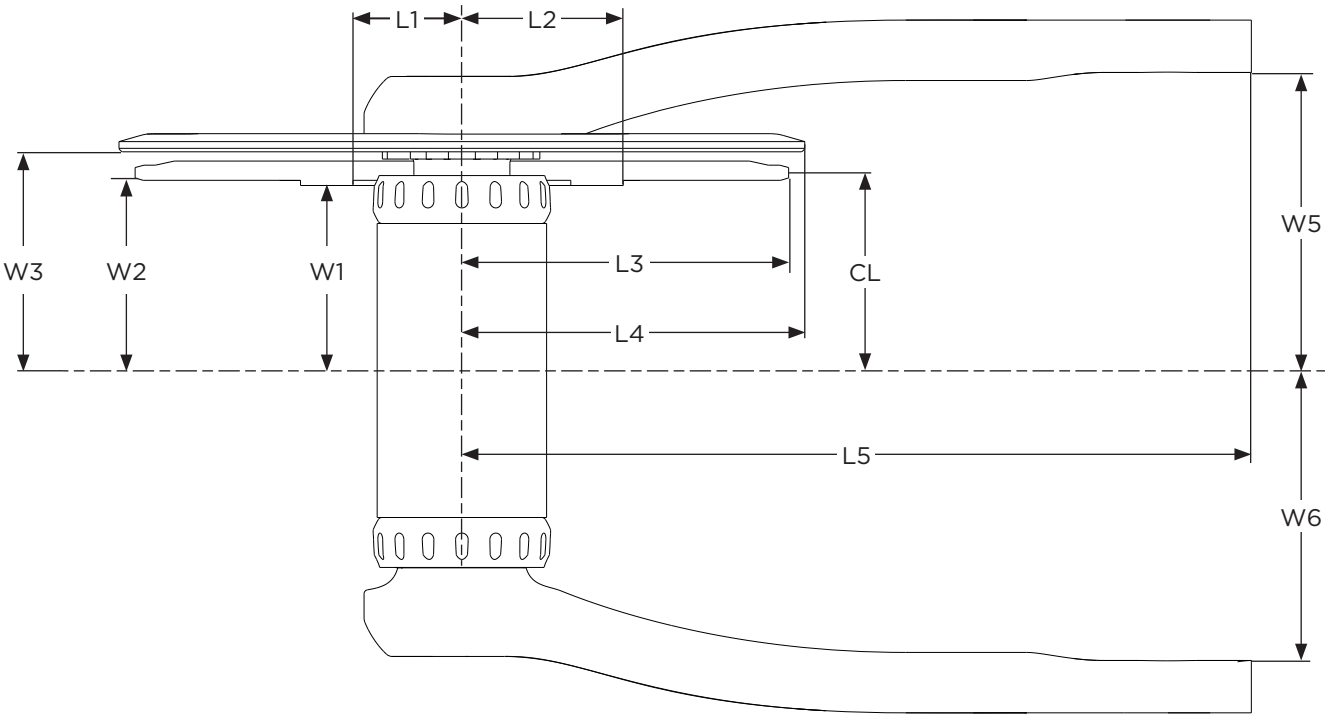

GX-1000/X1-1000 - Fat bike

Crankset Frame Clearance Information									
Chainring	L1 (mm)	L2 (mm)	L3 (mm)	L5 (mm)	W1 (mm)	W2 (mm)	W5 (mm)	W6 (mm)	CL (mm)
30	27	41	64.5	192	67.0	64.5	89.5	88.0	66.5
32			68.5						
1x11	Q-factor : 203								
	Bottom Bracket Type(s): GXP® : BB30™ : PF30™ : PFGXP™								

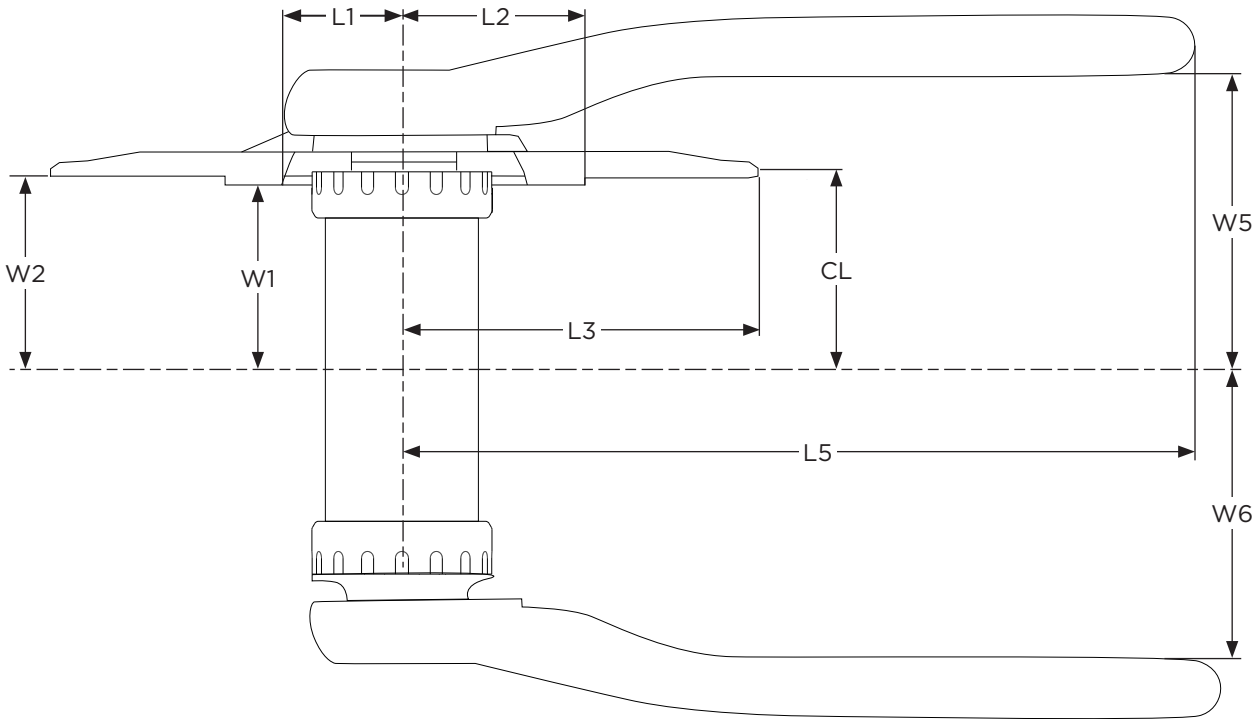

2x11 Cranksets

GX-1400

Crankset Frame Clearance Information												
Chainring	L1 (mm)	L2 (mm)	L3 (mm)	L4 (mm)	L5 (mm)	W1 (mm)	W2 (mm)	W3 (mm)	W4 (mm)	W5 (mm)	W6 (mm)	CL (mm)
36/24	24.5	50.7	74.4	78	192	43	44	52	57.8	72	72	49
												Q-factor : 171
Bottom Bracket Type(s): GXP® : BB30™ : PF30™ : PFGXP™												

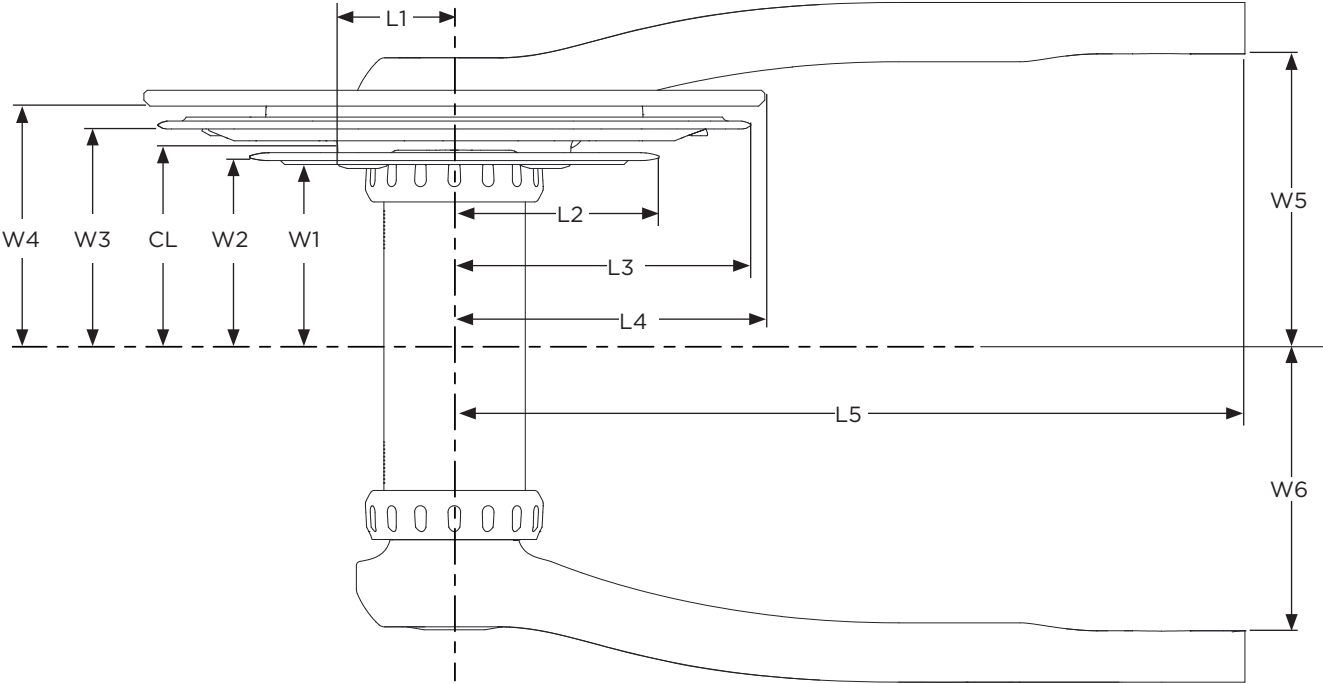

GX-1400 - Boost 148 Compatible

Crankset Frame Clearance Information													
Chainring	L1 (mm)	L2 (mm)	L3 (mm)	L4 (mm)	L5 (mm)	W1 (mm)	W2 (mm)	W3 (mm)	W4 (mm)	W5 (mm)	W6 (mm)	CL (mm)	
36/24	25	50.8	74.4	78	192	46	47	55	60.8	72	72	52	
2x11	Q-factor : 171												
	Bottom Bracket Type(s): GXP® : BB30™ : PF30™ : PFGXP™												

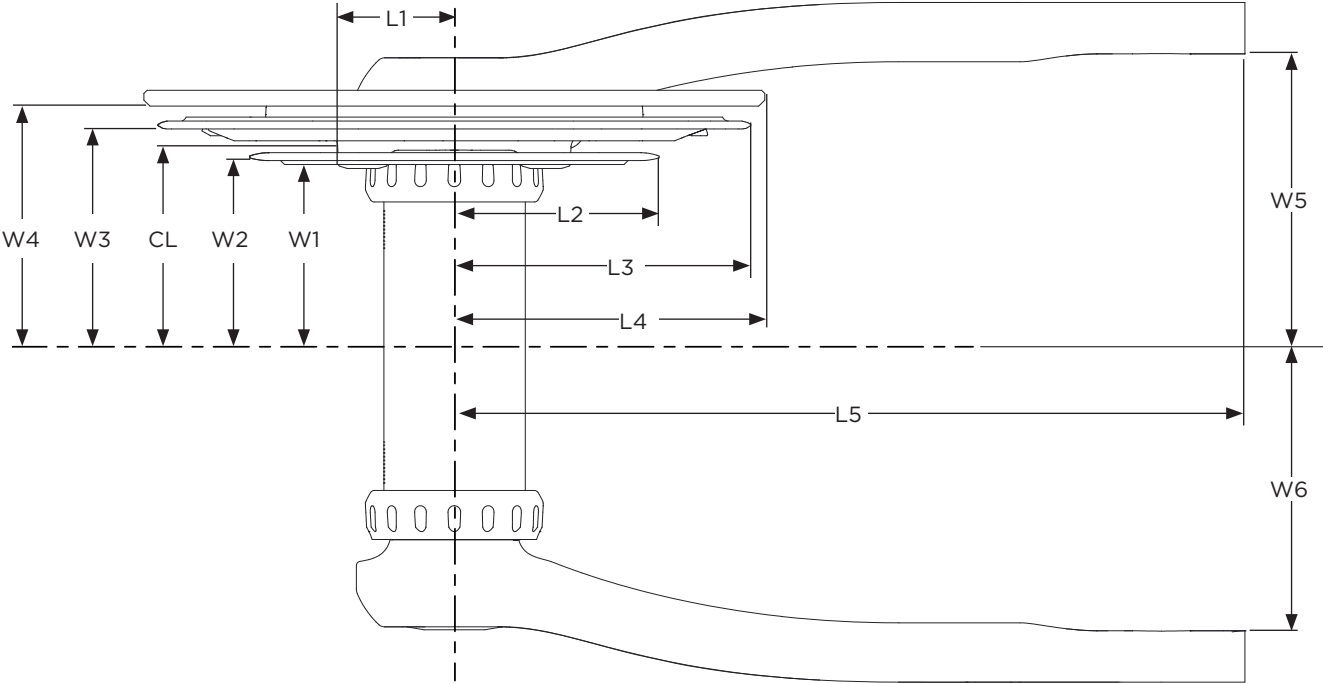

GX-1400 - Fat bike

Crankset Frame Clearance Information										
Chainring	L1 (mm)	L2 (mm)	L3 (mm)	L5 (mm)	W1 (mm)	W2 (mm)	W3 (mm)	W5 (mm)	W6 (mm)	CL (mm)
36/24	24.5	50.7	74.4	192	60.5	61.5	69.5	91.5	88	66.5
										Q-factor : 203.5
Bottom Bracket Type(s): GXP® : PFGXP™										

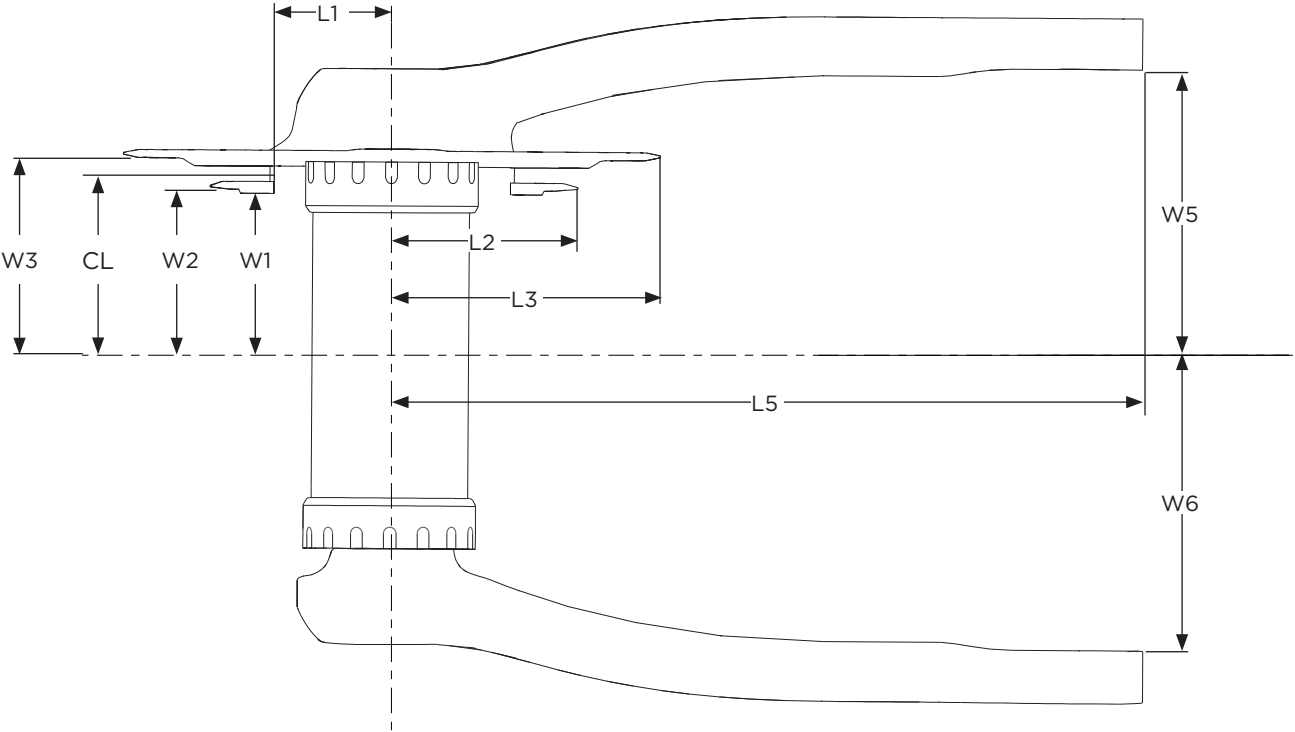

GX-1000

Crankset Frame Clearance Information												
Chainring	L1 (mm)	L2 (mm)	L3 (mm)	L4 (mm)	L5 (mm)	W1 (mm)	W2 (mm)	W3 (mm)	W4 (mm)	W5 (mm)	W6 (mm)	CL (mm)
36/24	24.5	50.7	74.4	78	192	43	44	52	57.8	72	72	49
2x11	Q-factor : 169											
	Bottom Bracket Type(s): GXP® : BB30™ : PF30™ : PFGXP™											

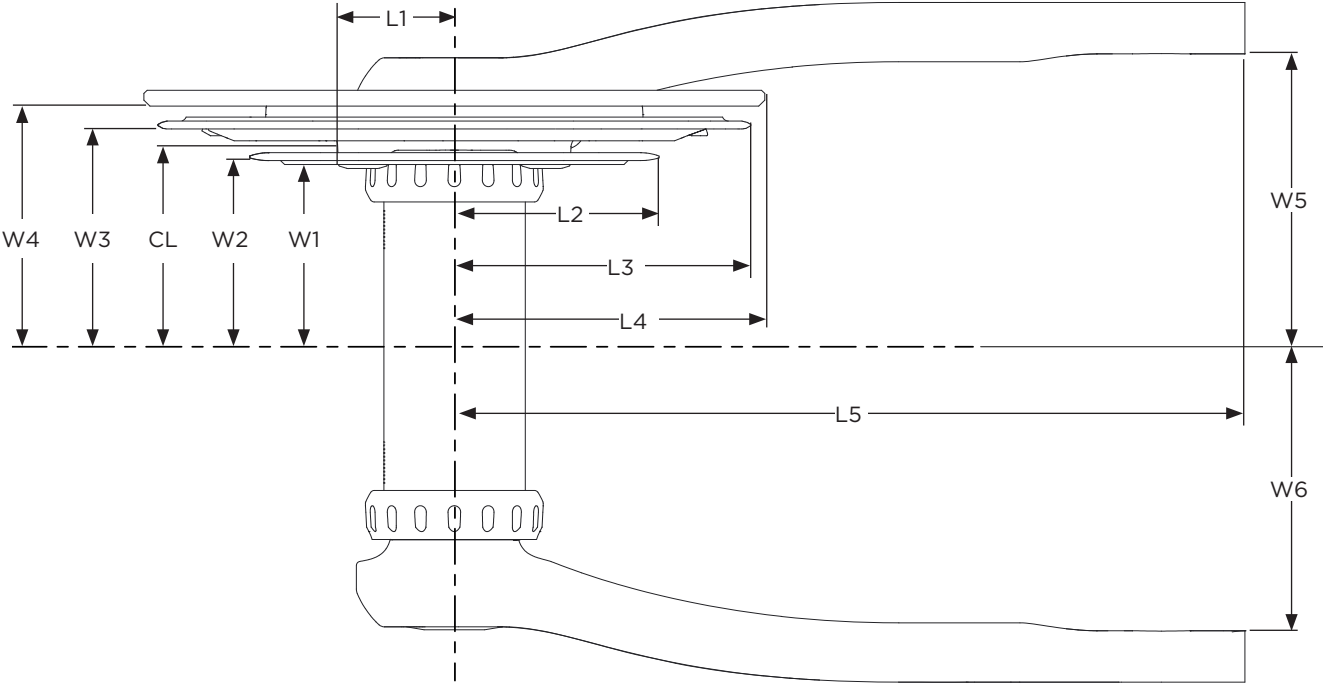

GX-1000 - Boost 148 Compatible

Crankset Frame Clearance Information										
Chainring	L1 (mm)	L2 (mm)	L3 (mm)	L5 (mm)	W1 (mm)	W2 (mm)	W3 (mm)	W5 (mm)	W6 (mm)	CL (mm)
36/24	24.5	50.7	74.4	192	46	47	55	72	72	52
										Q-factor : 169
Bottom Bracket Type(s): GXP® : BB30™ : PF30™ : PFGXP™										

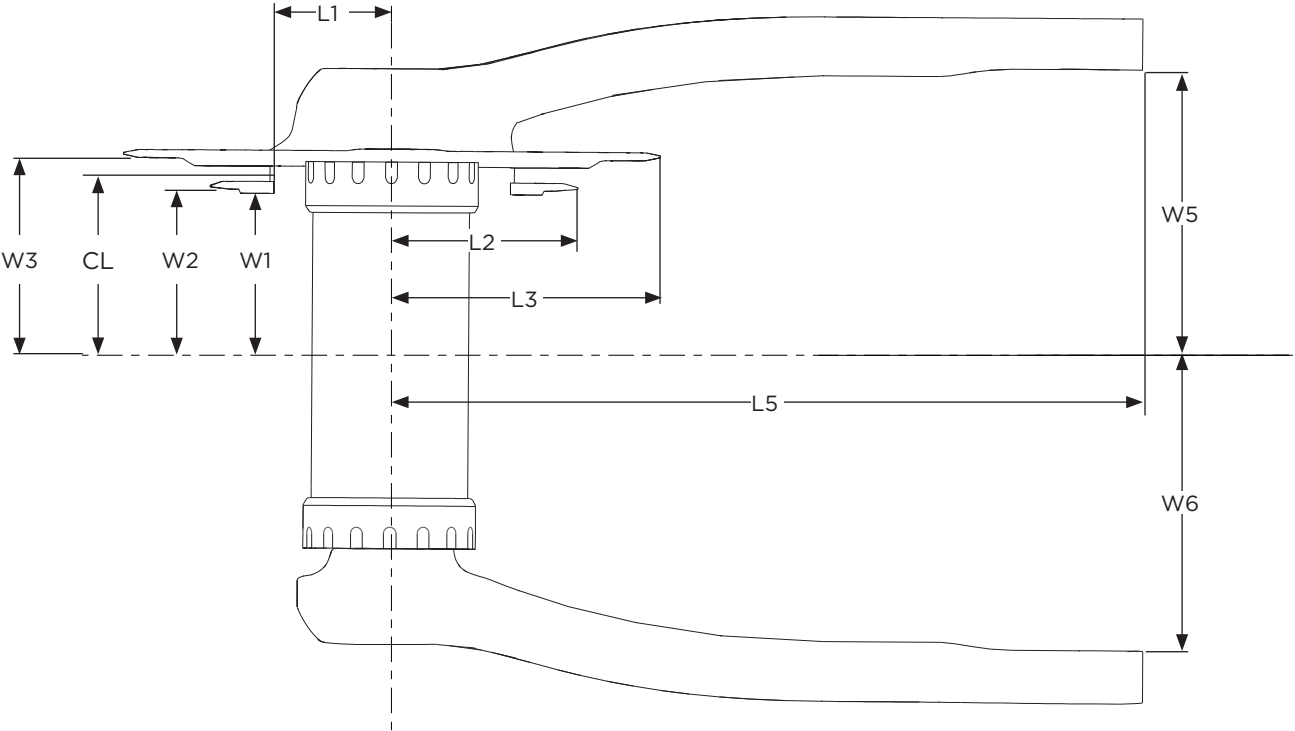

2x10 Cranksets

Crankset Frame Clearance Information									
Chainring	L1 (mm)	L2 (mm)	L3 (mm)	L5 (mm)	W1 (mm)	W2 (mm)	W5 (mm)	W6 (mm)	CL (mm)
39/26	31	55	81	190	43.5	44.5	65.7 (Q156)	65.7 (Q156)	49.5
42/28		60	87				69.5 (Q164)	69.5 (Q164)	
2x10	Q-factor : 156, 164								
	Bottom Bracket Type(s): GXP® : BB30™ : PF30™ : PFGXP™								

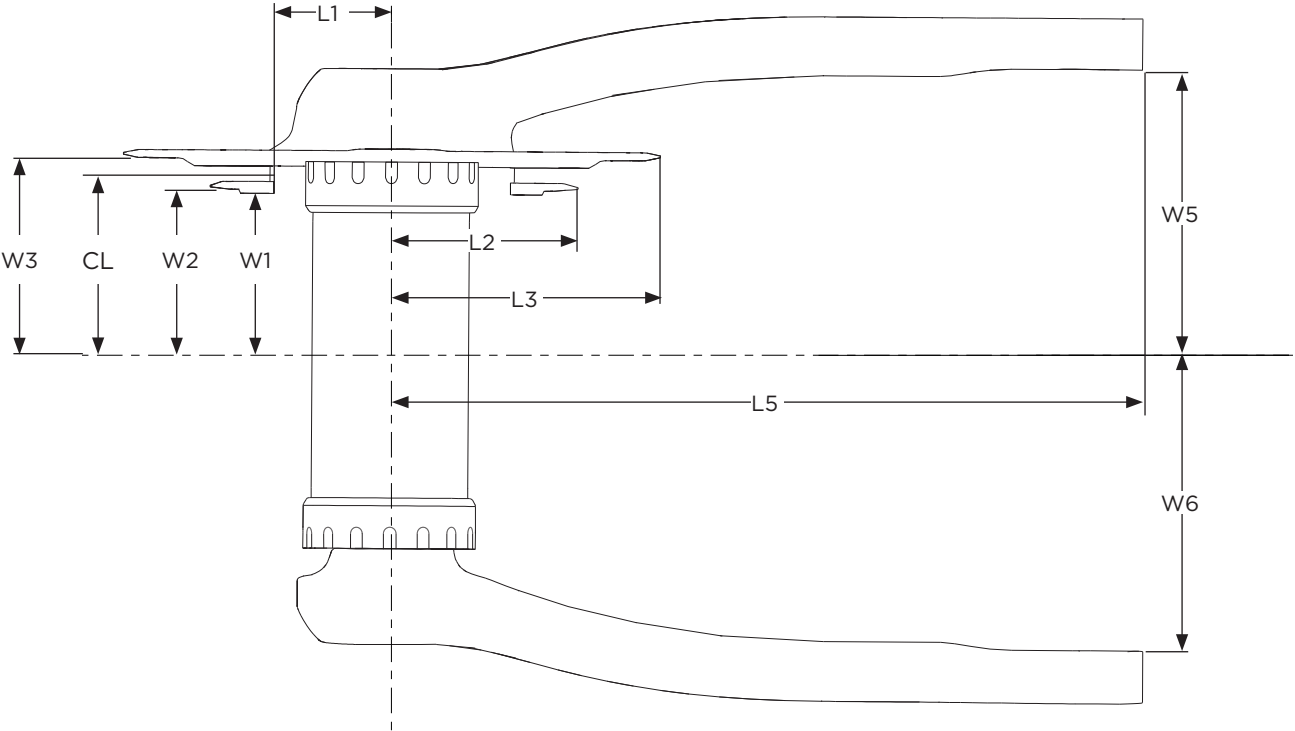

Crankset Frame Clearance Information													
Chainring	L1 (mm)	L2 (mm)	L3 (mm)	L4 (mm)	L5 (mm)	W1 (mm)	W2 (mm)	W3 (mm)	W4 (mm)	W5 (mm)	W6 (mm)	CL (mm)	
2x10	34/22	25	47.8	70.6	73	192 mm	43	44	52	57.8	72	70.5	49
	36/22		46.7	74.4	78								
	38/24	24.5	50.7	78.0	82.5		43.5	44.5	52.5	-		49.5	
	39/26	31	55	81.0	-								
Q-factor : 168													
Bottom Bracket Type : GXP® : BB30™ : PF30™ : PFGXP™													

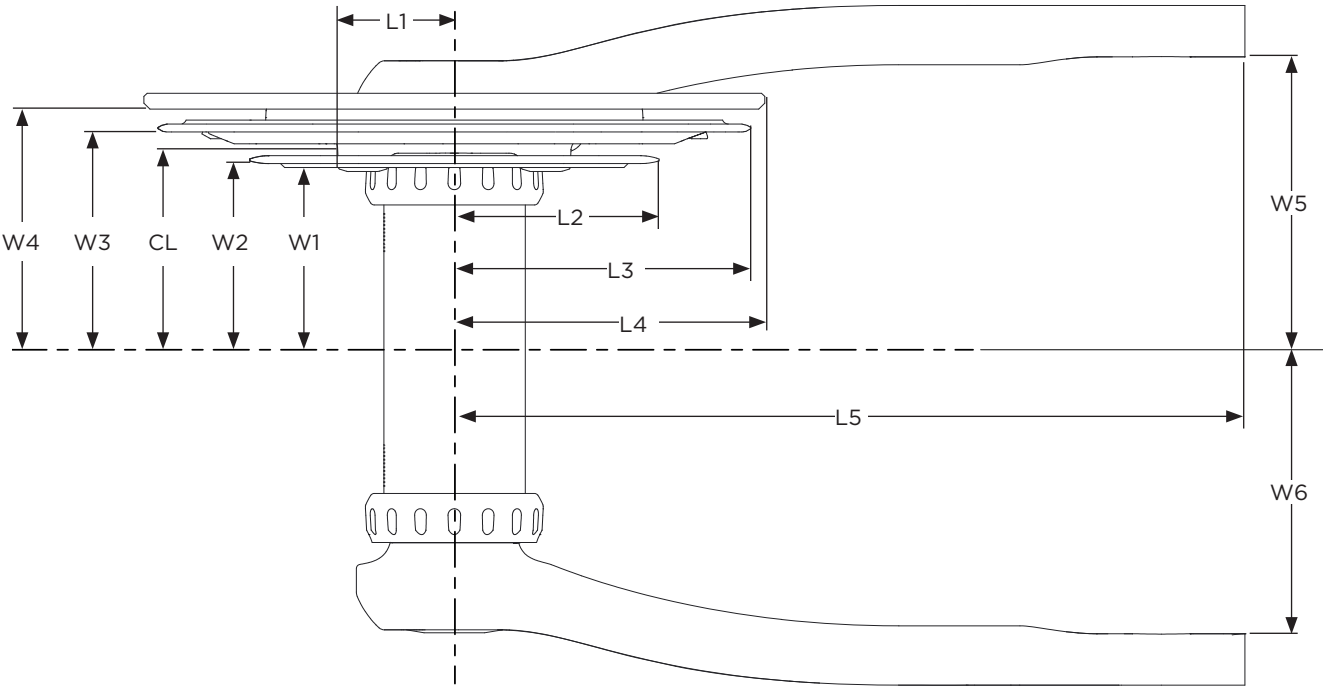

Crankset Frame Clearance Information												
Chainring	L1 (mm)	L2 (mm)	L3 (mm)	L4 (mm)	L5 (mm)	W1 (mm)	W2 (mm)	W3 (mm)	W4 (mm)	W5 (mm)	W6 (mm)	CL (mm)
34/22	25	47.8	70.6	73	192 (175 crank arm)	43	44	52	57.8	72	72	49
36/22	25	46.7	74.4	78								
38/24	24.5	50.7	78	82.5		43.5	44.5	52.5	-			49.5
39/26	31	55	81	-								
42/28		60	87									
Q-factor : 171												
Bottom Bracket Type(s) : GXP® : BB30™ : PressFit 30™ : PressFit™ GXP MTB												

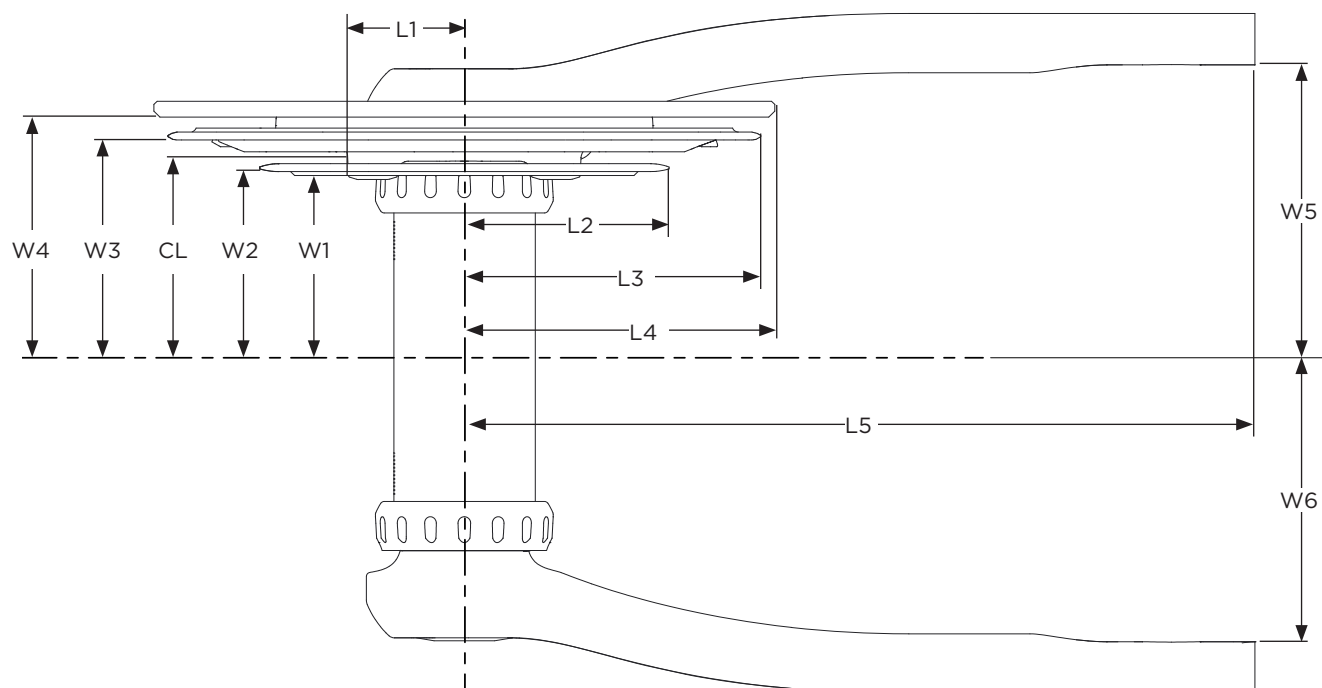

X9 - Fat bike

Crankset Frame Clearance Information										
Chainring	L1 (mm)	L2 (mm)	L3 (mm)	L5 (mm)	W1 (mm)	W2 (mm)	W3 (mm)	W5 (mm)	W6 (mm)	CL (mm)
34/22	25	47.8	70.6	192	60.5	61.5	69.5	91.5	88	66.5
36/22		46.7	74.4							
2x10	Q-factor : 203.5									
	Bottom Bracket Type : GXP® 100 : PressFit™ 121									

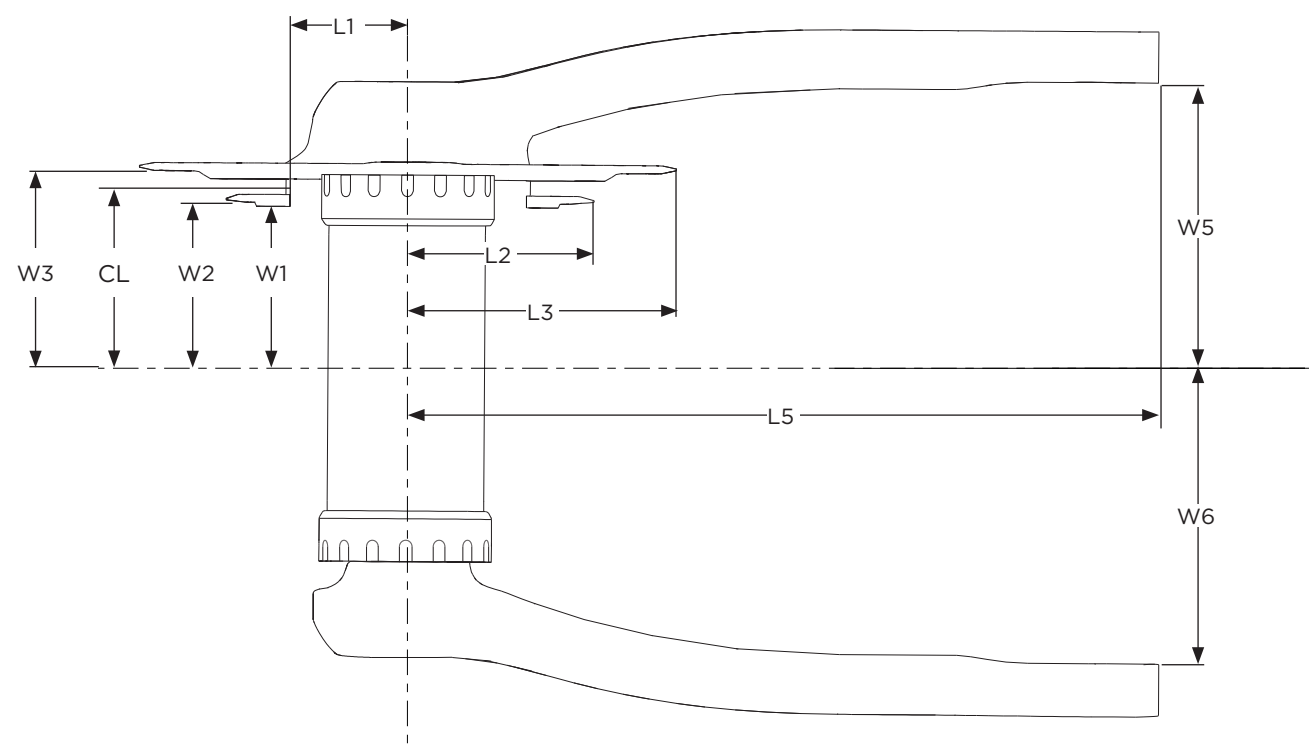

GX-1200/X7

Crankset Frame Clearance Information															
Chainring	L1 (mm)	L2 (mm)	L3 (mm)	L4 (mm)	L5 (mm)	W1 (mm)	W2 (mm)	W3 (mm)	W4 (mm)	W5 (mm)	W6 (mm)	CL (mm)			
34/22	25	47.8	70.6	73	192	43	44	52	57.8	72	70.5	49			
36/22		46.7	74.4	78											
38/24	24.5	50.7	78	82.5		43.5	44.5	52.5	-			49.5			
39/26	31	55	81	-											
42/28		60	87												
Q-factor : 167.5															
Bottom Bracket Type(s) : GXP® : BB30™ : PF30™ : PFGXP™															

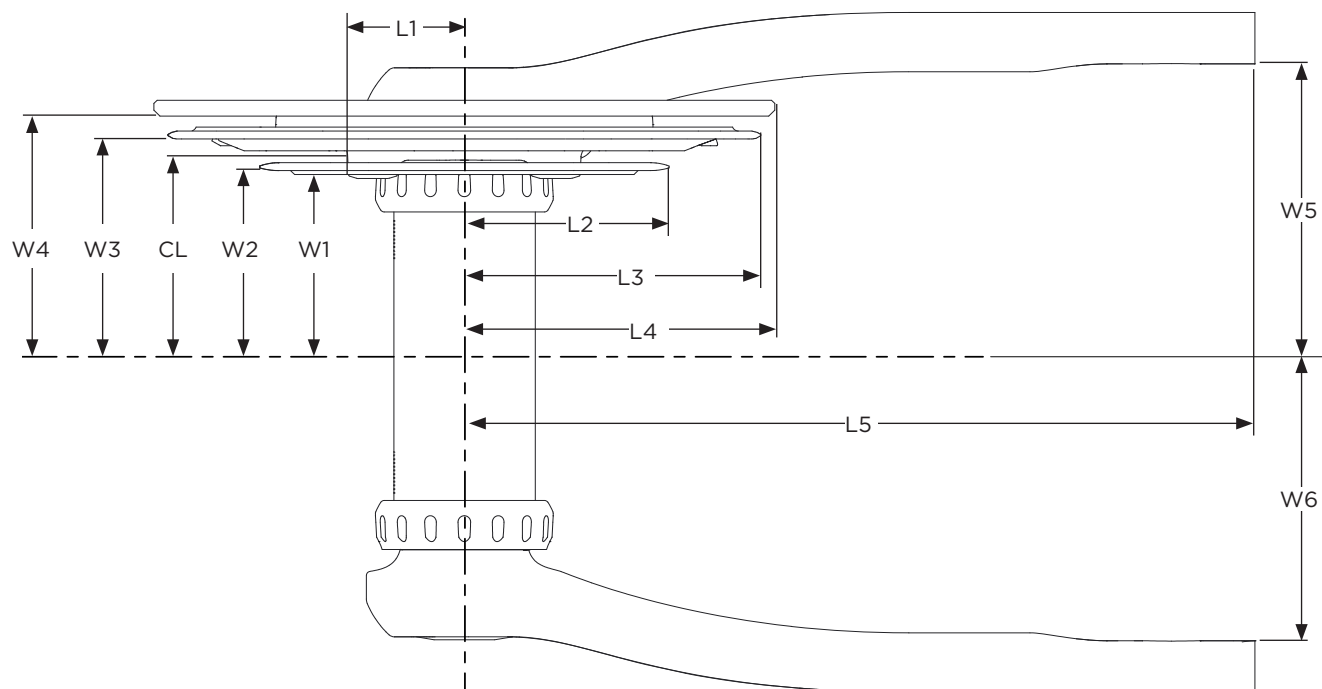

GX-1000/X5

Crankset Frame Clearance Information												
Chainring	L1 (mm)	L2 (mm)	L3 (mm)	L4 (mm)	L5 (mm)	W1 (mm)	W2 (mm)	W3 (mm)	W4 (mm)	W5 (mm)	W6 (mm)	CL (mm)
34/22	25	47.8	70.6	73	192	43	44	52	57.8	72	72	49
36/22		46.7	74.4	78								
38/24	24.5	50.7	78	82.5		43.5	44.5	52.5	-			49.5
39/26	31	55	81	-								
42/28		60	87									
Q-factor : 169												
Bottom Bracket Type(s) : GXP® : BB30™ : PF30™ : PFGXP™												

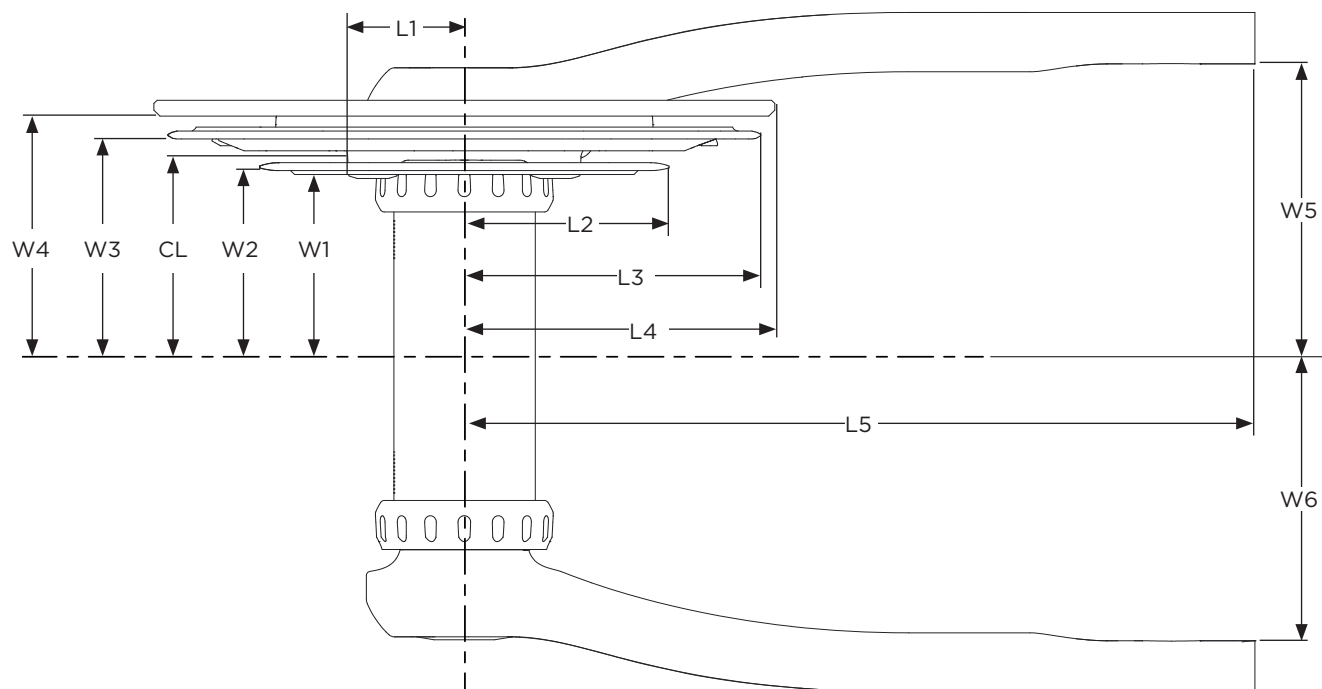

GX-1000 - Boost 148 Compatible

Crankset Frame Clearance Information											
Chainring	L1 (mm)	L2 (mm)	L3 (mm)	L5 (mm)	W1 (mm)	W2 (mm)	W3 (mm)	W5 (mm)	W6 (mm)	CL(mm)	
34/22	25	47.8	70.6	192	46	47	55	72	72	52	
36/22		46.7	74.4								
38/24	24.5	50.7	78								
Q-factor : 169											
Bottom Bracket Type(s) : GXP® : BB30™ : PF30™ : PFGXP™											

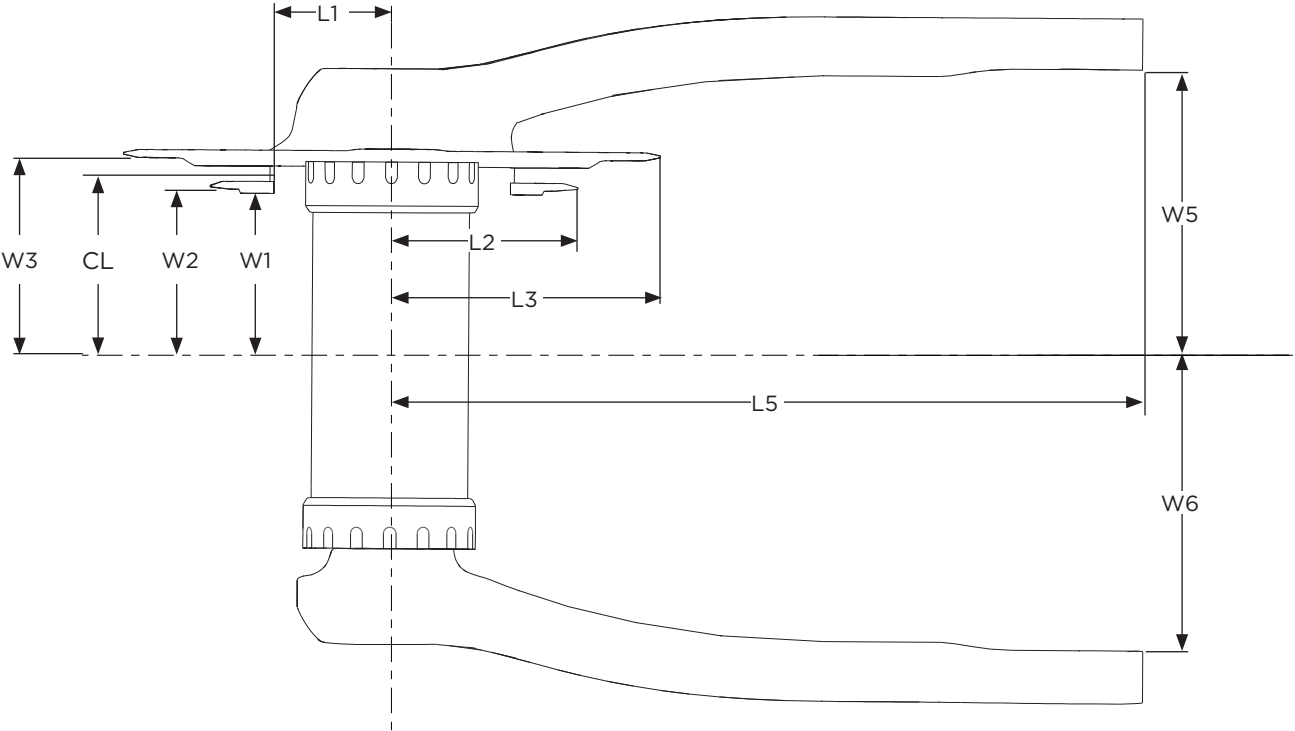

GX-1000/X5 - Fat bike

Crankset Frame Clearance Information										
Chainring	L1 (mm)	L2 (mm)	L3 (mm)	L5 (mm)	W1 (mm)	W2 (mm)	W3 (mm)	W5 (mm)	W6 (mm)	CL (mm)
34/22	25	47.8	70.6	192	60.5	61.5	69.5	89.5	88	66.5
36/22		46.7	74.4							
2x10	Q-factor : 202.5									
	Bottom Bracket Type : GXP® 100 : PressFit™ 121									

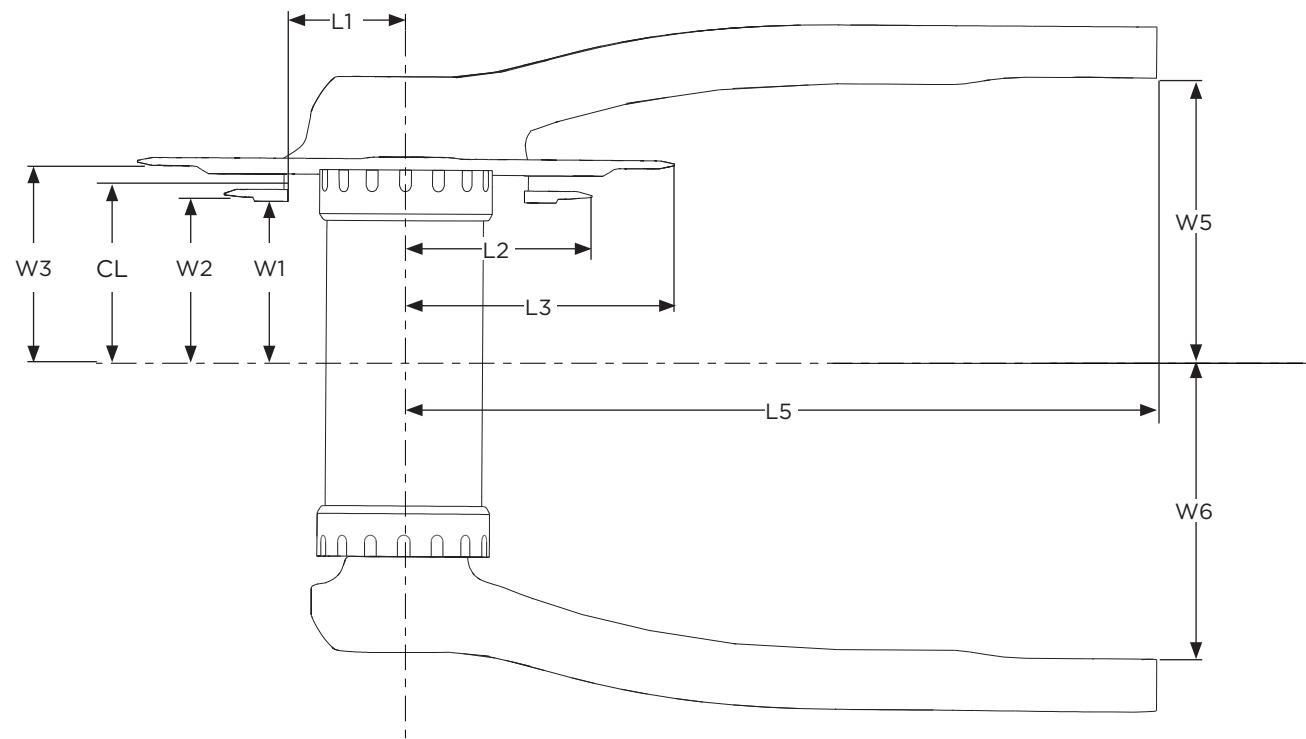

3x10 Cranksets

Crankset Frame Clearance Information													
Chainring	L1 (mm)	L2 (mm)	L3 (mm)	L4 (mm)	L5 (mm)	W1 (mm)	W2 (mm)	W3 (mm)	W4 (mm)	W5 (mm)	W6 (mm)	CL (mm)	
3x10	44/33/22	25	47	69	91	192	41	42	50	57	72	70.5	51
	Q-factor : 167.5												
	Bottom Bracket Type(s): GXP® : BB30™ : PF30™ : PFGXP™												

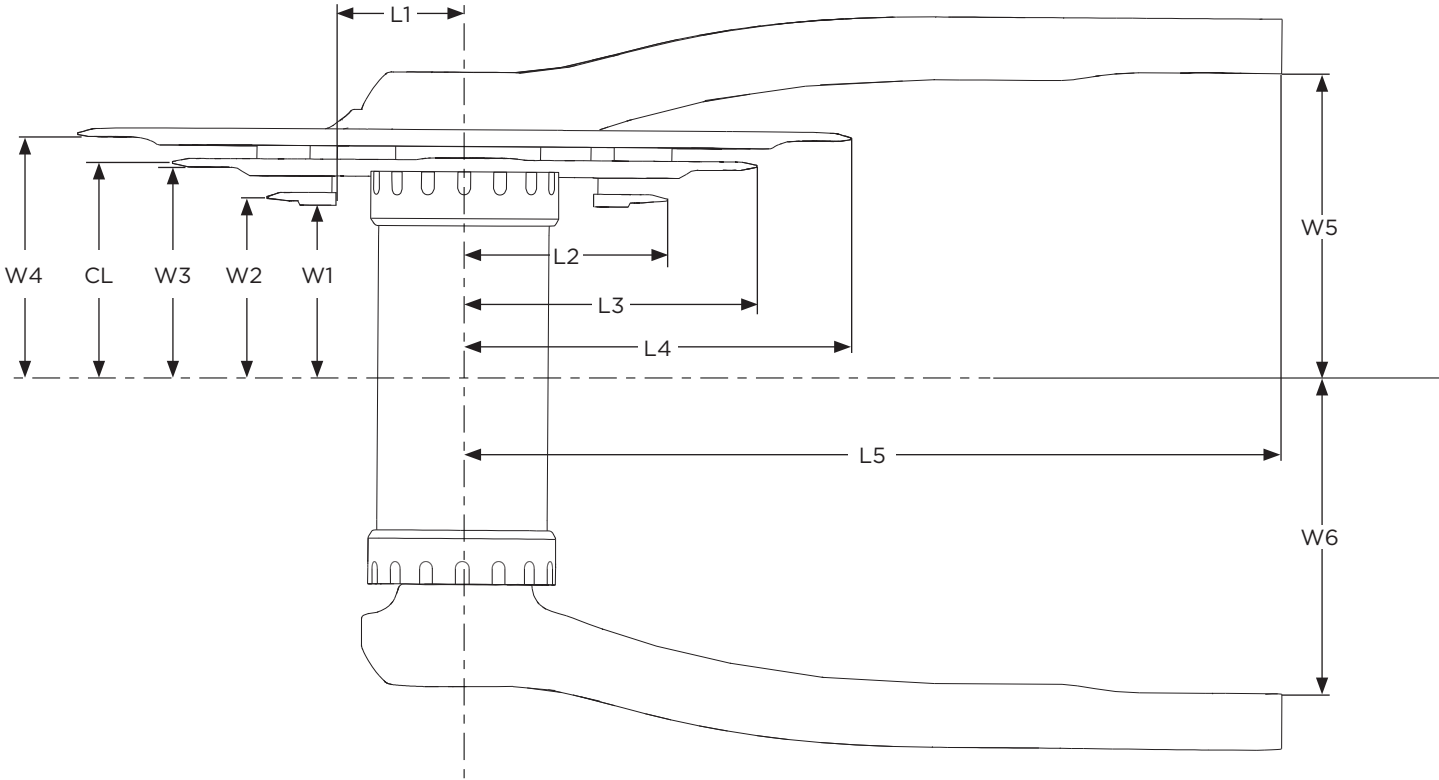

Crankset Frame Clearance Information													
Chainring	L1 (mm)	L2 (mm)	L3 (mm)	L4 (mm)	L5 (mm)	W1 (mm)	W2 (mm)	W3 (mm)	W4 (mm)	W5 (mm)	W6 (mm)	CL (mm)	
44/33/22	25	47	69	91	192 (175 mm crank arm)	41	42	50	57	72	72	51	
													Q-factor : 171
Bottom Bracket Type(s): GXP® : BB30™ : PF30™ : PFGXP™													

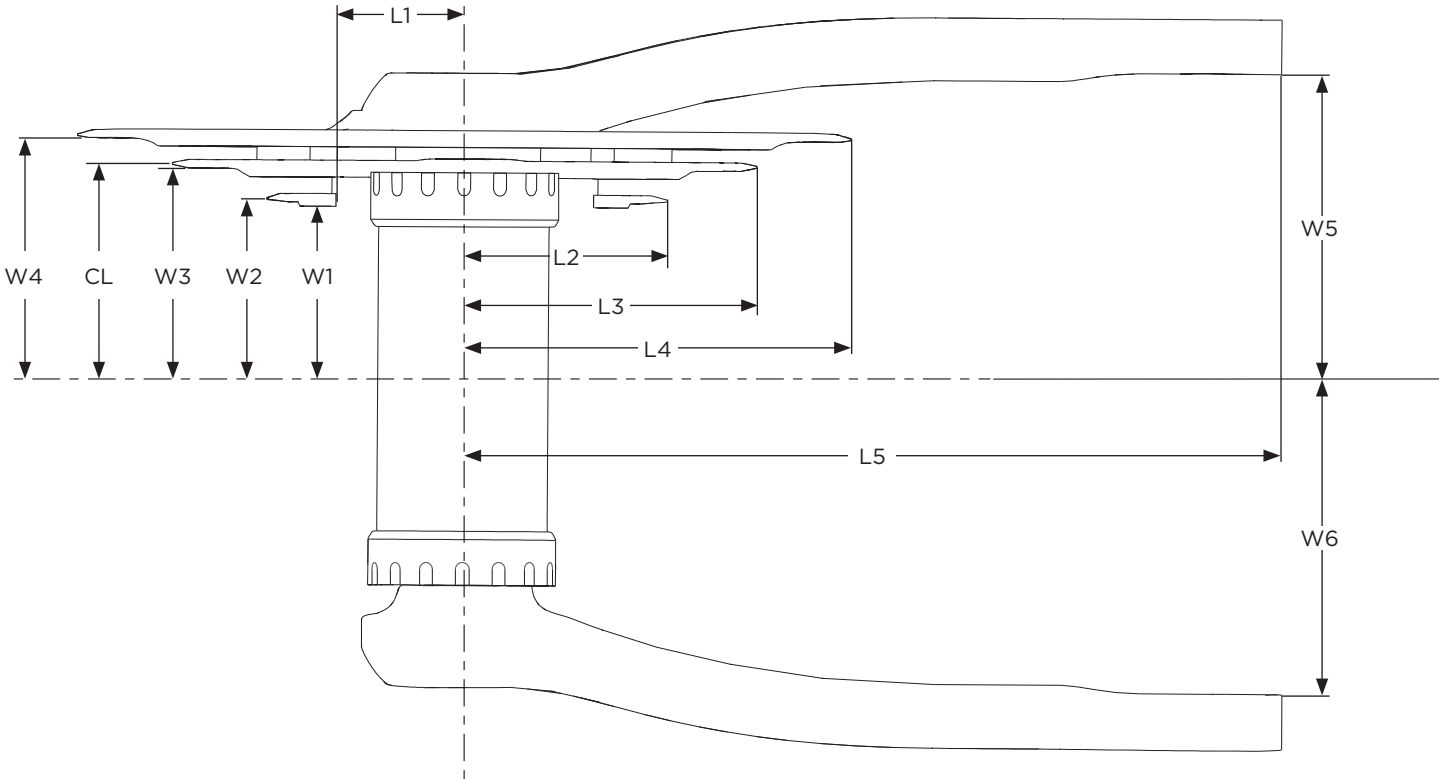

Crankset Frame Clearance Information													
Chainring	L1 (mm)	L2 (mm)	L3 (mm)	L4 (mm)	L5 (mm)	W1 (mm)	W2 (mm)	W3 (mm)	W4 (mm)	W5 (mm)	W6 (mm)	CL (mm)	
44/33/22	25	47	69	91	191 (175 mm crank arm)	41	42	50	57	70.5	70.5	51	
													Q-factor : 167.5
Bottom Bracket Type(s): GXP® : BB30™ : PF30™ : PFGXP™													

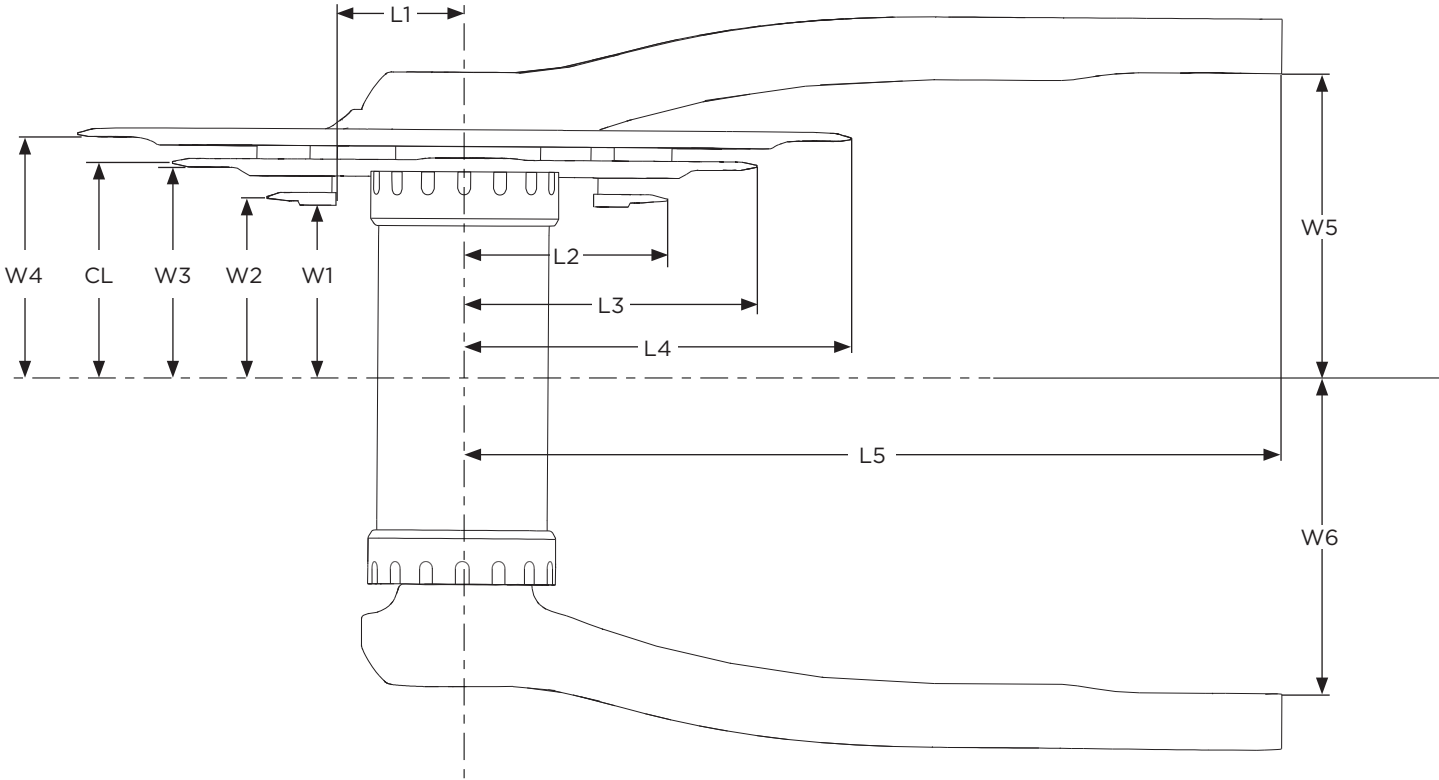

Crankset Frame Clearance Information													
Chainring	L1 (mm)	L2 (mm)	L3 (mm)	L4 (mm)	L5 (mm)	W1 (mm)	W2 (mm)	W3 (mm)	W4 (mm)	W5 (mm)	W6 (mm)	CL (mm)	
44/33/22	25	47	69	91	191 (175 mm crank arm)	41	42	50	57	72	72	51	
													Q-factor : 169
Bottom Bracket Type(s): GXP® : BB30™ : PF30™ : PFGXP™													

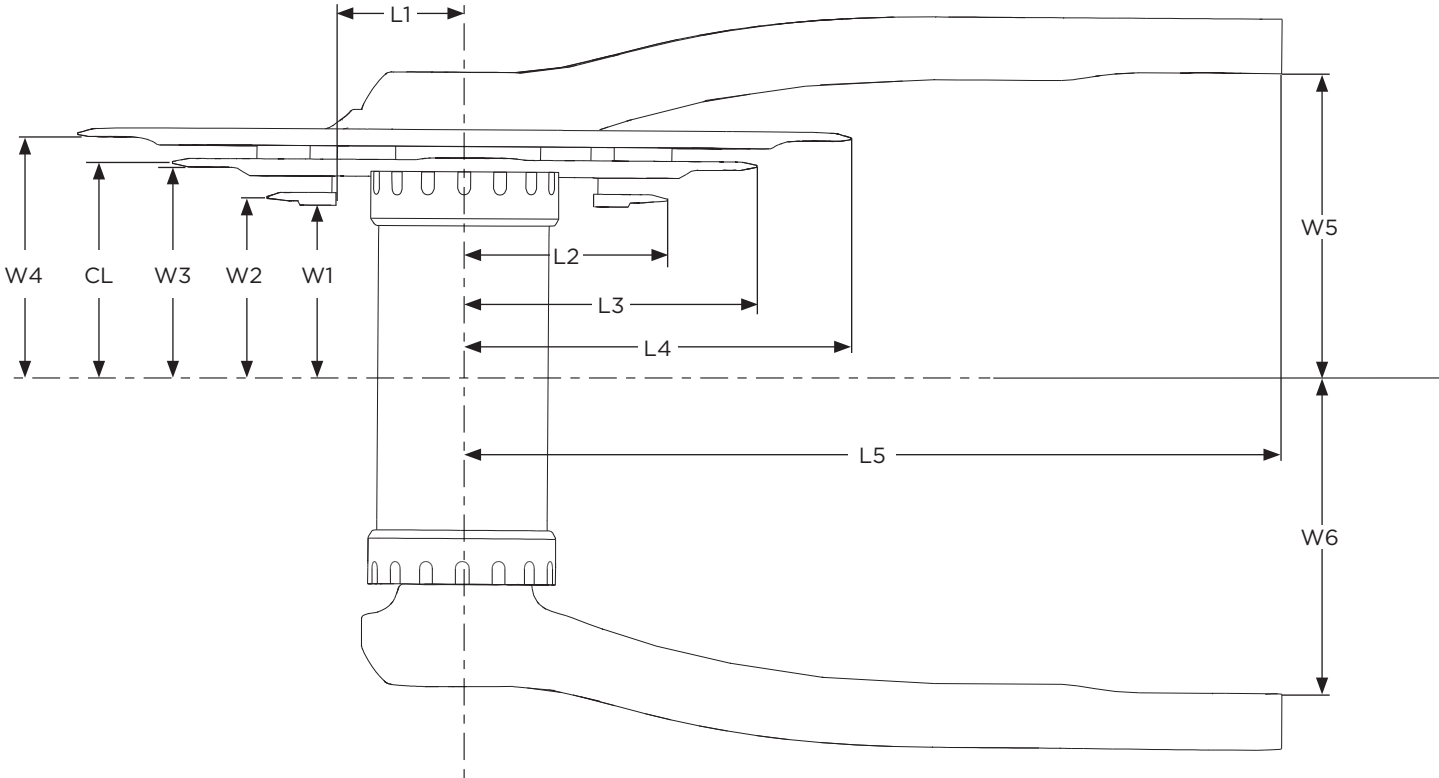

Bottom Brackets

PressFit 30™

SRAM® PressFit 30™ (PF30) bottom brackets have been designed and tested to work within the bounds of the dimensions and tolerances in the shell specifications and bottom bracket specifications. Materials, manufacturing methods, and frame shell designs can potentially influence the performance of the bottom bracket, even when the shell is manufactured to these specifications. In these instances, it is recommended that bicycle manufacturers confirm the bottom bracket system performance with individual frame configurations.

Things that should be considered when evaluating the frame and bottom bracket interaction include, but are not limited to:

- Loosening of the adapter cups from the bottom bracket shell (frame material choice can greatly affect friction coefficient).
- Binding of bearings within the bottom bracket.

For more information regarding PF30 bottom bracket technical information, contact your SRAM representative.

PressFit 30 MTB BB Shell Specification

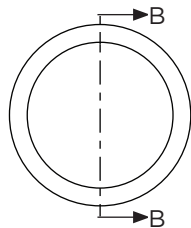

	Dim W 4	Dim DS	Dim NDS
PF30 73	73	36.5	
PF30 83	83	41.5	

Notes

1. Dimensions apply after finishing.
2. Only dimensions essential to bottom bracket PressFit and function are shown. All other details are left to the discretion of the frame or component designer. Dimensions shown do not take the place of proper frame, bottom bracket shell, or crankset design.

3. PressFit surfaces should be unpainted.
4. Recommended 73 mm or 83 mm for MTB applications.

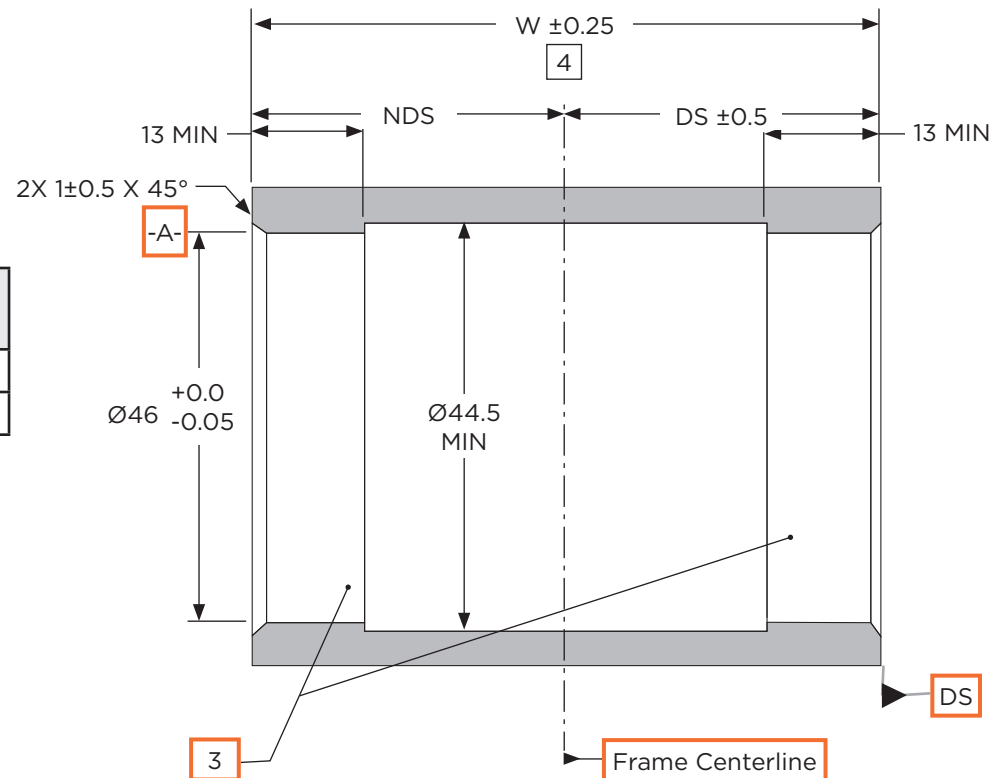

PressFit 30™ continued

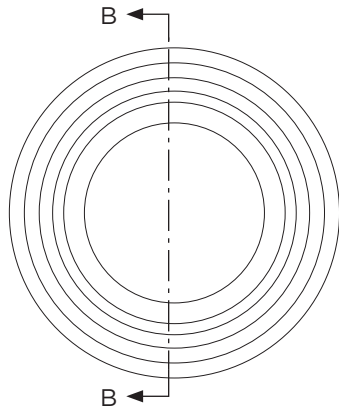

	Dim W 3	Dim DS	Dim NDS
PF30 73	73	36.5	
PF30 83	83	41.5	

Notes

1. Dimensions apply after finishing.
2. Only dimensions essential to bottom bracket PressFit and function are shown. All other details are left to the discretion of the frame or crankset designer. Dimensions shown do not take the place of proper frame, bottom bracket shell, or crankset design.
3. Recommended 73 mm or 83 mm for MTB applications.
4. Ensure that the bottom bracket cups are completely pressed into the frame shell. There should be no gap between the flange and the bottom bracket shell.

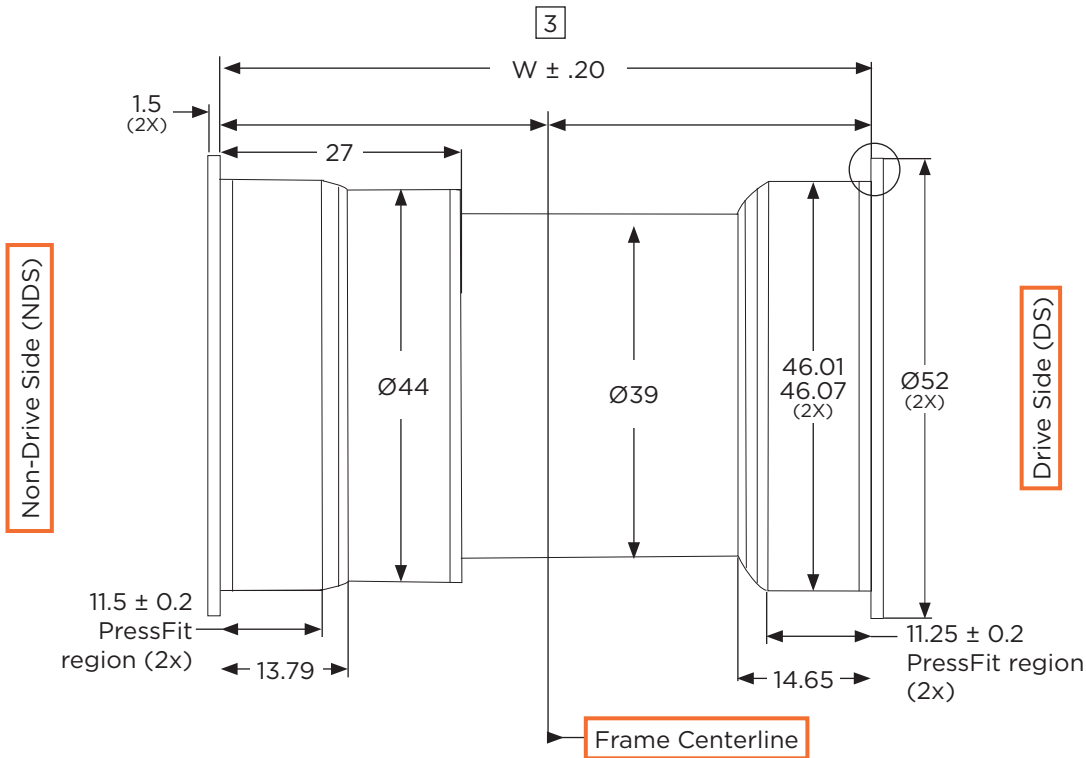

PressFit™ 89.5 & 92 GXP®

PressFit 89.5 & 92 GXP MTB BB Shell Specification

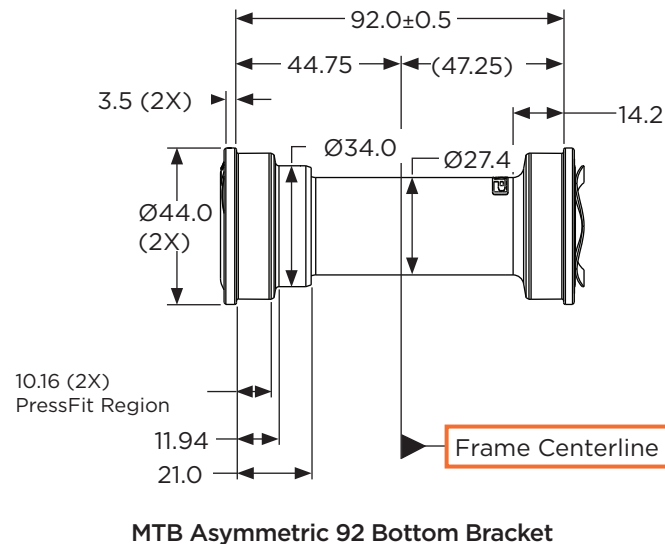
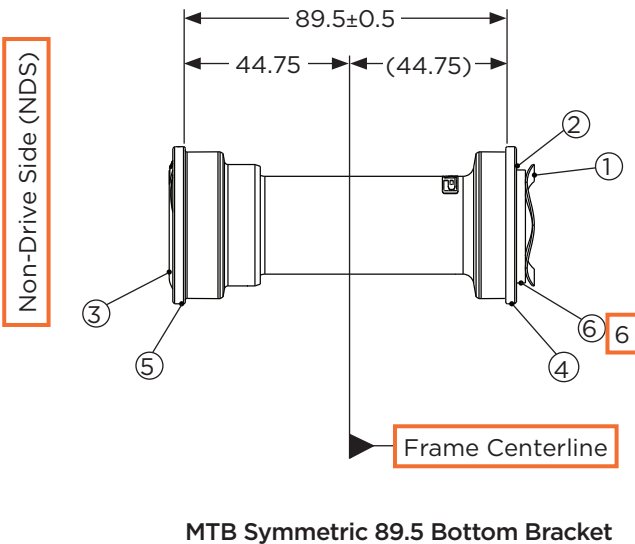
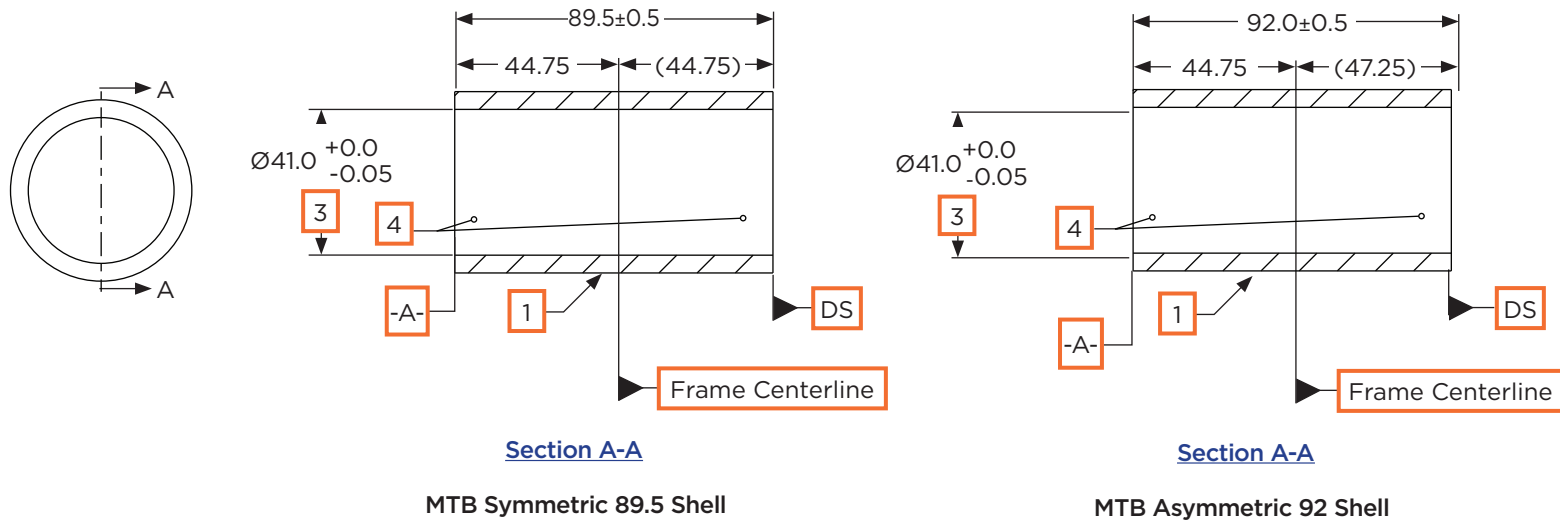

PressFit GXP MTB BB-Key Dimensions

ITEM NO.	DESCRIPTION
1	WAVE WASHER
2	DS SHIELD
3	NDS SHIELD
4	DS CUP
5	NDS CUP
6	DS SHIM WASHER 2.5 MM
7	DS SHIM WASHER 4.5 MM
8	DS SHIM WASHER 0.5 MM

NOTES:

- PressFit GXP MTB bottom bracket is only compatible with the shown bottom bracket shell specifications.
- Only dimensions essential to bottom bracket press fit and function are shown. Dimensions apply after finish.
- Tolerance applies to depth of 12.00 mm from surface -A- each side.
- Press fit surfaces should be unpainted.
- E-type front derailleurs or captured chainguide mounts cannot be used on carbon fiber frames.
- DS shim washer to be used only on MTB symmetric shell.

PressFit™ 104.5 & 107 GXP®

PressFit 104.5 & 107 GXP MTB BB Shell Specification

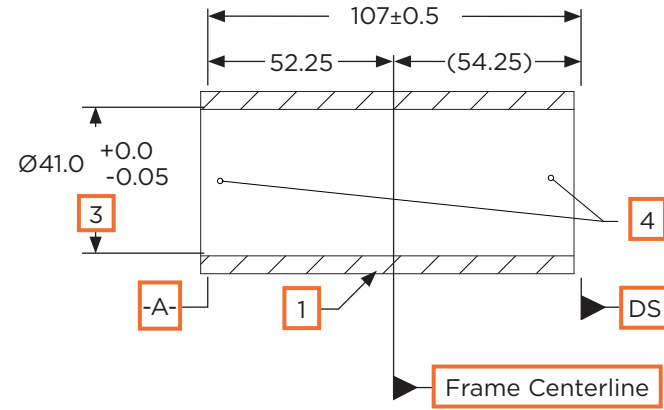
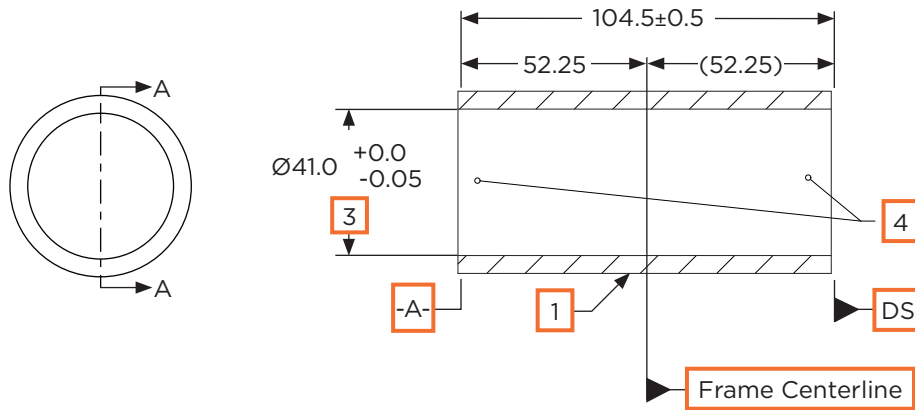

PressFit GXP MTB BB - Key Dimensions

ITEM NO.	DESCRIPTION
1	WAVE WASHER
2	DS SHIELD
3	NDS SHIELD
4	DS CUP
5	NDS CUP
6	DS SHIM WASHER 0.5 MM

Non-Drive Side (NDS)

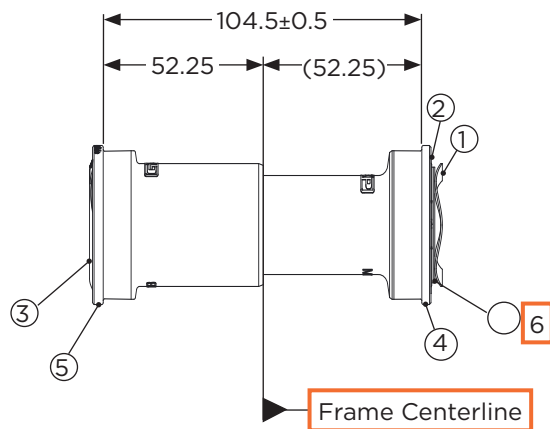

Drive Side (DS)

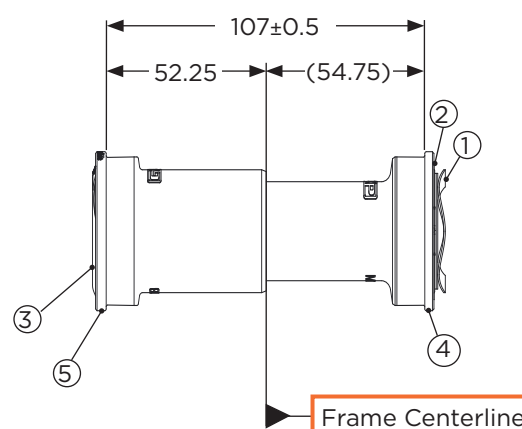

NOTES:

- PressFit GXP MTB bottom bracket is only compatible with the shown bottom bracket shell specifications.
- Only dimensions essential to bottom bracket press fit and function are shown. Dimensions apply after finish.
- Tolerance applies to depth of 12.00 mm from surface A each side.
- Press fit surfaces should be unpainted.
- E-type front derailleurs or captured chainguide mounts cannot be used on carbon fiber frames.
- DS shim washer to be used only on MTB symmetric shell, quantity 2.

Wheels

ROAM 30 & 40 Hub Boost 148 Compatible

Hub Specifications				
F (mm)	G (mm)	H (mm)	I (mm)	J (mm)
19	148	12	19	44.1

12x148 Hub

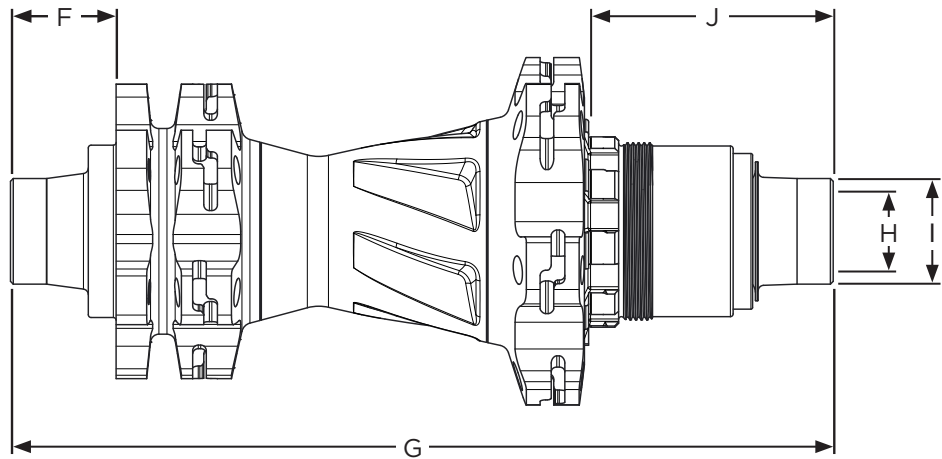

Maxle™ Boost 148 Compatible

Maxle Specifications*			
Axle Length	Thread Length	Thread Pitch	Axle Diameter
A (mm)	B (mm)	C	D (mm)
182	20	M12 x 1.75	12
188	20	M12 x 1.75	12
196	20	M12 x 1.75	12

* The dimensions shown are suggestions. Visit SRAM Connect for more options.

