

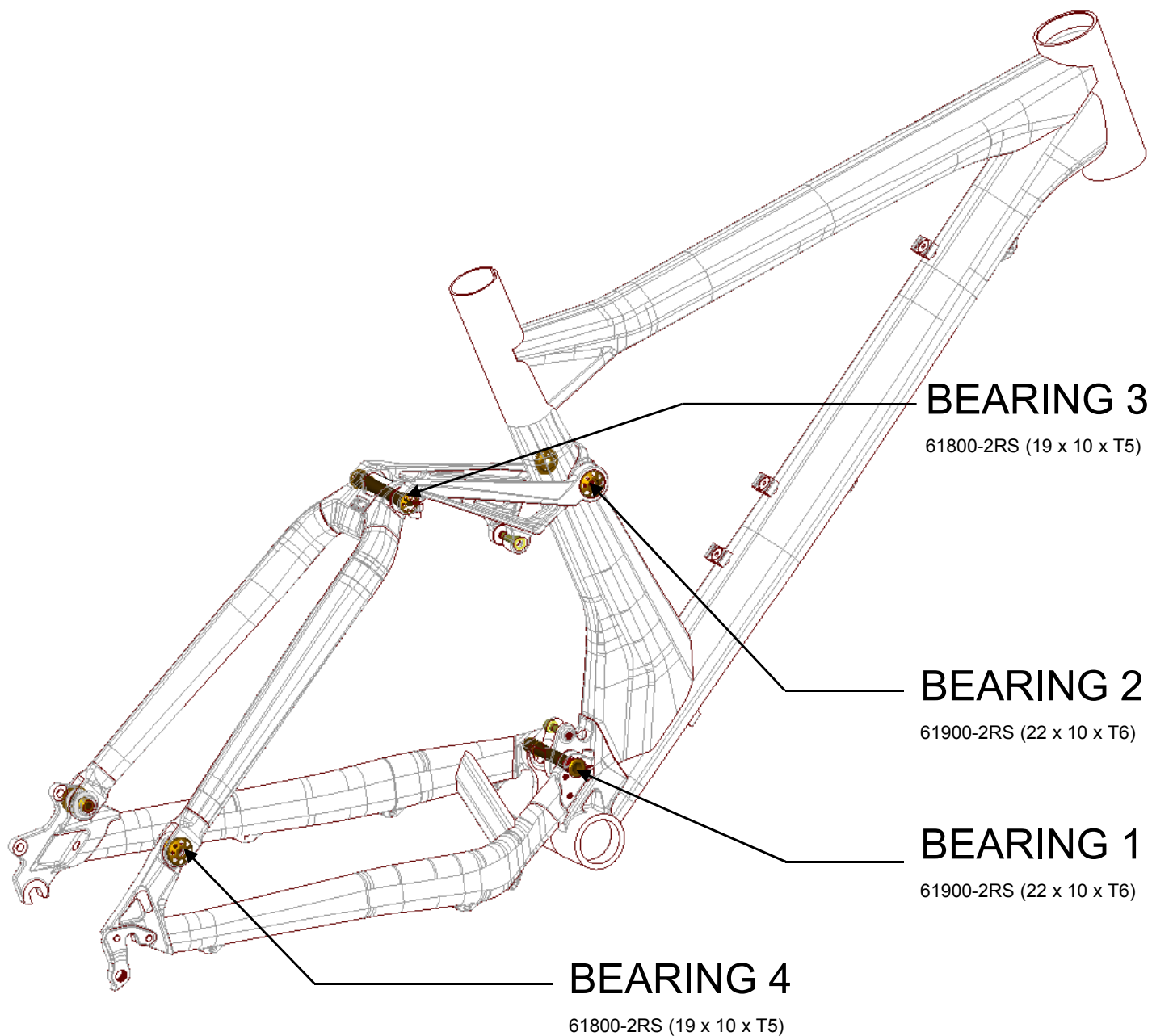

PART NAME	QTY.	PICTURE
S1	1	
S2	1	
S3	1	
S6	1	
S7	1	
S8	1	
S9	1	
S11	1	
M8 washer	1	
M8 nut	1	
Circlips pliers	1	





### BEARING 1 / TAKE-OFF

#### 1) TAKE-OFF HARDWARE

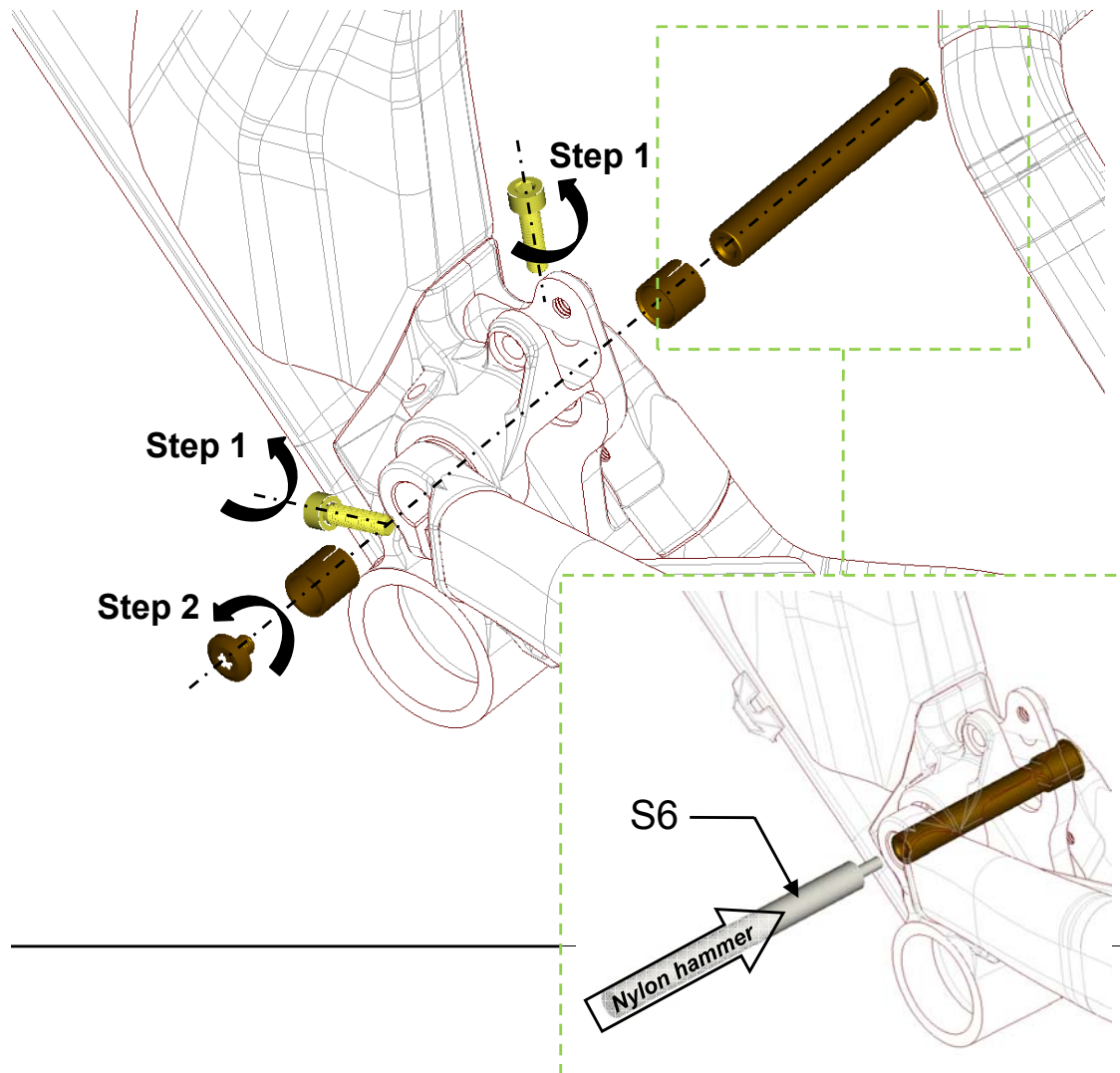

#### 2) TAKE-OFF BEARINGS

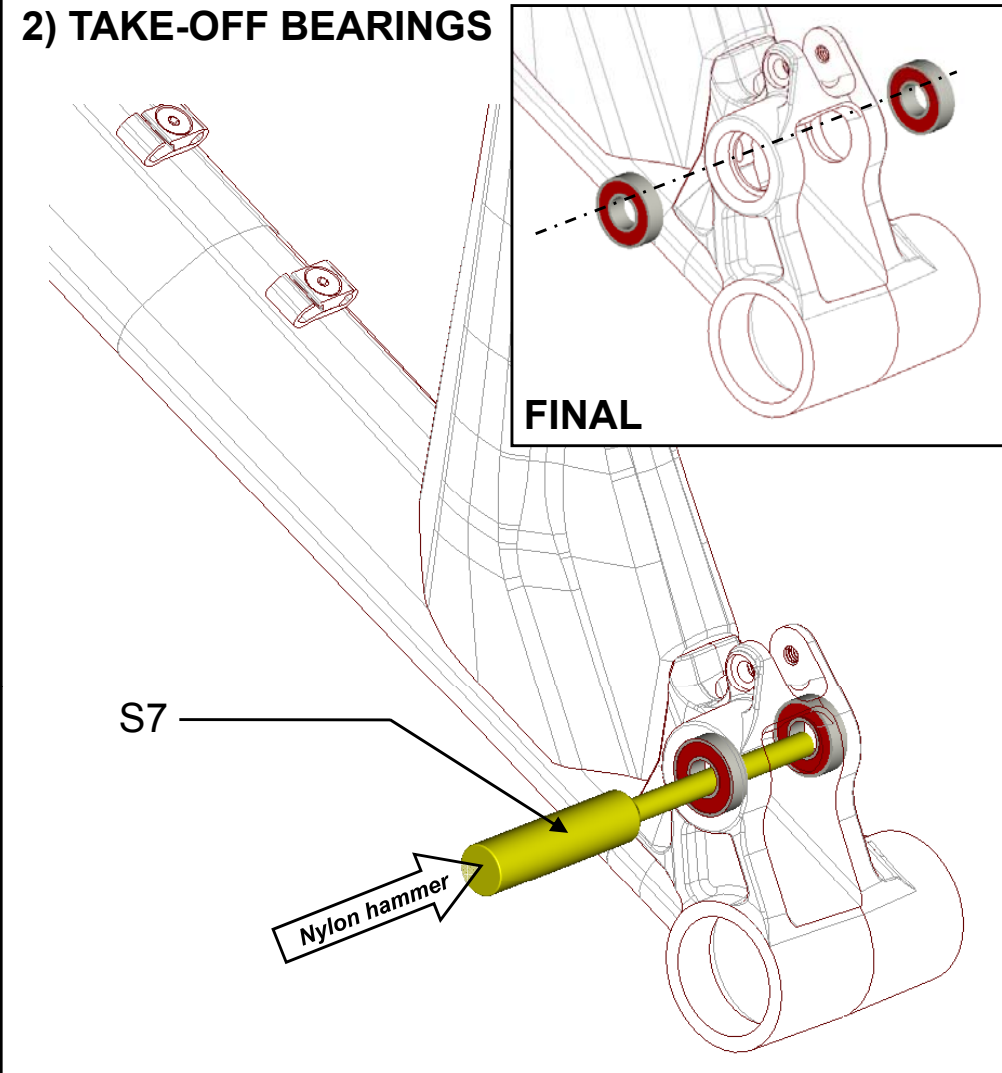



### BEARING 1 / MOUNT

#### 1) MOUNT BEARINGS

(Bearing 61900)

S8

S1

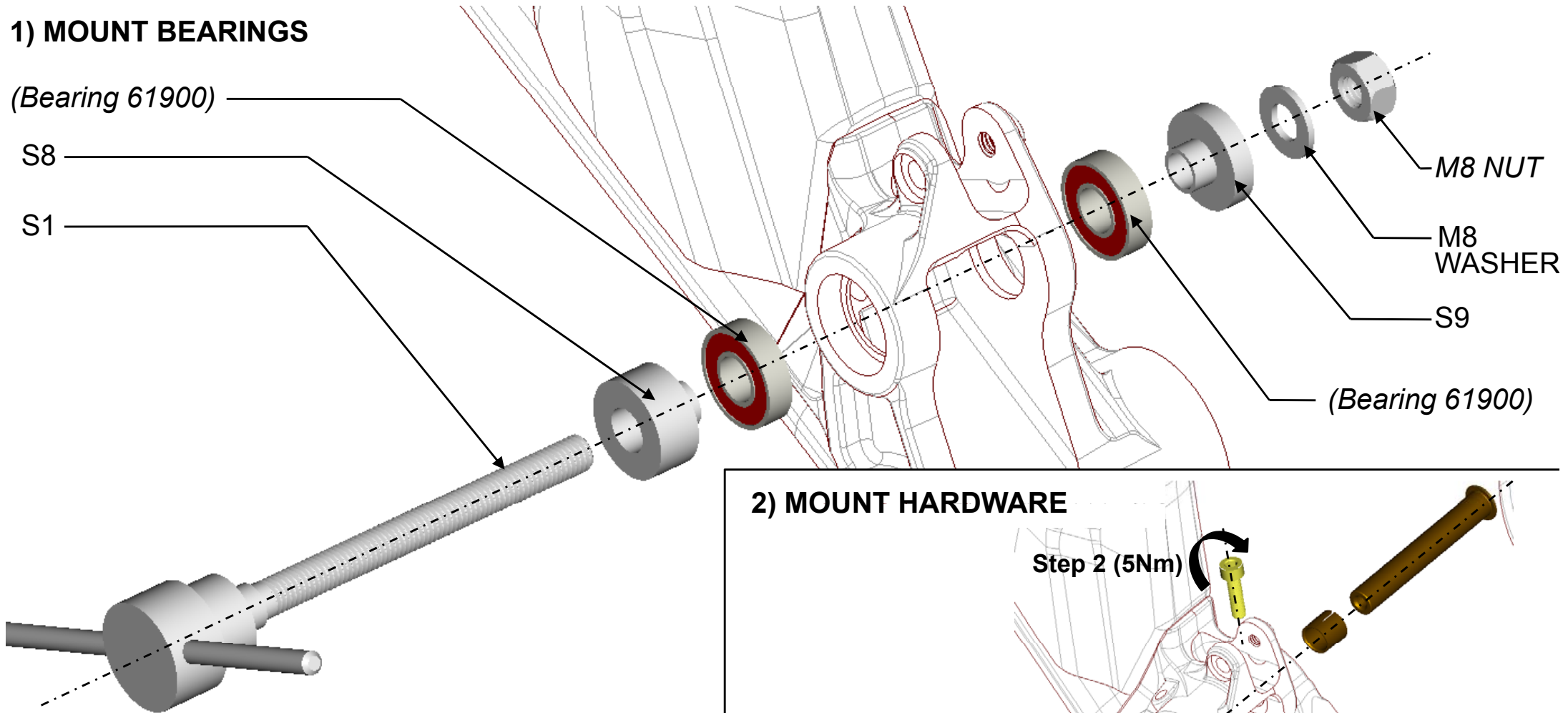

#### 2) MOUNT HARDWARE

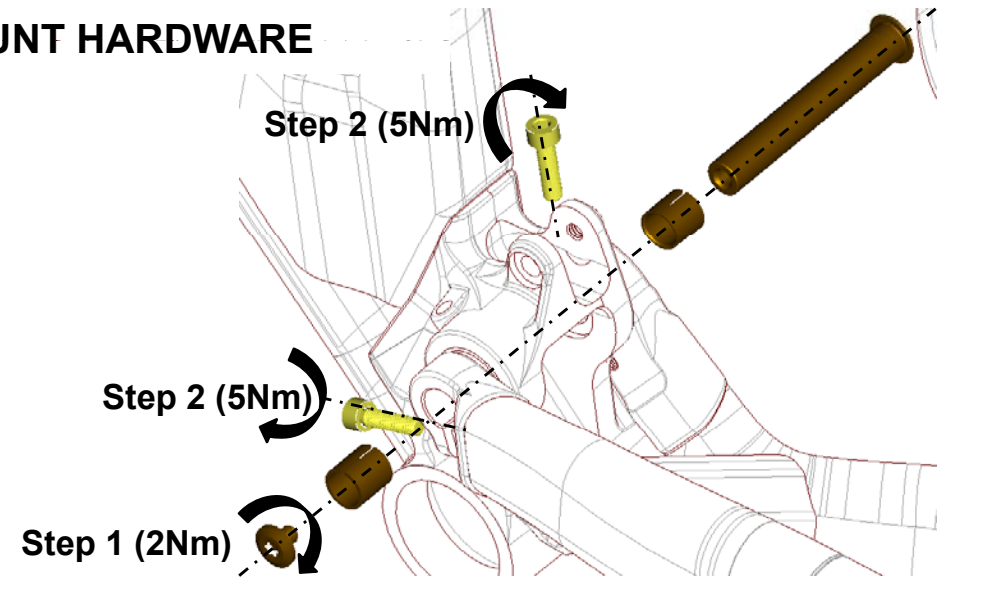



### BEARING 2 / TAKE-OFF

#### 1) TAKE-OFF HARDWARE

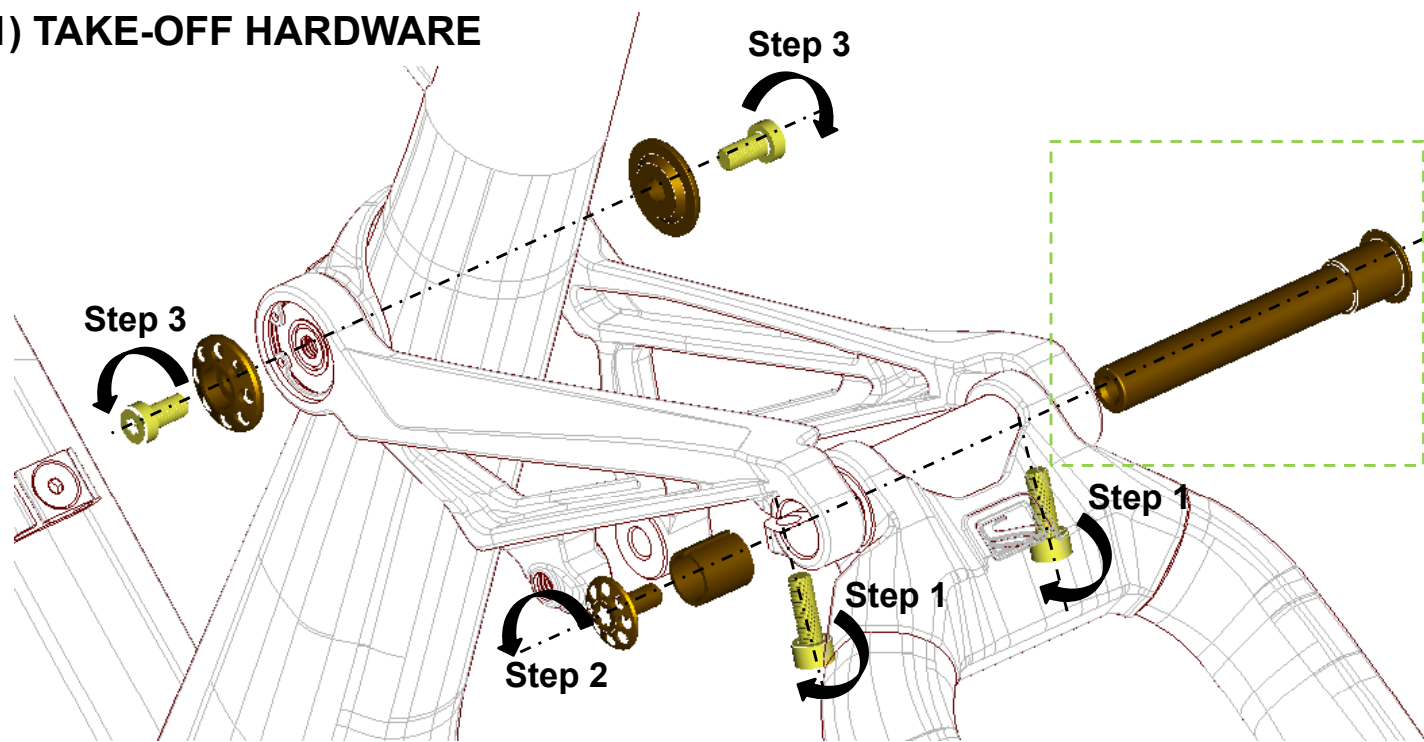

#### 2) TAKE-OFF CIRCLIPS

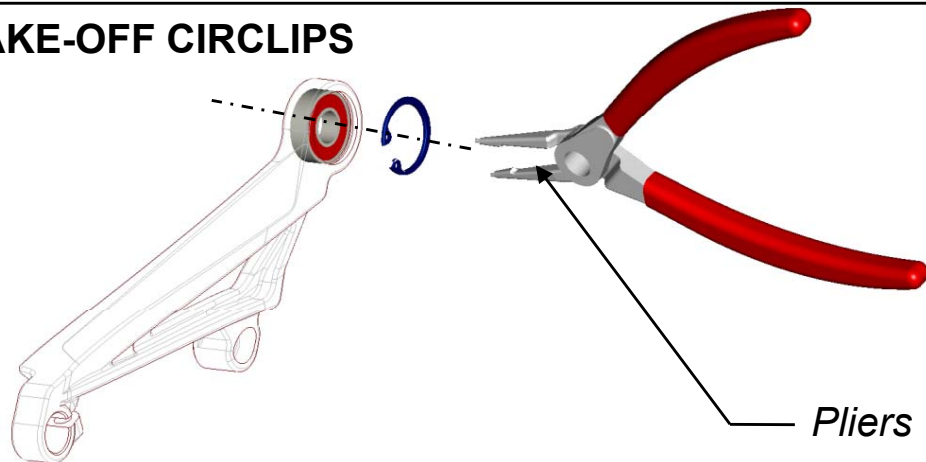

#### 3) TAKE-OFF BEARING

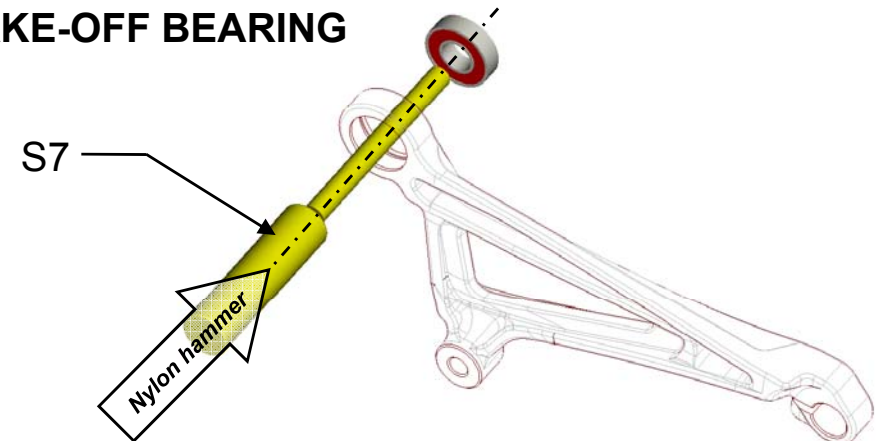



### BEARING 2 / MOUNT

#### 1) MOUNT BEARINGS

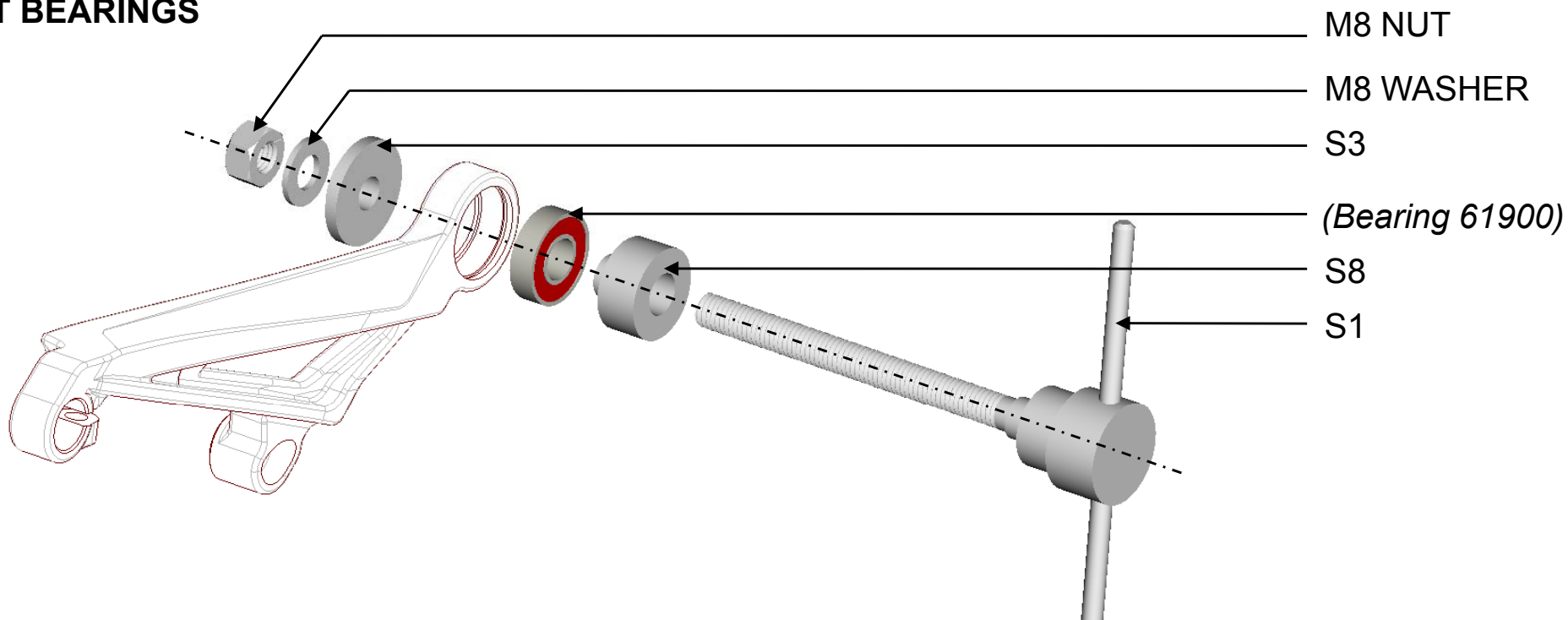

#### 2) MOUNT CIRCLIPS

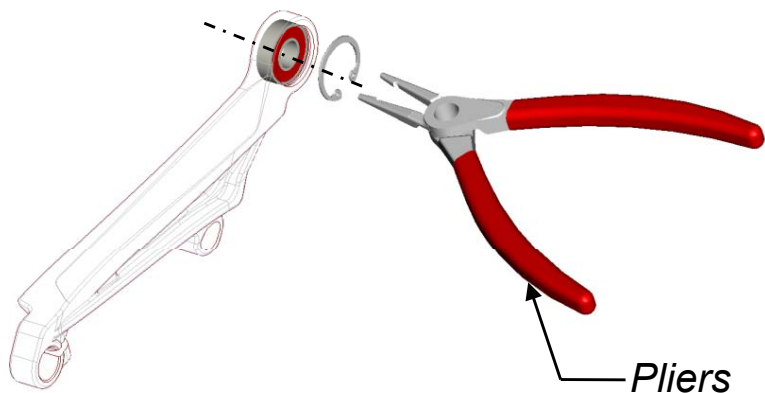

#### 3) MOUNT HARDWARE

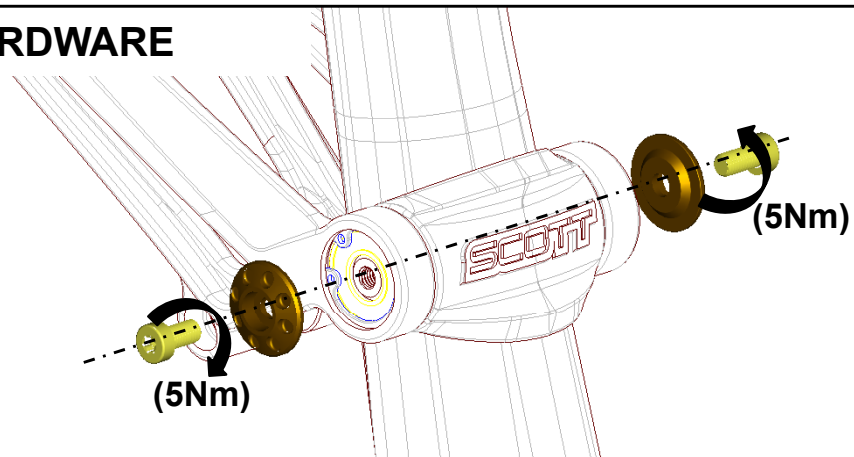





### BEARING 3 / TAKE-OFF

#### 1) TAKE-OFF BEARINGS

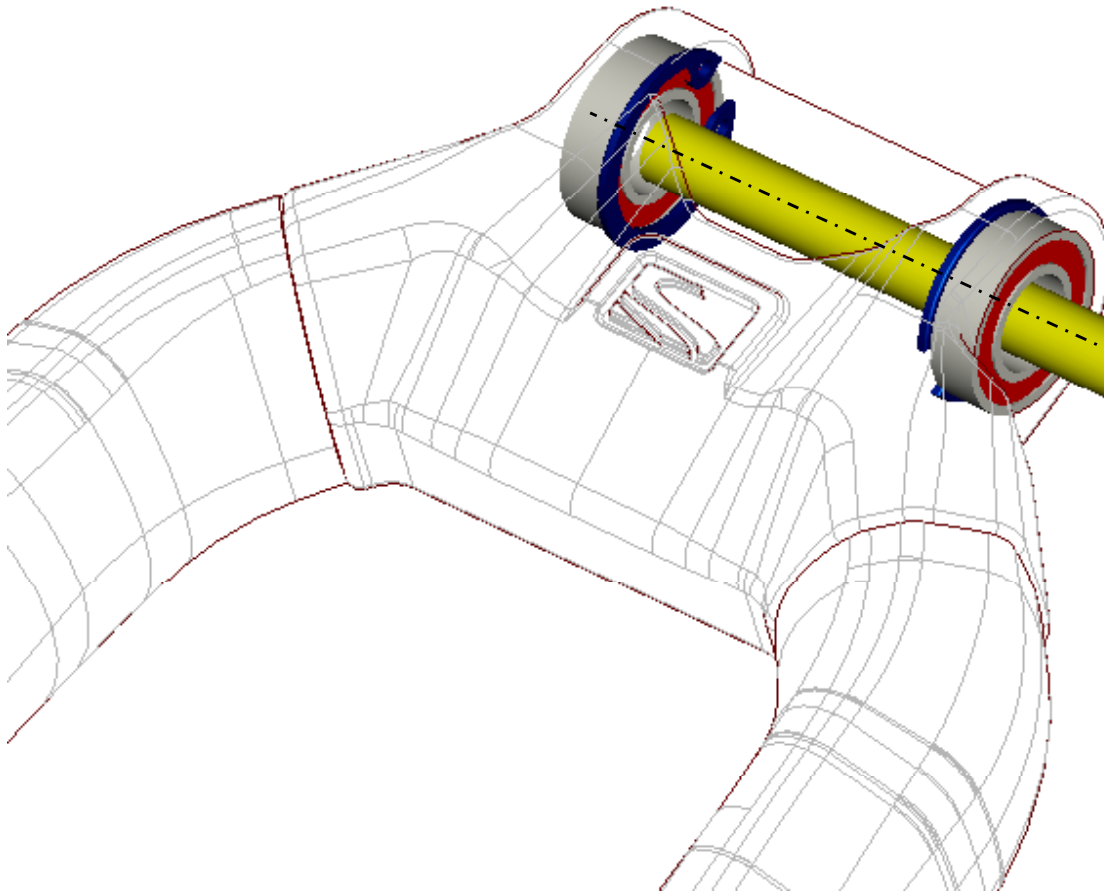

#### 2) TAKE-OFF CIRCLIPS

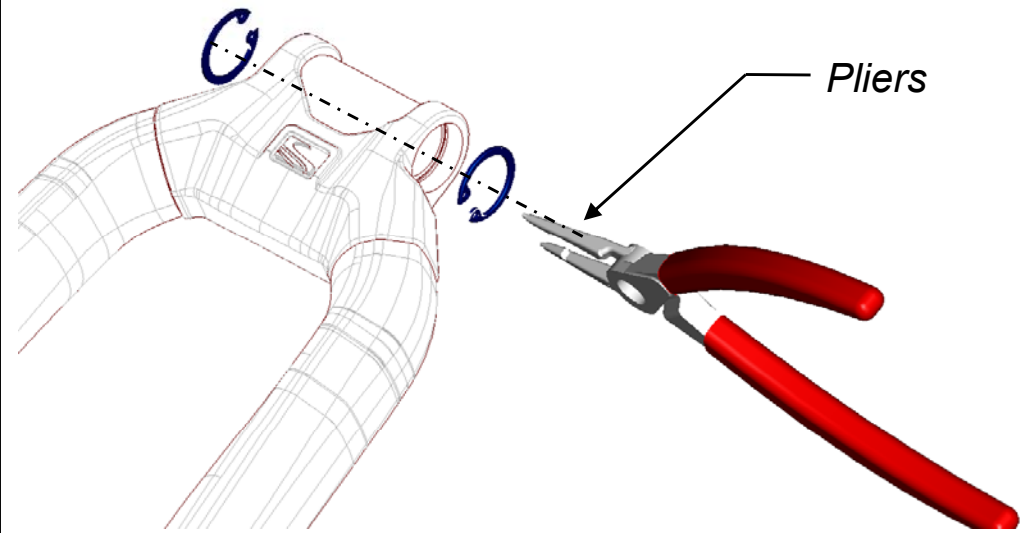

Nylon hammer



### BEARING 3 / MOUNT

#### 1) MOUNT CIRCLIPS

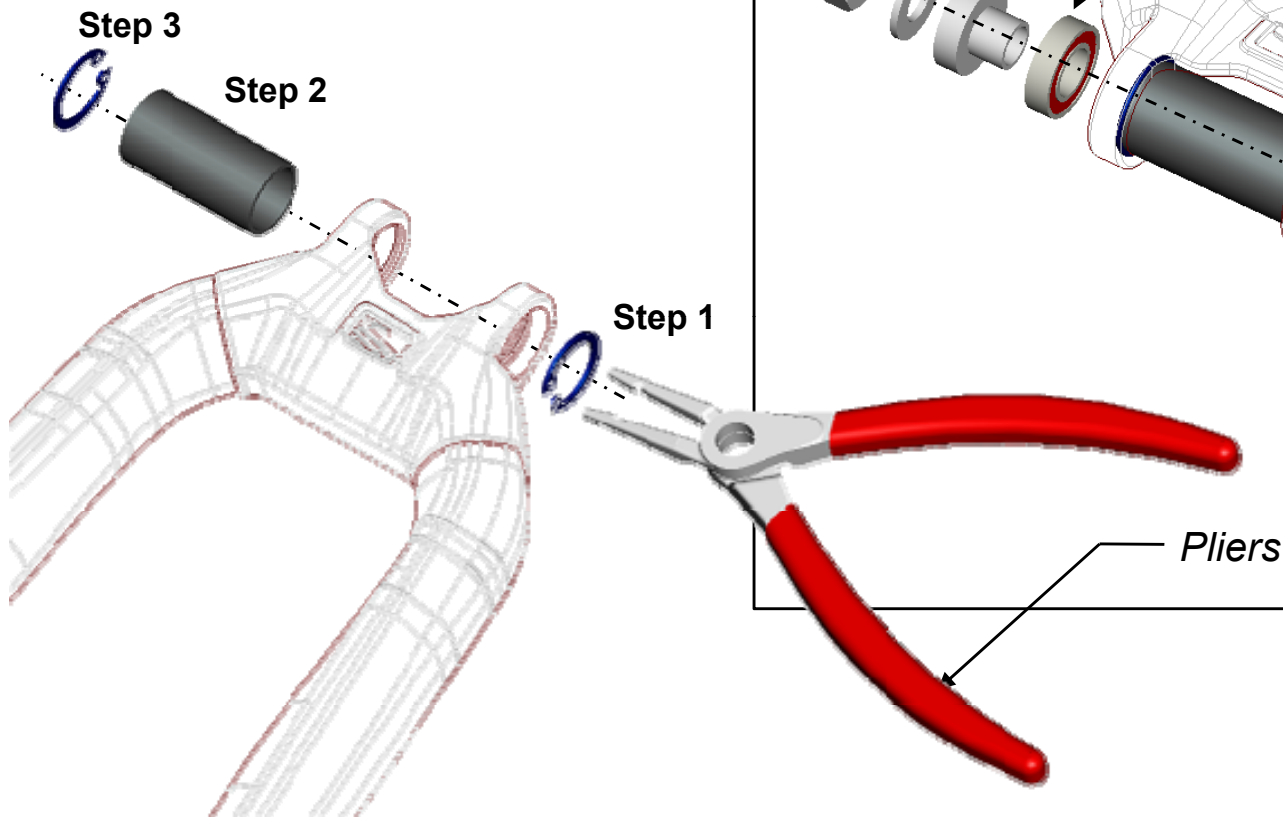

#### 2) MOUNT BEARINGS

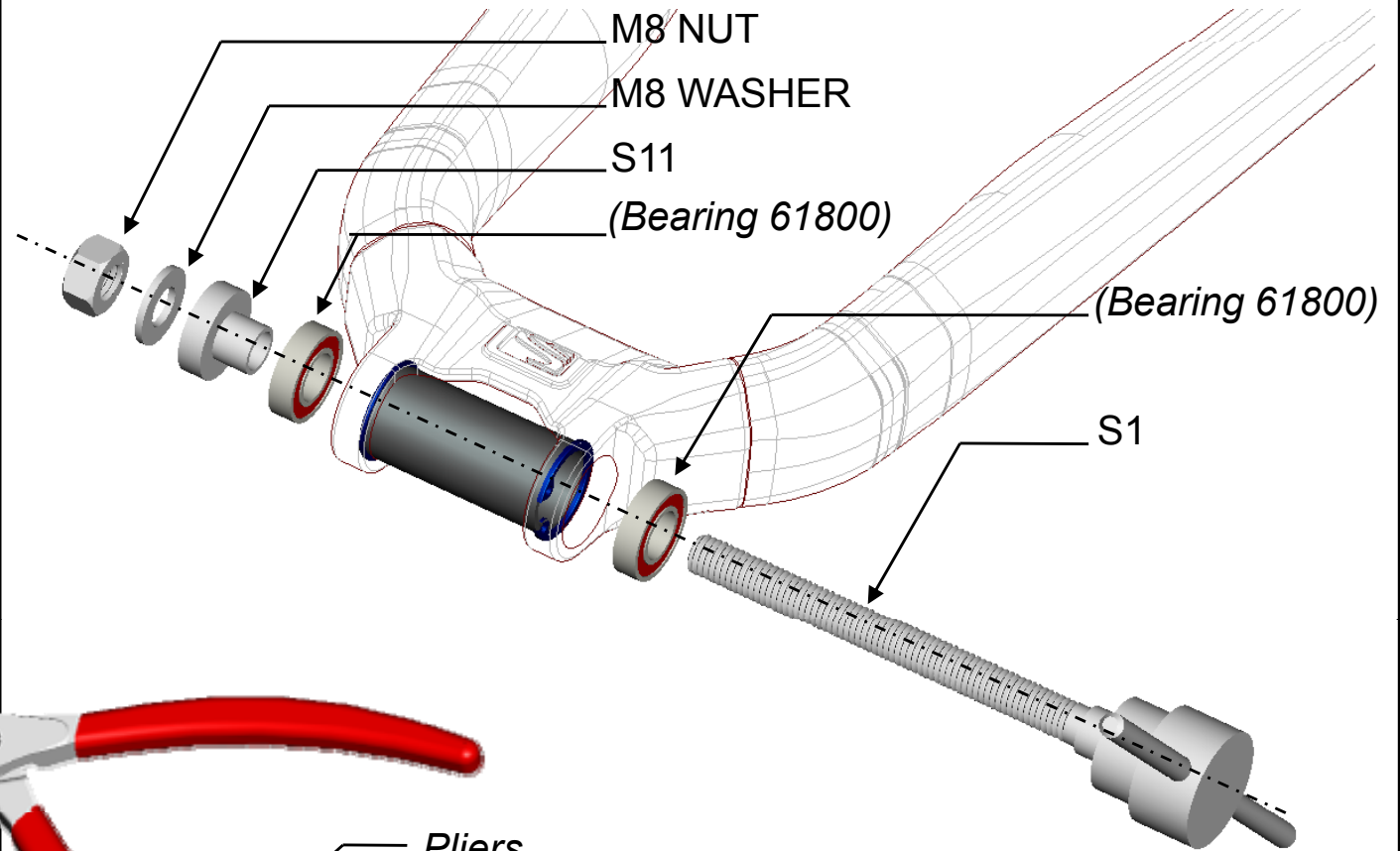



### BEARING 4 / TAKE-OFF

#### 1) TAKE-OFF HARDWARE

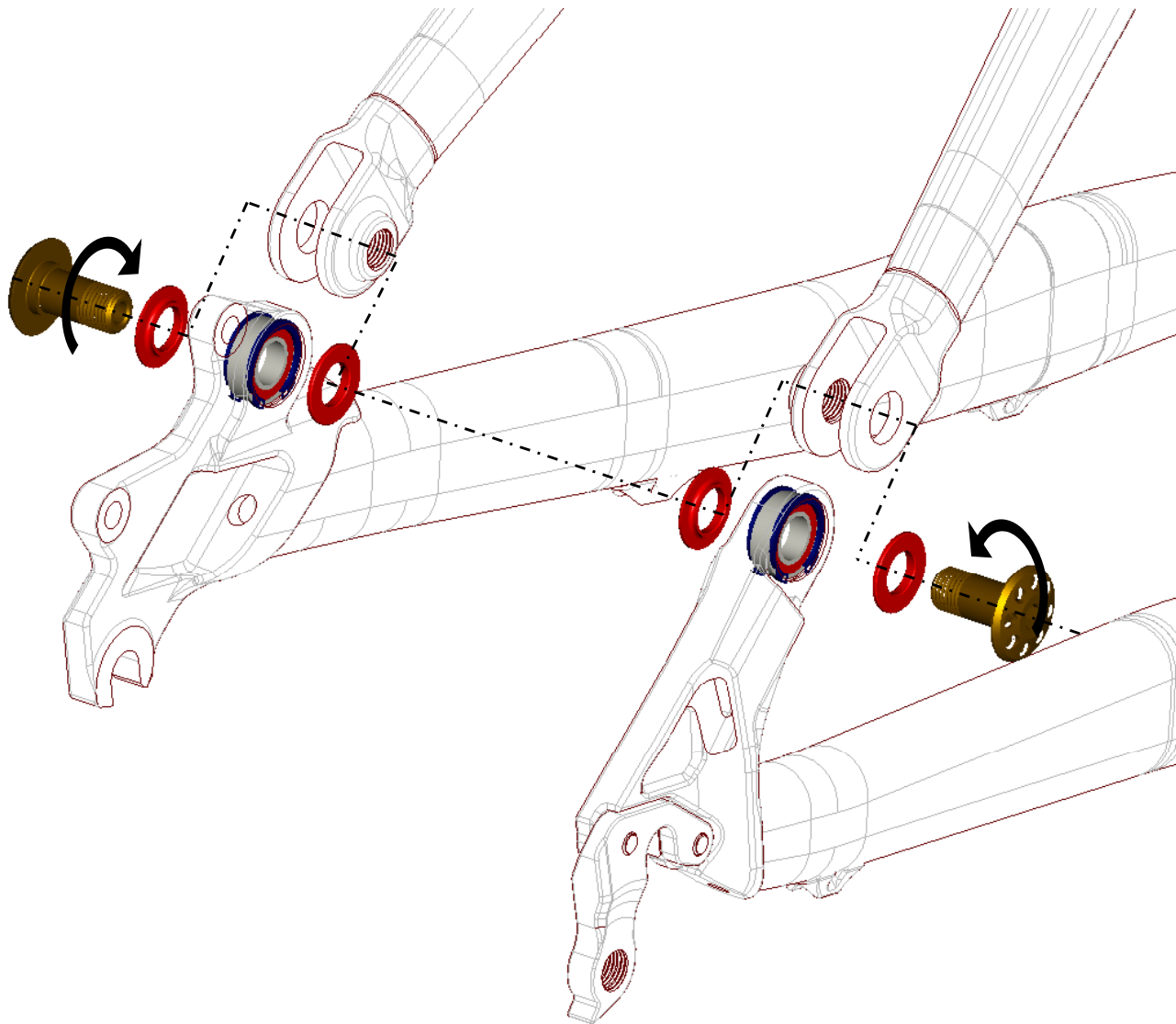

#### 2) TAKE-OFF CIRCLIPS

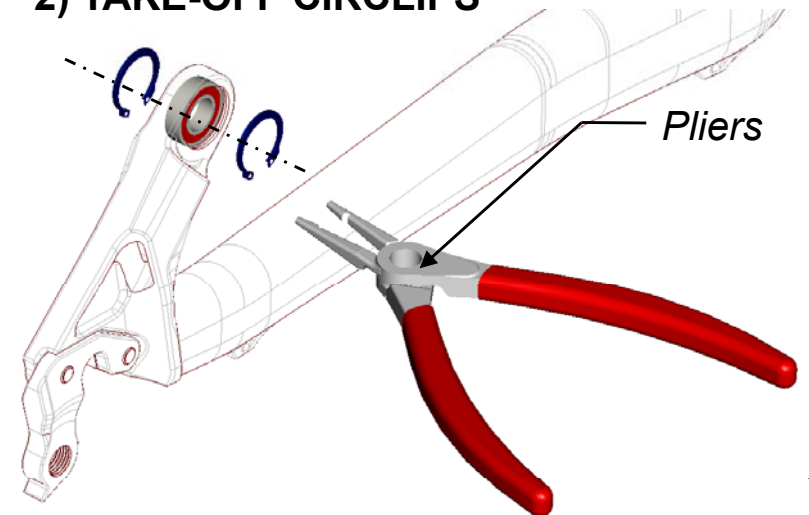

#### 3) TAKE-OFF BEARINGS

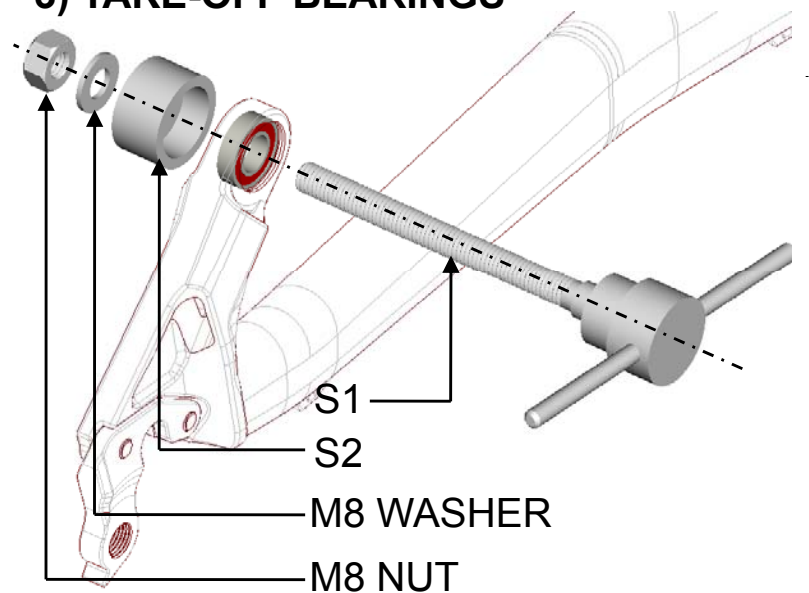





### BEARING 4 / MOUNT

#### 1) MOUNT CIRCLIPS

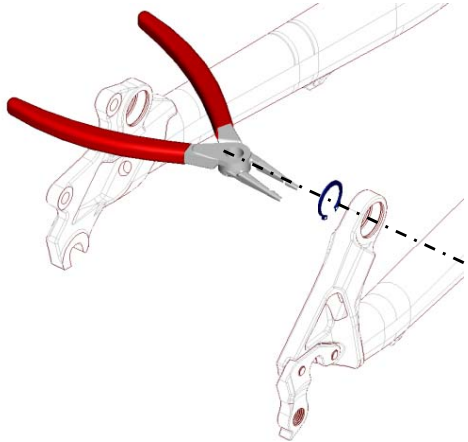

#### 2) MOUNT HARDWARE

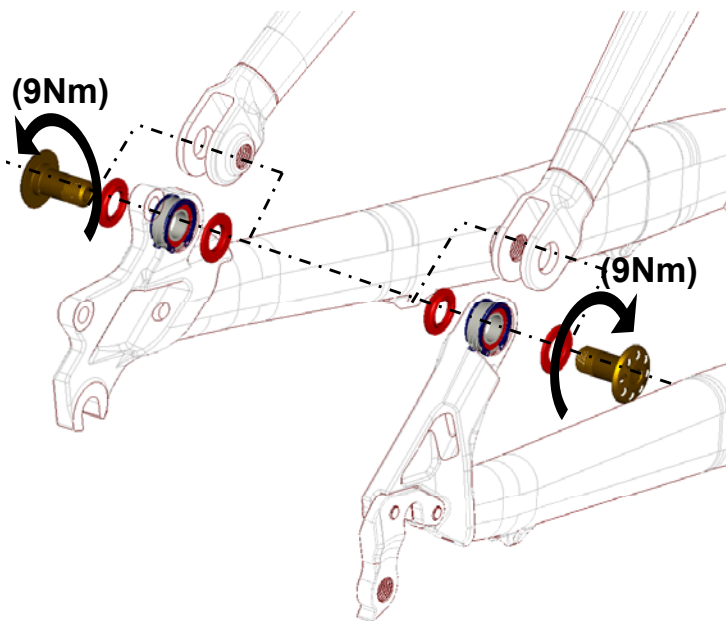

#### 3) MOUNT BEARINGS

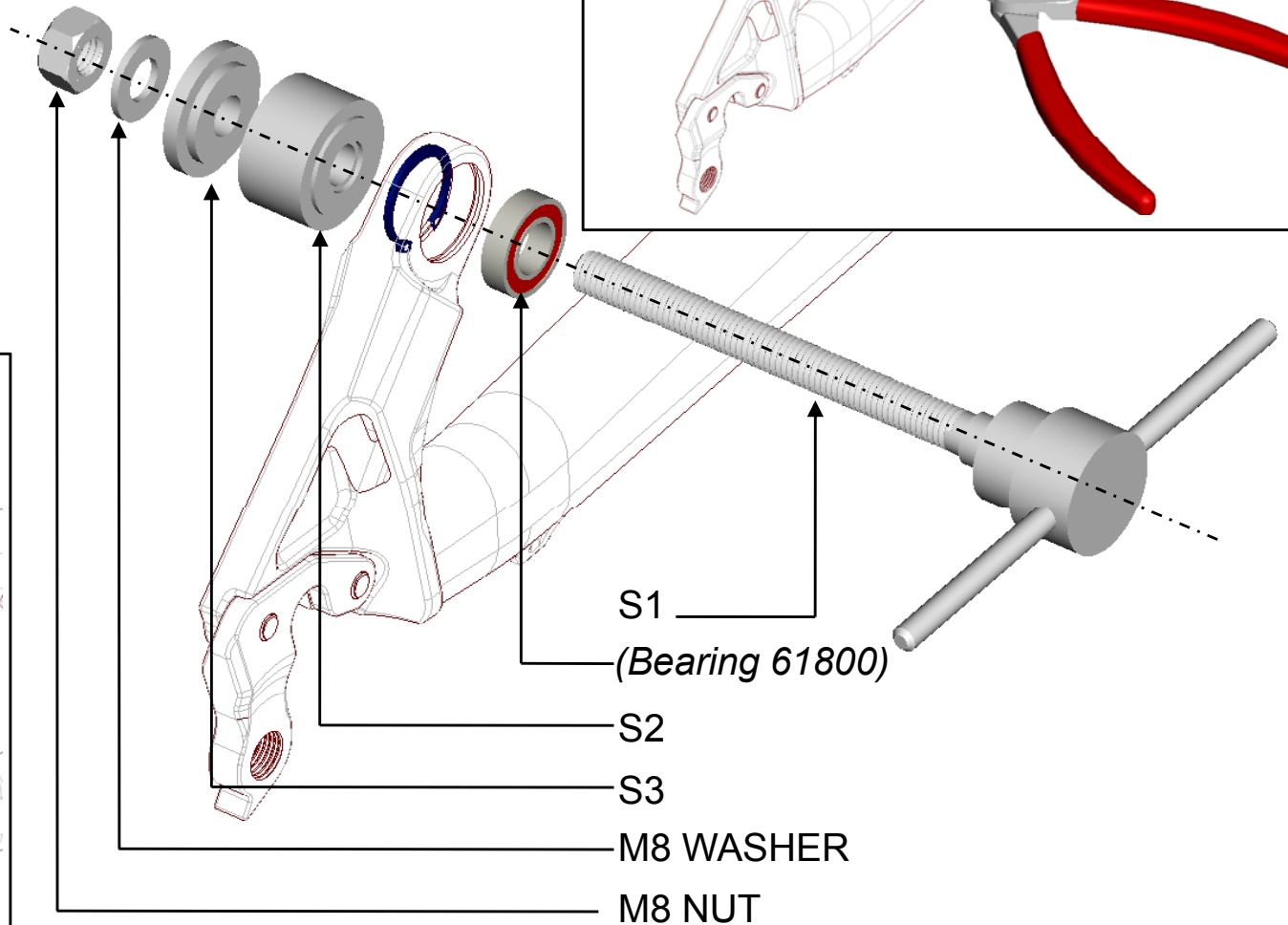

#### 4) MOUNT CIRCLIPS

