

FRAME SCHEMATIC

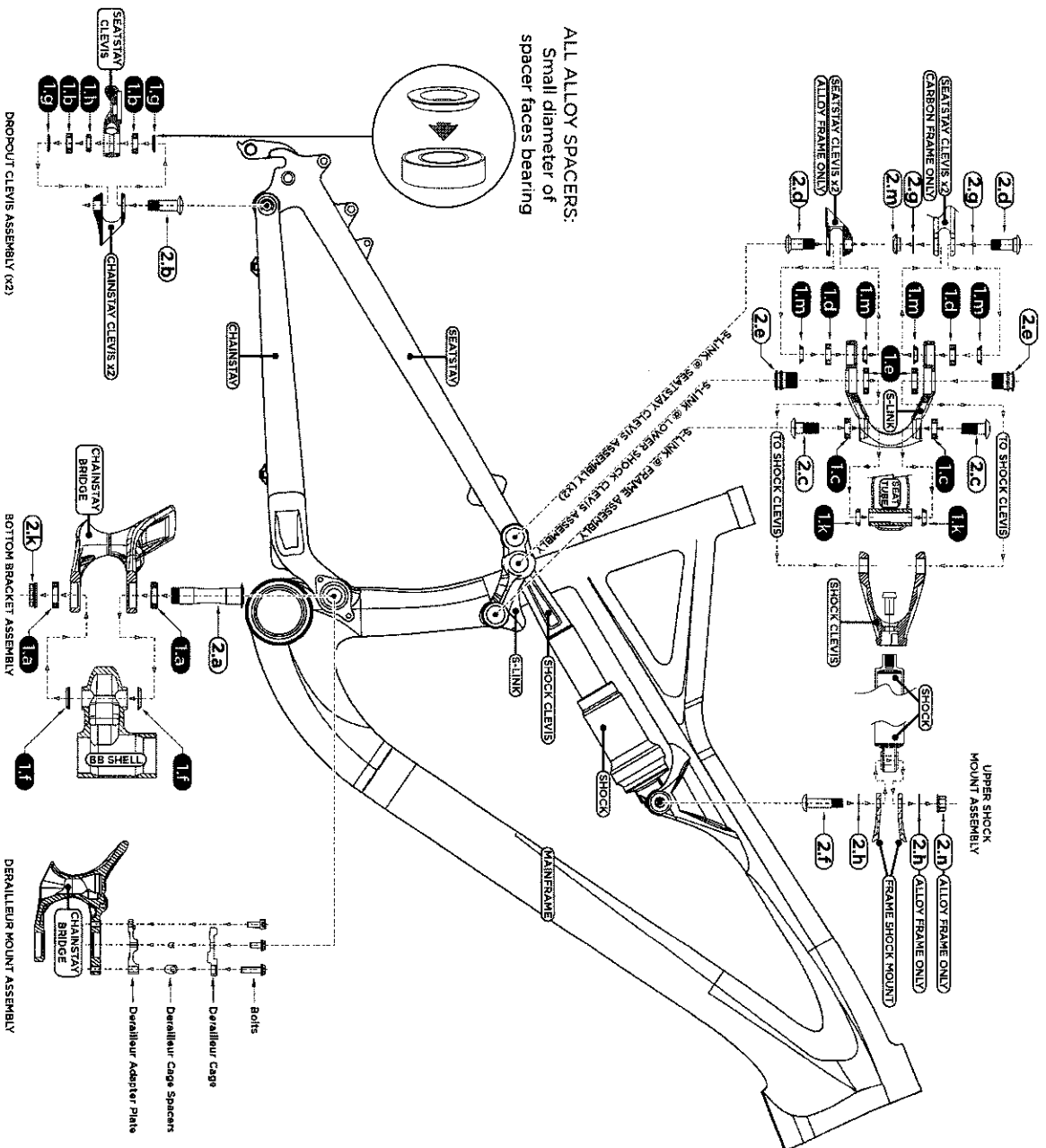

Part#	Qty	Part Description	Part Specification
1.a	2	BB Pivot Bearing	1524F Full Complement Bearing - 24mm O.D. x 15mm I.D. x 5mm Width
1.b	4	Dropout Pivot Bearing	6800-2RS Bearing - 19mm O.D. x 10mm I.D. x 5mm Width
1.c	2	S-Link @ Frame Pivot Bearing	6800-2RS Bearing - 19mm O.D. x 10mm I.D. x 5mm Width
1.d	2	S-Link @ Seatstay Pivot Bearing	6800V-2RS Full Complement Bearing - 19mm O.D. x 10mm I.D. x 5mm Width
1.e	2	S-Link @ Clevis Pivot Bearing	1524F Full Complement Bearing - 24mm O.D. x 15mm I.D. x 5mm Width
1.f	2	BB Pivot Spacer	Alloy Spacer - 20mm O.D. x 15mm I.D. x 3mm Width, Chamfered
1.g	4	Dropout Pivot Outer Spacer	Alloy Spacer - 16mm O.D. x 10mm I.D. x 2mm Width, Chamfered
1.h	2	Dropout Pivot Inner Spacer	Alloy Spacer - 16mm O.D. x 10mm I.D. x 4mm Width
1.k	2	S-Link @ Frame Pivot Spacer	Alloy Spacer - 16mm O.D. x 10mm I.D. x 4mm Width
1.m	4	S-Link @ Seatstay Pivot Spacer	Alloy Spacer - 17.5mm O.D. x 10mm I.D. x 3.5mm Width, Chamfered

B = Blue Loctite required

Part#	Qty	Part Description	Part Specification	Torque in*lb
2.a	1	BB Pivot Axle	Alloy Axle - M15 Thread x 64.5mm Shaft Length, 8mm Allen Hex Head	200-230 B
2.b	2	Dropout Pivot Bolt	Alloy Bolt - M10 Thread x 27mm Shaft Length, 4mm Allen Hex Chamfered Head	120-140 B
2.c	2	S-Link @ Frame Pivot Bolt	Alloy Bolt - M10 Thread x 22mm Shaft Length, 4mm Allen Hex Head	120-140 B
2.d	2	S-Link @ Seatstay Pivot Bolt (Carbon frame)	Alloy Bolt - M10 Thread x 24.5mm (3.8mm Step) Shaft Length, 4mm Allen Hex Head	120-140 B
2.d	2	S-Link @ Clevis Pivot Bolt (Alloy frame)	Alloy Bolt - M10 Thread x 21.5mm Shaft Length, 4mm Allen Hex Chamfered Head	120-140 B
2.e	2	S-Link @ Clevis Bolt	Alloy Bolt - M15 Thread x 14mm Shaft Length, 6mm Allen Hex Head	200-230 B
2.f	1	Upper Shock Eye Bolt (SJ Carbon frame)	Alloy Bolt - M8 Thread x 35mm Shaft Length, 4mm Allen Hex Head	70-90 B
2.f	1	Upper Shock Eye Bolt (SJ Alloy frame)	Alloy Bolt - M8 Thread x 33.5mm Shaft Length, 4mm Allen Hex Head	70-90 B
2.g	1	Upper Shock Eye Bolt (Safire frame)	Steel Bolt - M8 Thread x 41mm Shaft Length, 5mm Allen Hex Head	70-90 B
2.h	4	S-Link @ Seatstay Pivot Washer (Carbon frame)	Steel Washer - 18mm O.D. x 13mm I.D. x 0.5mm Width	
2.h	2	Upper Shock Eye Washer	Steel Washer - 16.5mm O.D. x 8mm I.D. x 0.5mm Width	
2.k	1	BB Pivot Nut	Alloy Nut - M15 Thread x 23.5mm O.D. x 17mm Socket (use 6-point 19mm socket)	
2.m	2	S-Link @ Seatstay Nut (Carbon frame)	Alloy Nut - M10 Thread x 18.5mm O.D. 11mm Socket (use 6-point 11mm socket)	
2.n	1	Upper Shock Eye Nut (Alloy frame)	Alloy Nut - M8 Thread x 16.5mm O.D. x 8mm Width, 12mm Open Wrench	

FRAME PIVOT SPECIFICATIONS

22-26 W
43-16
43-16
22-26
8-10 W